

UNITED STATES  
DEPARTMENT OF THE INTERIOR  
BUREAU OF LAND MANAGEMENT

APPLICATION FOR PERMIT TO DRILL OR REENTER



FORM APPROVED  
OMB No. 1004-0136  
Expires November 30, 2000

1a. Type of Work: <input checked="" type="checkbox"/> DRILL <input type="checkbox"/> REENTER		5. Lease Serial No. <b>UTU-0461</b>
b. Type of Well: <input type="checkbox"/> Oil Well <input checked="" type="checkbox"/> Gas Well <input type="checkbox"/> Other <input type="checkbox"/> Single Zone <input checked="" type="checkbox"/> Multiple Zone		6. If Indian, Allottee or Tribe Name <b>TRIBAL SURFACE</b>
2. Name of Operator <b>KERR MCGEE OIL AND GAS ONSHORE LP</b>		7. If Unit or CA Agreement, Name and No. <b>UNIT #891008900A</b>
3A. Address <b>1368 SOUTH 1200 EAST VERNAL, UT 84078</b>	3b. Phone No. (include area code) <b>(435) 781-7024</b>	8. Lease Name and Well No. <b>NBU 922-18G</b>
4. Location of Well (Report location clearly and in accordance with any State requirements. *) At surface <b>SW/NE 2009'FNL, 1936'FEL 629720X 40.037743</b> At proposed prod. Zone <b>4432844Y -109.479543</b>		9. API Well No. <b>43-047-39371</b>
14. Distance in miles and direction from nearest town or post office* <b>18.55 +/- MILES SOUTHEAST OF OURAY, UTAH</b>		10. Field and Pool, or Exploratory <b>NATURAL BUTTES</b>
15. Distance from proposed* location to nearest property or lease line, ft. (Also to nearest drig. unit line, if any) <b>1936'</b>		11. Sec., T., R., M., or Blk, and Survey or Area <b>SEC. 18, T9S, R22E</b>
16. No. of Acres in lease <b>601.96</b>		12. County or Parish <b>UINTAH</b>
17. Spacing Unit dedicated to this well <b>40.00</b>		13. State <b>UTAH</b>
18. Distance from proposed location* to nearest well, drilling, completed, applied for, on this lease, ft. <b>REFER TO TOPO C</b>		20. BLM/BIA Bond No. on file <b>RLB0005239</b>
21. Elevations (Show whether DF, KDB, RT, GL, etc.) <b>4802'GL</b>		22. Approximate date work will start* <b>UPON APPROVAL</b>
		23. Estimated duration <b>TO BE DETERMINED</b>

24. Attachments

The following, completed in accordance with the requirements of Onshore Oil and Gas Order No. 1, shall be attached to this form:

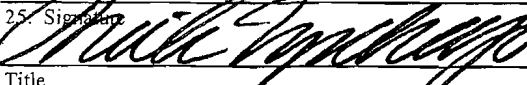
- |                                                                                                                                                |                                                                                                   |
|------------------------------------------------------------------------------------------------------------------------------------------------|---------------------------------------------------------------------------------------------------|
| 1. Well plat certified by a registered surveyor.                                                                                               | 4. Bond to cover the operations unless covered by an existing bond on file (see Item 20 above).   |
| 2. A Drilling Plan.                                                                                                                            | 5. Operator certification.                                                                        |
| 3. A Surface Use Plan (if the location is on National Forest System Lands, the SUPO shall be filed with the appropriate Forest Service Office. | 6. Such other site specific information and/or plans as may be required by the authorized office. |

25. Signature 	Name (Printed/Typed) <b>SHEILA UPCHEGO</b>	Date <b>6/4/2007</b>
Title <b>SENIOR LAND ADMIN SPECIALIST</b>		
Approved by Signature 	Name (Printed/Typed) <b>BRADLEY G. HILL</b>	Date <b>06-19-07</b>
Title <b>OFFICE ENVIRONMENTAL MANAGER</b>		

Application approval does not warrant or certify that the applicant holds legal or equitable title to those rights in the subject lease which would entitle the applicant to conduct operations thereon.

Conditions of approval, if any, are attached.

Title 18 U.S.C. Section 1001 and Title 43 U.S.C. Section 1212, make it a crime for any person knowingly and willfully to make to any department or agency of the United States any false, fictitious or fraudulent statements or representations as to any matter within its jurisdiction.

\*(Instructions on reverse)

Federal Approval of this  
Action is Necessary

RECEIVED  
JUN 11 2007  
DIV. OF OIL, GAS & MINING

T9S, R22E, S.L.B.&M.

# Kerr-McGee Oil & Gas Onshore LP

Well location, NBU #922-18G, located as shown in the SW 1/4 NE 1/4 of Section 18, T9S, R22E, S.L.B.&M., Uintah County, Utah.

## BASIS OF ELEVATION

BENCH MARK (20EAM) LOCATED IN THE SE 1/4 OF SECTION 35, T8S, R21E, S.L.B.&M. TAKEN FROM THE OURAY SE QUADRANGLE, UTAH, UTAH COUNTY, 7.5 MINUTE SERIES (TOPOGRAPHICAL MAP) PUBLISHED BY THE UNITED STATES DEPARTMENT OF THE INTERIOR, GEOLOGICAL SURVEY. SAID ELEVATION IS MARKED AS BEING 4697 FEET.

## BASIS OF BEARINGS

BASIS OF BEARINGS IS A G.P.S. OBSERVATION.

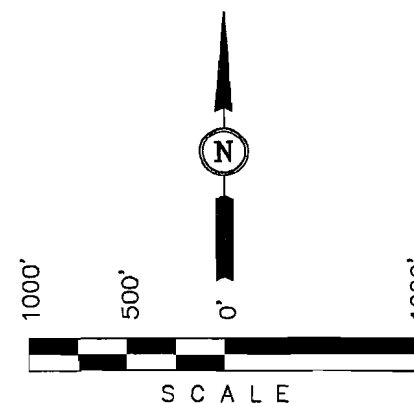

## CERTIFICATE

THIS IS TO CERTIFY THAT THE SURVEY WAS PREPARED FROM FIELD NOTES OF ACTUAL SURVEY MADE BY ME, UNDER MY SUPERVISION AND THAT THE SAME ARE TRUE AND CORRECT TO THE BEST OF MY KNOWLEDGE.

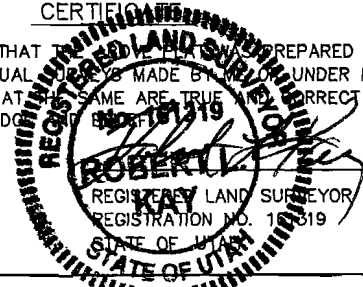

**UINTAH ENGINEERING & LAND SURVEYING**  
85 SOUTH 200 EAST - VERNAL, UTAH 84078  
(435) 789-1017

SCALE 1" = 1000'	DATE SURVEYED: 01-31-07	DATE DRAWN: 02-08-07
PARTY L.K. J.A. C.H.	REFERENCES G.L.O. PLAT	
WEATHER COLD	FILE Kerr-McGee Oil & Gas Onshore LP	

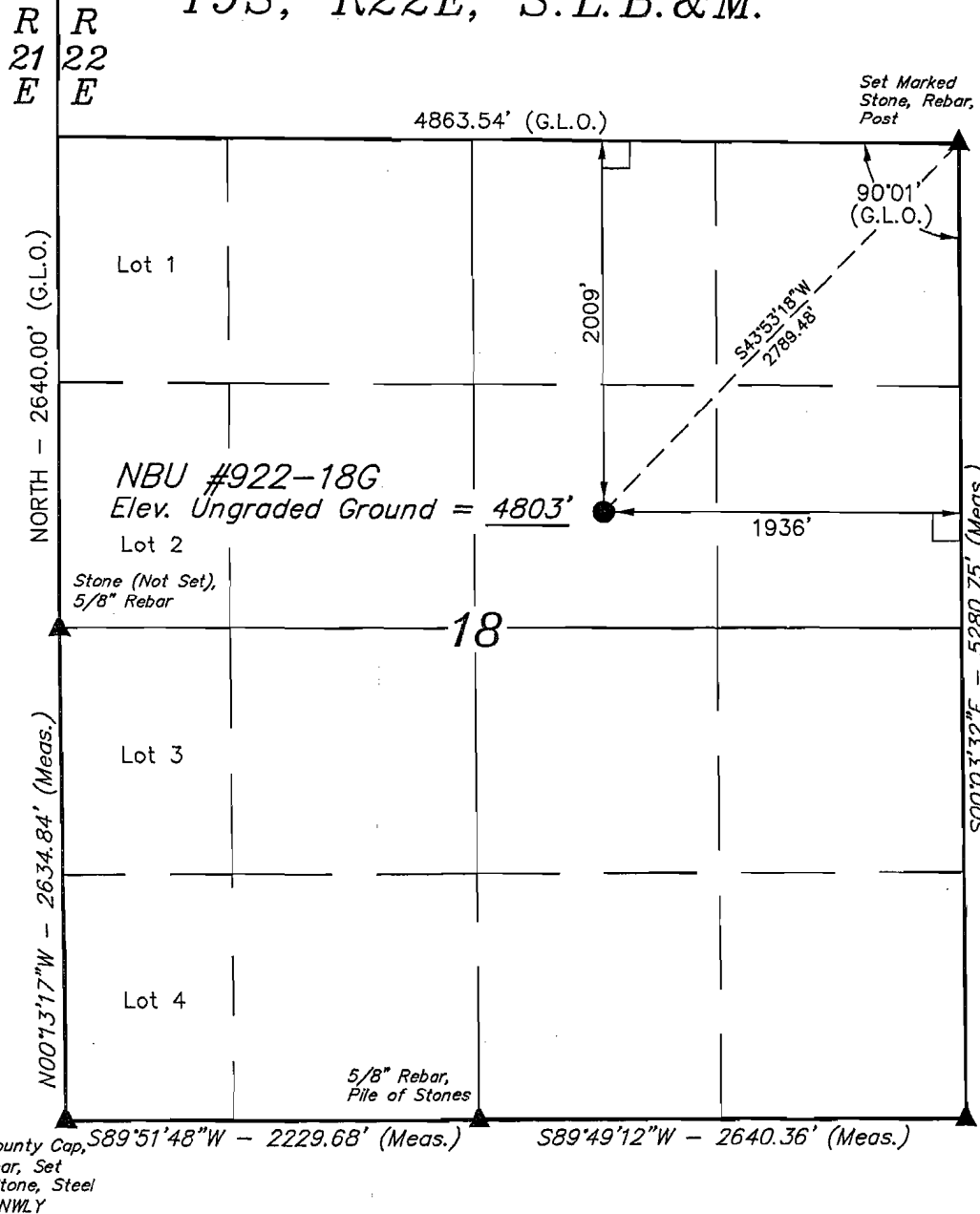

Uintah County Cap, 5/8" Rebar, Set Marked Stone, Steel Post, 3' NWLY

5/8" Rebar, Pile of Stones

Set Marked Stone, Large Pile of Stones

## LEGEND:

- └─┘ = 90° SYMBOL
- = PROPOSED WELL HEAD.
- ▲ = SECTION CORNERS LOCATED.

(NAD 83)  
LATITUDE = 40°02'15.88" (40.037744)  
LONGITUDE = 109°28'48.83" (109.480231)  
(NAD 27)  
LATITUDE = 40°02'16.01" (40.037781)  
LONGITUDE = 109°28'46.36" (109.479544)

NBU 922-18G  
SW/NE Sec. 18, T9S, R22E  
UINTAH COUNTY, UTAH  
UTU-0461

ONSHORE ORDER NO. 1

***DRILLING PROGRAM***

1. **Estimated Tops of Important Geologic Markers:**

<u>Formation</u>	<u>Depth</u>
Uinta	0- Surface
Green River	1720'
Top of Birds Nest Water	1999'
Mahogany	2353'
Wasatch	4962'
Mesaverde	7644'
MVU2	8592'
MVL1	9098'
TD	9730'

2. **Estimated Depths of Anticipated Water, Oil, Gas, or Mineral Formations:**

<u>Substance</u>	<u>Formation</u>	<u>Depth</u>
	Green River	1720'
	Top of Birds Nest Water	1999'
	Mahogany	2353'
Gas	Wasatch	4962'
Gas	Mesaverde	7644'
Gas	MVU2	8592'
Gas	MVL1	9098'
Water	N/A	
Other Minerals	N/A	

3. **Pressure Control Equipment** (Schematic Attached)

*Please see the Natural Buttes Unit Standard Operating Procedure (SOP).*

4. **Proposed Casing & Cementing Program:**

*Please see the Natural Buttes Unit SOP.*

5. **Drilling Fluids Program:**

*Please see the Natural Buttes Unit SOP.*

6. **Evaluation Program:**

*Please see the Natural Buttes Unit SOP.*

7. **Abnormal Conditions:**

Maximum anticipated bottomhole pressure calculated at 9730' TD, approximately equals 6033 psi (calculated at 0.62 psi/foot).

Maximum anticipated surface pressure equals approximately 3892 psi (bottomhole pressure minus the pressure of a partially evacuated hole calculated at 0.22 psi/foot).

8. **Anticipated Starting Dates:**

*Drilling is planned to commence immediately upon approval of this application.*

9. **Variances:**

*Please see Natural Buttes Unit SOP.*

10. **Other Information:**

*Please see Natural Buttes Unit SOP.*



# KERR-McGEE OIL & GAS ONSHORE LP DRILLING PROGRAM

COMPANY NAME KERR-McGEE OIL & GAS ONSHORE LP DATE May 31, 2007  
WELL NAME NBU 922-18G TD 9,730' MD/TVD  
FIELD Natural Buttes COUNTY Uintah STATE Utah ELEVATION 4,802' GL KB 4,817'  
SURFACE LOCATION SW/NE SEC. 18, T9S, R22E 2009'FNL, 1936'FEL BHL Straight Hole  
Latitude: 40.037744 Longitude: 109.480231  
OBJECTIVE ZONE(S) Wasatch/Mesaverde  
ADDITIONAL INFO Regulatory Agencies: TRIBAL (SURF & MINERALS), BLM, UDOGM, Tri-County Health Dept.

GEOLOGICAL			MECHANICAL		
FORMATION			HOLE	CASING	MUD
LOGS	TOPS	DEPTH	SIZE	SIZE	WEIGHT
		40'		14"	
			12-1/4"	9-5/8", 32.3#, H-40, STC	Air mist
			**For wells w/ surf csg set below 2200'		
			app 10 js of 36# J55 will be run on bottom		
Catch water sample, if possible, from 0 to 4,962'					
	Green River @	1,720'			
	Top of Birds Nest Water @	1,999'			
	Mahogany @	2,353'			
	Preset fl GL @				
	2,500' MD				
Note: 12.25" surface hole will usually be drilled ±400' below the bottom of lost circulation zone. Drilled depth may be ±200' of the estimated set depth depending on the actual depth of the loss zone.					
Mud logging program TBD					
Open hole logging program fl TD - surf csg					
	Wasatch @	4,962'	7-7/8"	4-1/2", 11.6#, I-80 or equivalent LTC casing	Water/Fresh Water Mud 8.3-11.5 ppg
	Mverde @	7,644'			
	MVU2 @	8,592'			
	MVL1 @	9,098'			
	TD @	9,730'			Max anticipated Mud required 11.5 ppg

# KERR-McGEE OIL & GAS ONSHORE LP DRILLING PROGRAM

## CASING PROGRAM

	SIZE	INTERVAL	WT.	GR.	CPLG.	DESIGN FACTORS		
						BURST	COLLAPSE	TENSION
CONDUCTOR	14"	0-40'						
SURFACE	9-5/8"	0 to 2100	32.30	H-40	STC	2270 0.62*****	1370 1.39	254000 3.59
	9-5/8"	2100 to 2500	36.00	J-55	STC	3520 1.22*****	2020 1.73	564000 7.98
PRODUCTION	4-1/2"	0 to 9730	11.60	I-80	LTC	7780 2.12	6350 1.09	201000 2.04

- 1) Max Anticipated Surf. Press. (MASP) (Surface Casing) = (Pore Pressure at next csg point - (0.22 psi/ft-partial evac gradient x TVD of next csg point))
- 2) MASP (Prod Casing) = Pore Pressure at TD - (.22 psi/ft-partial evac gradient x TD)
- (Burst Assumptions: TD = 11.5 ppg) .22 psi/ft = gradient for partially evac wellbore
- (Collapse Assumption: Fully Evacuated Casing, Max MW) (Tension Assumptions: Air Weight of Casing\*Buoy.Fact. of water)
- MASP 3678 psi
- \*\*\*\*\* Burst SF is low but csg is stronger than formation at 2500 feet
- \*\*\*\*\* EMW @ 2500 for 2270# is 17.5 ppg or 0.9 psi/ft

## CEMENT PROGRAM

		FT. OF FILL	DESCRIPTION	SACKS	EXCESS	WEIGHT	YIELD
SURFACE Option 1	LEAD	500	Premium cmt + 2% CaCl + .25 pps flocele	215	60%	15.60	1.18
	TOP OUT CMT (1)	250	20 gals sodium silicate + Premium cmt + 2% CaCl + .25 pps flocele	100		15.60	1.18
	TOP OUT CMT (2)	as required	Premium cmt + 2% CaCl	as req.		15.60	1.18
SURFACE Option 2	LEAD	2000	NOTE: If well will circulate water to surface, option 2 will be utilized				
	TAIL	500	Prem cmt + 16% Gel + 10 pps gilsonite + .25 pps Flocele + 3% salt BWOC	230	35%	11.00	3.82
	TOP OUT CMT	as required	Premium cmt + 2% CaCl + .25 pps flocele	180	35%	15.60	1.18
PRODUCTION	LEAD	4,460'	Premium Lite II + 3% KCl + 0.25 pps celloflake + 5 pps gilsonite + 10% gel + 0.5% extender	490	60%	11.00	3.38
	TAIL	5,270'	50/50 Poz/G + 10% salt + 2% gel +.1% R-3	1470	60%	14.30	1.31

\*Substitute caliper hole volume plus 0% excess for LEAD if accurate caliper is obtained

\*Substitute caliper hole volume plus 10% excess for TAIL if accurate caliper is obtained

## FLOAT EQUIPMENT & CENTRALIZERS

SURFACE	Guide shoe, 1 jt, insert float. Centralize first 3 joints with bow spring centralizers. Thread lock guide shoe.
PRODUCTION	Float shoe, 1 jt, float collar. Centralize first 3 joints & every third joint to top of tail cement with bow spring centralizers.

## ADDITIONAL INFORMATION

Test casing head to 750 psi after installing. Test surface casing to 1,500 psi prior to drilling out.

BOPE: 11" 5M with one annular and 2 rams. Test to 5,000 psi (annular to 2,500 psi) prior to drilling out. Record on chart recorder & tour sheet. Function test rams on each trip. Maintain safety valve & inside BOP on rig floor at all times. Kelly to be equipped with upper & lower kelly valves.

Drop Totco surveys every 2000'. Maximum allowable hole angle is 5 degrees.

Most rigs have PVT Systems for mud monitoring. If no PVT is available, visual monitoring will be utilized.

DRILLING ENGINEER:

Brad Laney

DATE:

DRILLING SUPERINTENDENT:

Randy Bayne

DATE:

# 5M BOP STACK and CHOKE MANIFOLD SYSTEM

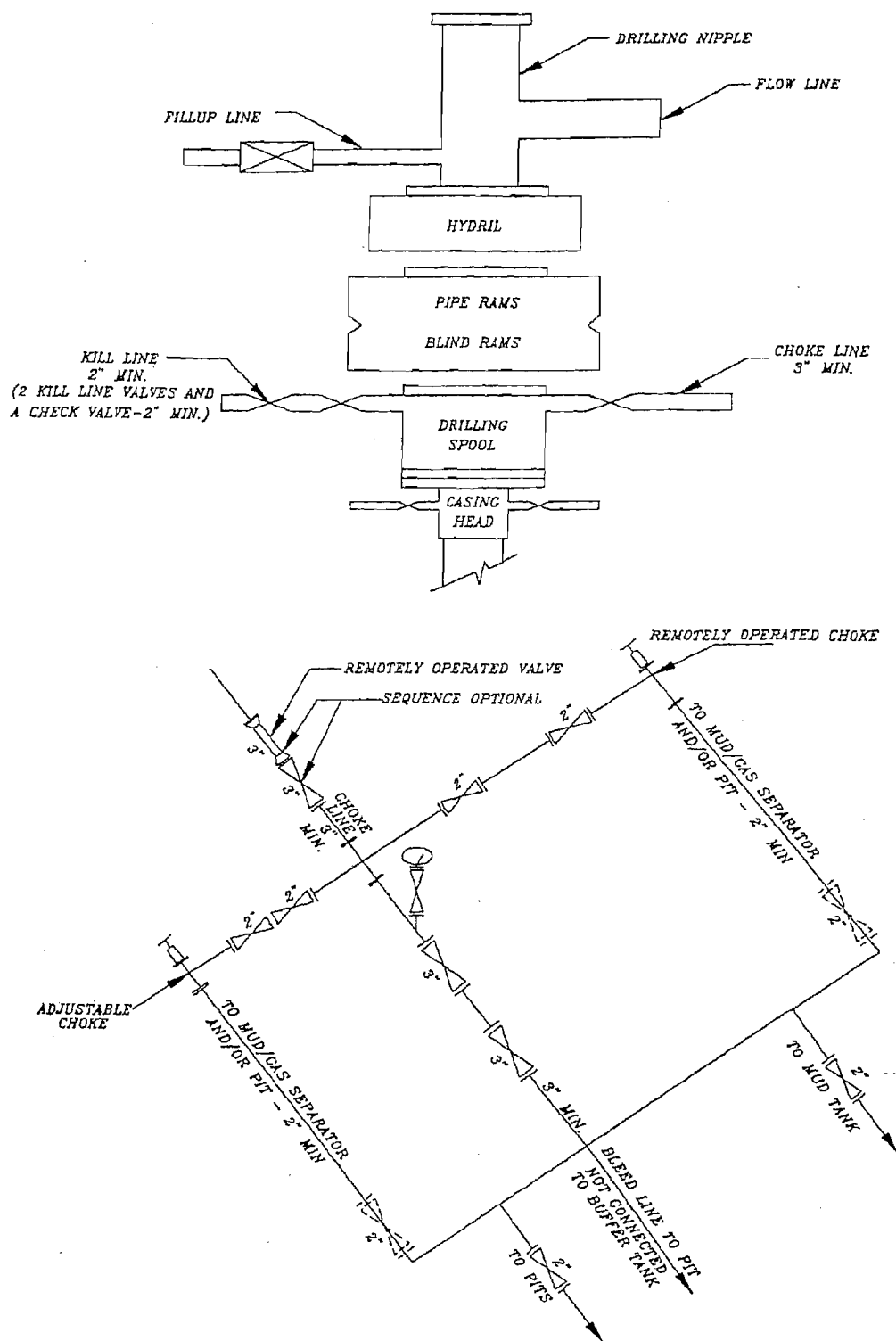

NBU 922-18G  
SW/NE SEC. 18, T9S, R22E  
UINTAH COUNTY, UTAH  
UTU-0461

ONSHORE ORDER NO. 1

***MULTI-POINT SURFACE USE & OPERATIONS PLAN***

**1. Existing Roads:**

Refer to the attached location directions.

Refer to Topo Maps A and B for location of access roads within a 2-mile radius.

**2. Planned Access Roads:**

*Please see the Natural Buttes Unit Standard Operating Procedure (SOP).*

Approximately 0.4 +/- miles of new access road. Please refer to the attached Topo Map B.

**3. Location of Existing Wells Within a 1-Mile Radius:**

Please refer to Topo Map C.

**4. Location of Existing & Proposed Facilities:**

*Please see the Natural Buttes Unit SOP.*

Approximately 2185' +/- of 4" steel pipeline is proposed from the location to an existing pipeline. Refer to the attached Topo Map D.

All facilities will be painted within six months of installation. Facilities required to comply with the Occupational Safety and Health Act (OSHA) will be excluded. The requested color is Carlsbad Canyon Brown (2.5Y 6/2), a non-reflective earthtone.

**5. Location and Type of Water Supply:**

*Please see the Natural Buttes SOP.*

**6. Source of Construction Materials:**

*Please see the Natural Buttes SOP.*

**7. Methods of Handling Waste Materials:**

*Please see the Natural Buttes SOP.*

Any produced water from the proposed well will be contained in a water tank and will then be hauled by truck to one of the pre-approved disposal sites: RNI, Sec. 5, T9S, R22E, NBU #159, Sec. 35, T9S R21E, Ace Oilfield, Sec. 2, T6S, R20E, MC&MC, Sec. 12, T6S, R19E (*Request is in lieu of filing Form 3160-5, after initial production*).



8. **Ancillary Facilities:**

*Please see the Natural Buttes SOP.*

9. **Well Site Layout:** (See Location Layout Diagram)

The attached Location Layout Diagram describes drill pad cross-sections, cuts and fills, and locations of the mud tanks, reserve pit, flare pit, pipe racks, trailer parking, spoil dirt stockpile(s), and surface material stockpile(s).

Please see the attached diagram to describe rig orientation, parking areas, and access roads.

Culverts will be installed where needed.

A run off diversion for drainage will be constructed where needed.

The reserve pit will be lined. When the reserve pit is closed the pit liner will be buried below plow depth.

Location size may change prior to the drilling of the well due to the current rig availability. If the proposed location is not large enough to accommodate the drilling rig. The location will be re-surveyed and a form 3160-5 will be submitted.

10. **Plans for Reclamation of the Surface:**

*Please see the Natural Buttes SOP.*

11. **Surface Ownership:**

The well pad and access road are located on lands owned by:

Ute Indian Tribe  
P.O. Box 70  
Fort Duchesne, Utah 84026  
(435) 722-5141

12. **Other Information:**

A Class III Archaeological Survey Report has been conducted for this location and submitted to the Ute Indian Tribe prior to the on-site inspection.

This location is not within 460' from the boundary of the Natural Buttes Unit, nor is it within 460' of any non-committed tract lying within boundaries of the unit.

13. Lessee's or Operator's Representative & Certification:

Sheila Uphego  
Senior Land Admin Specialist  
Kerr-McGee Oil & Gas Onshore LP  
1368 South 1200 East  
Vernal, UT 84078  
(435) 781-7024

Randy Bayne  
Drilling Manager  
Kerr-McGee Oil & Gas Onshore LP  
1368 South 1200 East  
Vernal, UT 84078  
(435) 781-7018

Certification: All lease and/or unit operations will be conducted in such a manner that full compliance is made with all applicable laws, regulations, Onshore Oil and Gas Orders, the approved Plan of Operations, and any applicable Notice to Lessees.

Kerr-McGee Oil & Gas Onshore LP is considered to be the operator of the subject well. Kerr-McGee Oil & Gas Onshore LP agrees to be responsible under the terms and conditions of the lease for the operations conducted upon leased lands.

The Operator will be fully responsible for the actions of its subcontractors. A complete copy of the approved "Application for Permit to Drill" will be furnished to the field representative(s) to ensure compliance and shall be on location during all construction and drilling operations.

Bond coverage pursuant to 43 CFR 3104 for lease activities is being provided by Bureau of Indian Affairs Nationwide Bond #RLB0005239, Bureau of Land Management Nationwide Bond #WYB000291 and State of Utah Bond #RLB0005237.

I hereby certify that I, or persons under my supervision, have inspected the proposed drill site and access route, that I am familiar with the conditions that currently exist; that the statements made in this plan are, to the best of my knowledge, true and correct; and the work associated with the operations proposed herein will be performed by the Operator, its contractors, and subcontractors in conformity with this plan and the terms and conditions under which it is approved.



Sheila Uphego

6/4/2007

Date

Kerr-McGee Oil & Gas Onshore LP  
NBU #922-18G  
SECTION 18, T9S, R22E, S.L.B.&M.

PROCEED IN A WESTERLY DIRECTION FROM VERNAL, UTAH ALONG U.S. HIGHWAY 40 APPROXIMATELY 14.0 MILES TO THE JUNCTION OF STATE HIGHWAY 88; EXIT LEFT AND PROCEED IN A SOUTHERLY DIRECTION APPROXIMATELY 17.0 MILES TO OURAY, UTAH; PROCEED IN A SOUTHERLY DIRECTION APPROXIMATELY 6.9 MILES TO THE JUNCTION OF THIS ROAD AND AN EXISTING ROAD TO THE SOUTHEAST; TURN LEFT AND PROCEED IN A SOUTHEASTERLY, THEN EASTERLY DIRECTION APPROXIMATELY 5.0 MILES TO THE JUNCTION OF THIS ROAD AND AN EXISTING ROAD TO THE NORTHWEST; TURN LEFT AND PROCEED IN A NORTHWESTERLY DIRECTION APPROXIMATELY 0.3 MILES TO THE JUNCTION OF THIS ROAD AND AN EXISTING ROAD TO THE NORTHEAST; TURN RIGHT AND PROCEED IN A NORTHEASTERLY DIRECTION APPROXIMATELY 3.9 MILES TO THE JUNCTION OF THIS ROAD AND AN EXISTING ROAD TO THE NORTHEAST; PROCEED IN A NORTHEASTERLY DIRECTION APPROXIMATELY 1.6 MILES TO THE JUNCTION OF THIS ROAD AND AN EXISTING ROAD TO THE NORTHWEST; TURN LEFT AND PROCEED IN A NORTHWESTERLY DIRECTION APPROXIMATELY 0.35 MILES TO THE JUNCTION OF THIS ROAD AND AN EXISTING ROAD TO THE NORTHEAST; TURN RIGHT AND PROCEED IN A NORTHEASTERLY DIRECTION APPROXIMATELY 0.1 MILES TO THE EXISTING #922-18K WELL AND THE BEGINNING OF THE PROPOSED ACCESS TO THE NORTHEAST; FOLLOW ROAD FLAGS IN A NORTHEASTERLY DIRECTION APPROXIMATELY 0.4 MILES TO THE PROPOSED LOCATION.

TOTAL DISTANCE FROM VERNAL, UTAH TO THE PROPOSED WELL LOCATION IS APPROXIMATELY 49.55 MILES.

# Kerr-McGee Oil & Gas Onshore LP

NBU #922-18G  
LOCATED IN UTAH COUNTY, UTAH  
SECTION 18, T9S, R22E, S.1.B.&M.

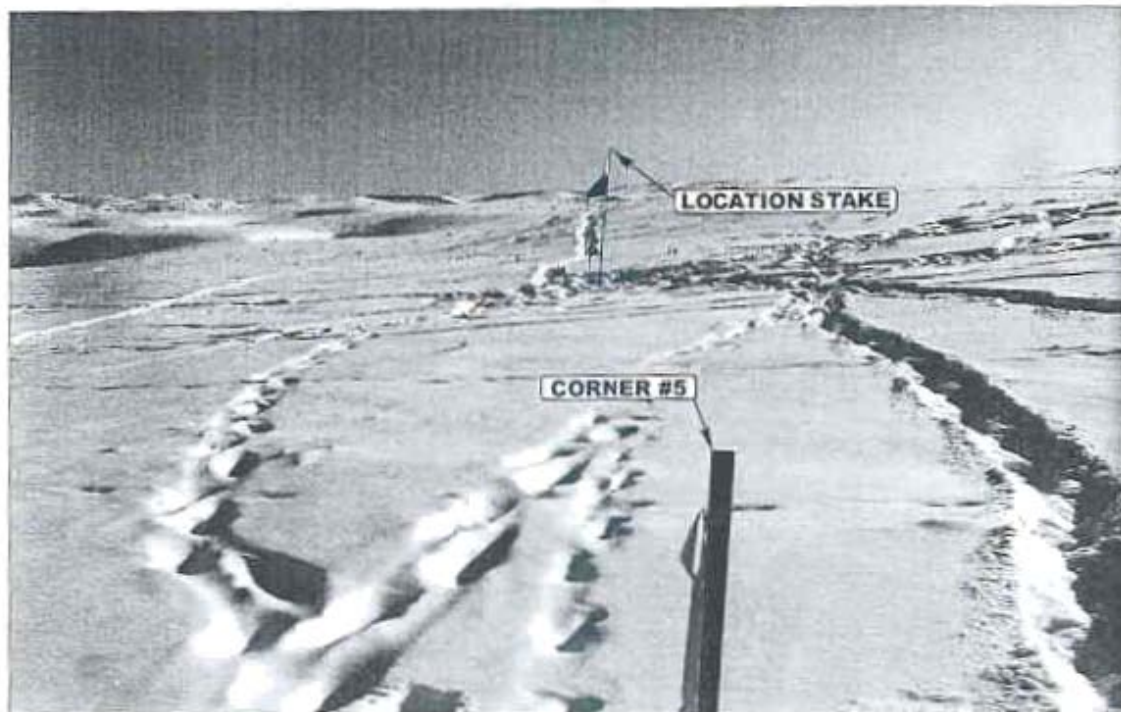

PHOTO: VIEW FROM CORNER #5 TO LOCATION STAKE

CAMERA ANGLE: SOUTHEASTERLY



PHOTO: VIEW FROM BEGINNING OF PROPOSED ACCESS

CAMERA ANGLE: NORTHEASTERLY



**E&LS** Utah Engineering & Land Surveying  
85 South 200 East Vernal, Utah 84078  
435-789-1017 uels@uelsinc.com

LOCATION PHOTOS

02 05 07  
MONTH DAY YEAR

PHOTO

TAKEN BY: L.K. DRAWN BY: L.K. REVISED: 00-00-00



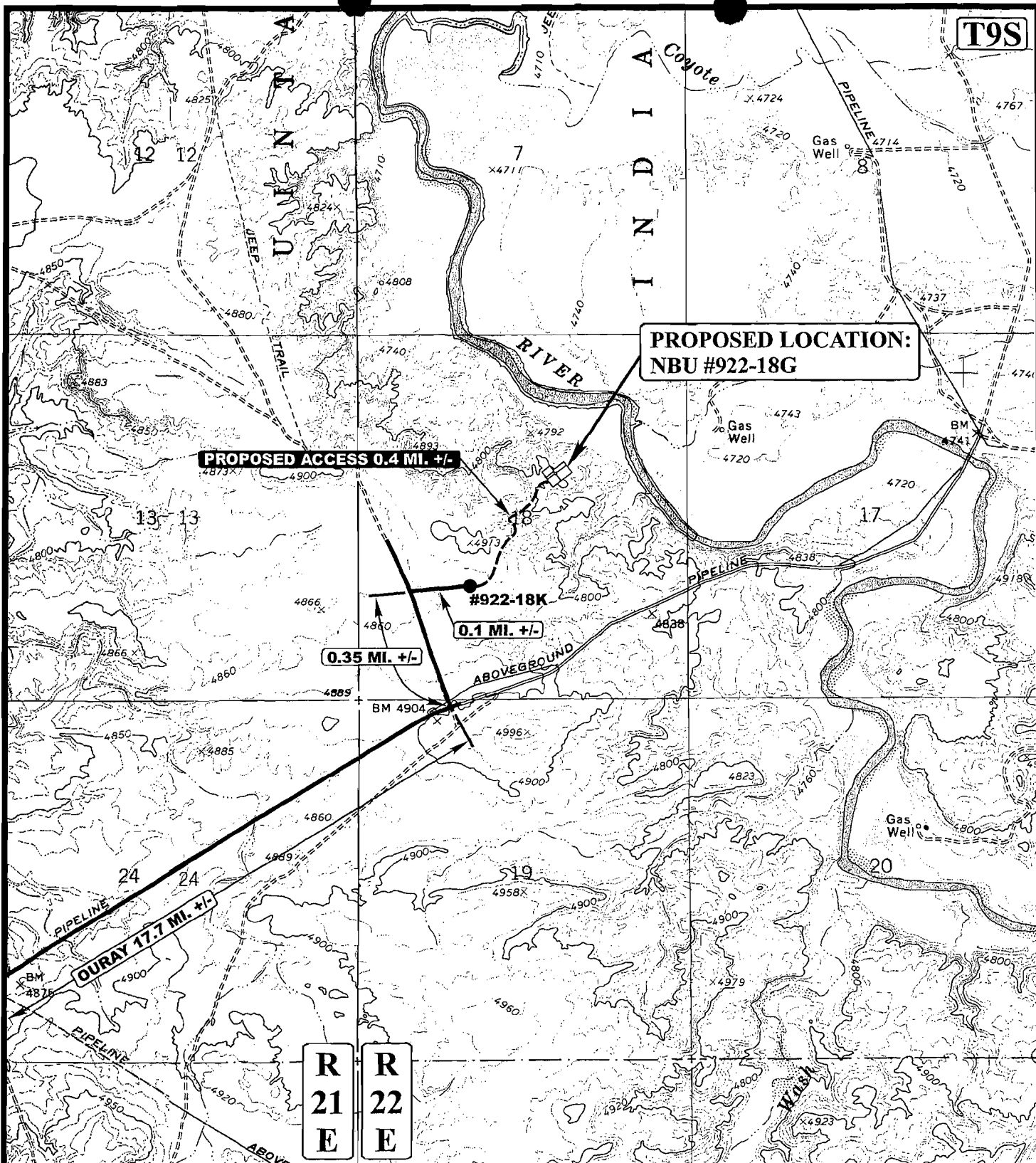

# LEGEND:

————— EXISTING ROAD  
 - - - - - PROPOSED ACCESS ROAD



Kerr-McGee Oil & Gas Onshore LP

NBU #922-18G

SECTION 18, T9S, R22E, S.L.B.&M.  
2009' FNL 1936' FEL



Uintah Engineering & Land Surveying  
 85 South 200 East Vernal, Utah 84078  
 (435) 789-1017 \* FAX (435) 789-1813

TOPOGRAPHIC  
 MAP

02 05 07  
 MONTH DAY YEAR

SCALE: 1" = 2000' DRAWN BY: L.K. REVISED: 00-00-00





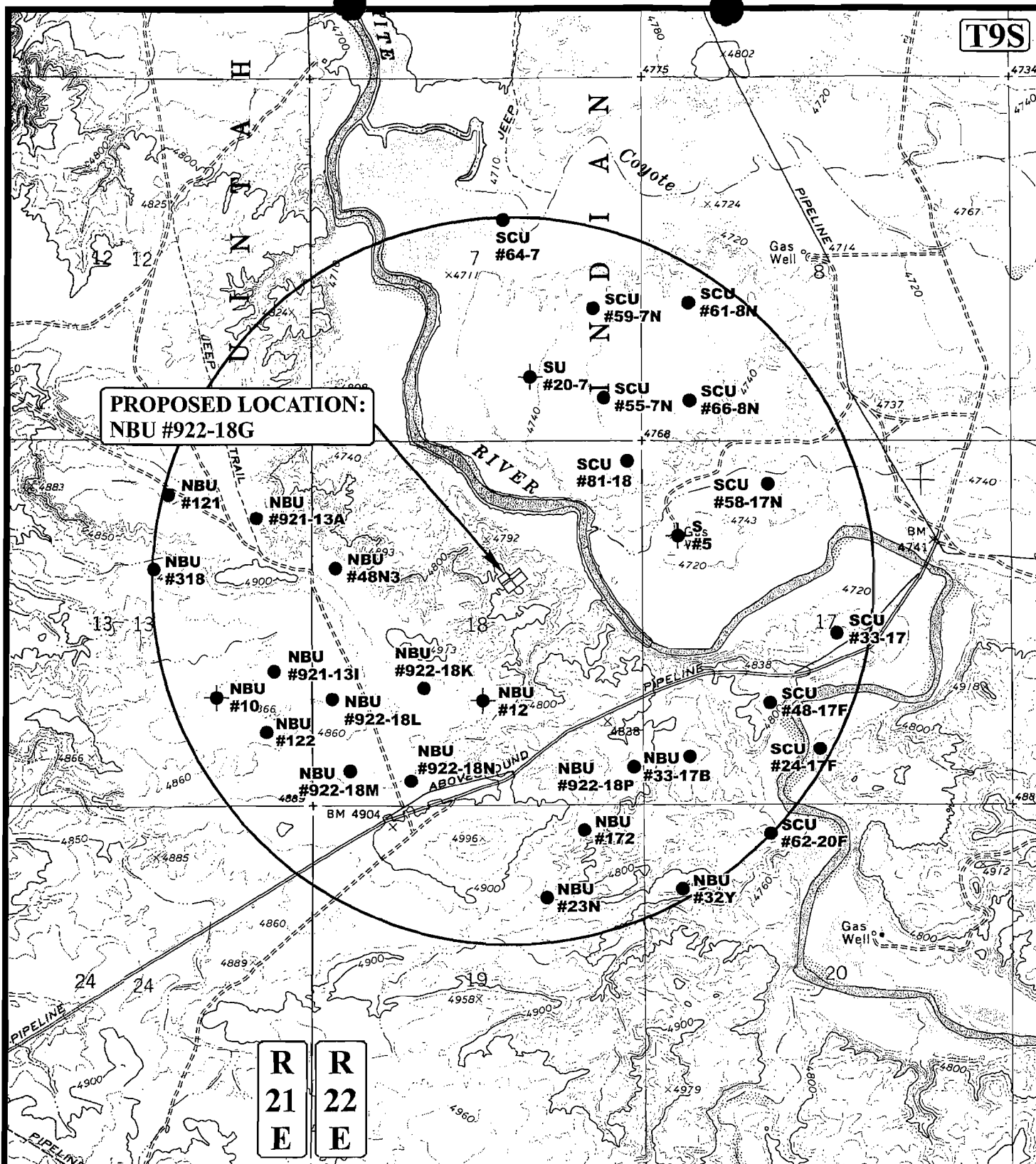

**LEGEND:**

**Kerr-McGee Oil & Gas Onshore LP**

**Uintah Engineering & Land Surveying**  
**85 South 200 East Vernal, Utah 84078**  
**(435) 789-1017 \* FAX (435) 789-1813**

TOPOGRAPHIC  
MAP

02	05	07
MONTH	DAY	YEAR

SCALE: 1" = 2000'	DRAWN BY: L.K.	REVISED: 00-00-00
-------------------	----------------	-------------------

**C**  
**TOPO**





# Kerr-McGee Oil & Gas Onshore LP

NBU #922-18G  
PIPELINE ALIGNMENT  
LOCATED IN UTAH COUNTY, UTAH  
SECTION 18, T9S, R22E, S.L.B.&M.

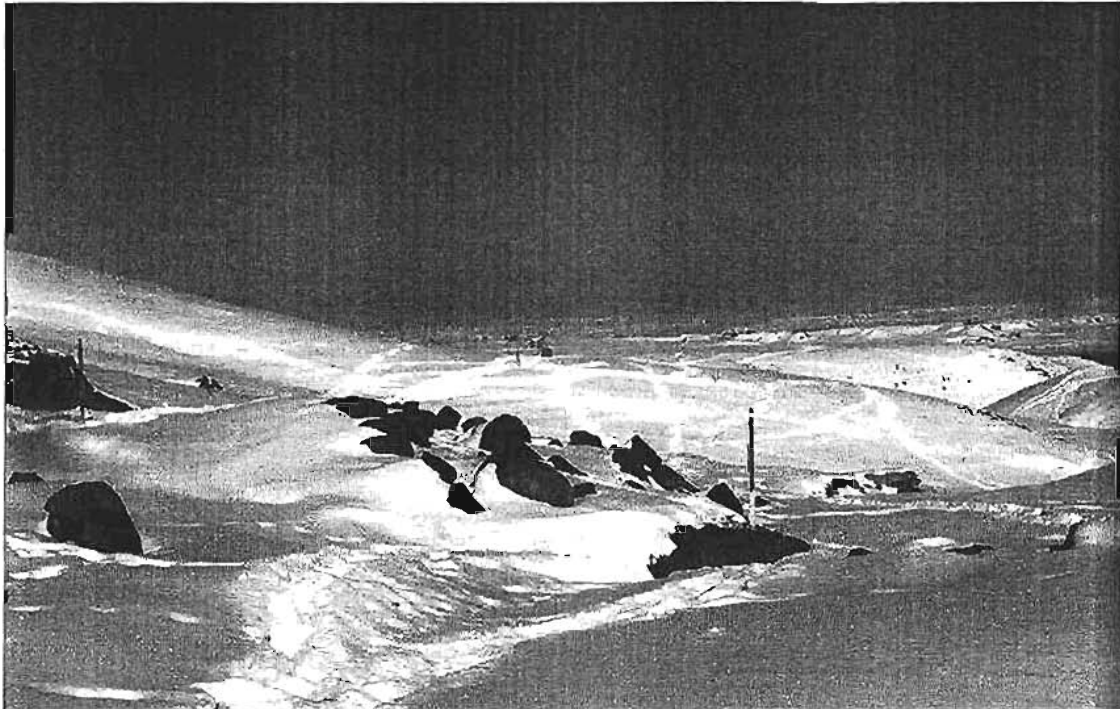

PHOTO: VIEW ALONG PIPELINE ALIGNMENT

CAMERA ANGLE: NORTHEASTERLY

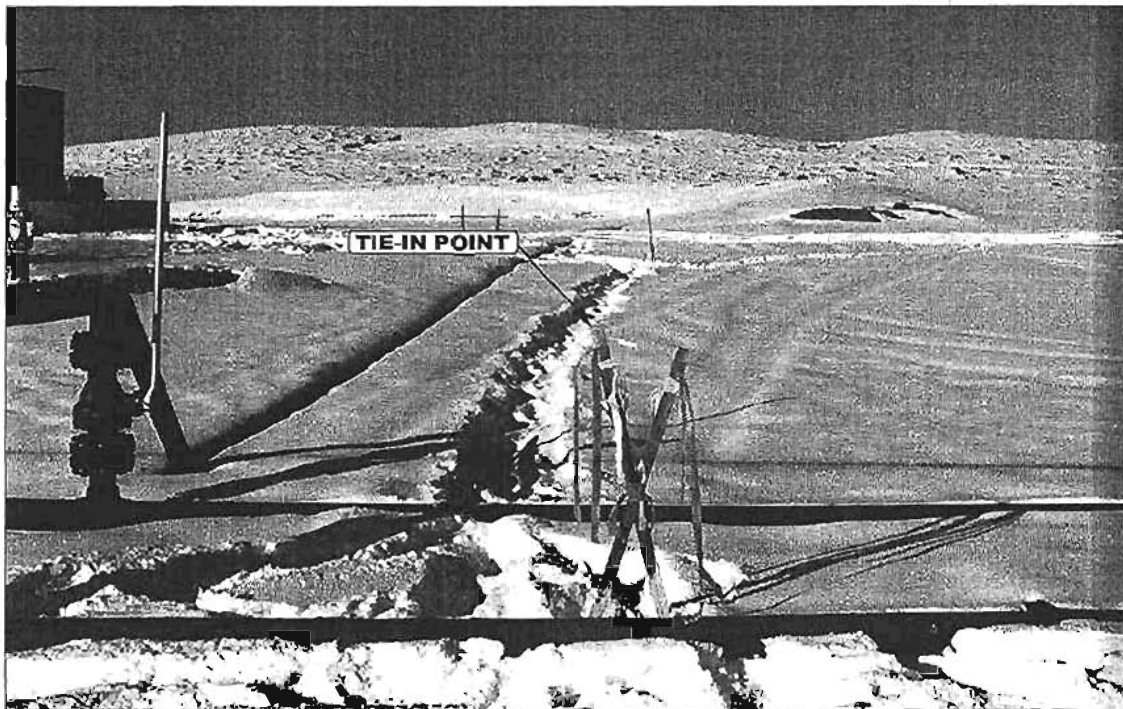

PHOTO: VIEW FROM TIE-IN POINT

CAMERA ANGLE: NORTHEASTERLY



U  
E  
L  
S  
Uintah Engineering & Land Surveying  
85 South 200 East Vernal, Utah 84078  
435-789-1017 uels@uelsinc.com

PIPELINE PHOTOS		02	05	07	PHOTO
		MONTH	DAY	YEAR	
TAKEN BY: L.K.	DRAWN BY: L.K.	REVISED: 00-00-00			

# Kerr-McGee Oil & Gas Onshore LP

## LOCATION LAYOUT FOR

NBU #922-18G

SECTION 18, T9S, R22E, S.L.B.&M.

2009' FNL 1936' FEL

Approx.  
Toe of  
Fill Slope

F-3.0'  
El. 799.2'

Sta. 3+50

Topsoil Stockpile

F-4.4'  
El. 797.8'

F-2.7'  
El. 799.5'

SCALE: 1" = 50'  
DATE: 02-08-07  
Drawn By: C.H.

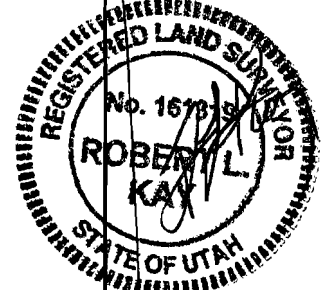

### NOTE:

Flare Pit is to be located  
a min. of 100' from the  
Well Head.

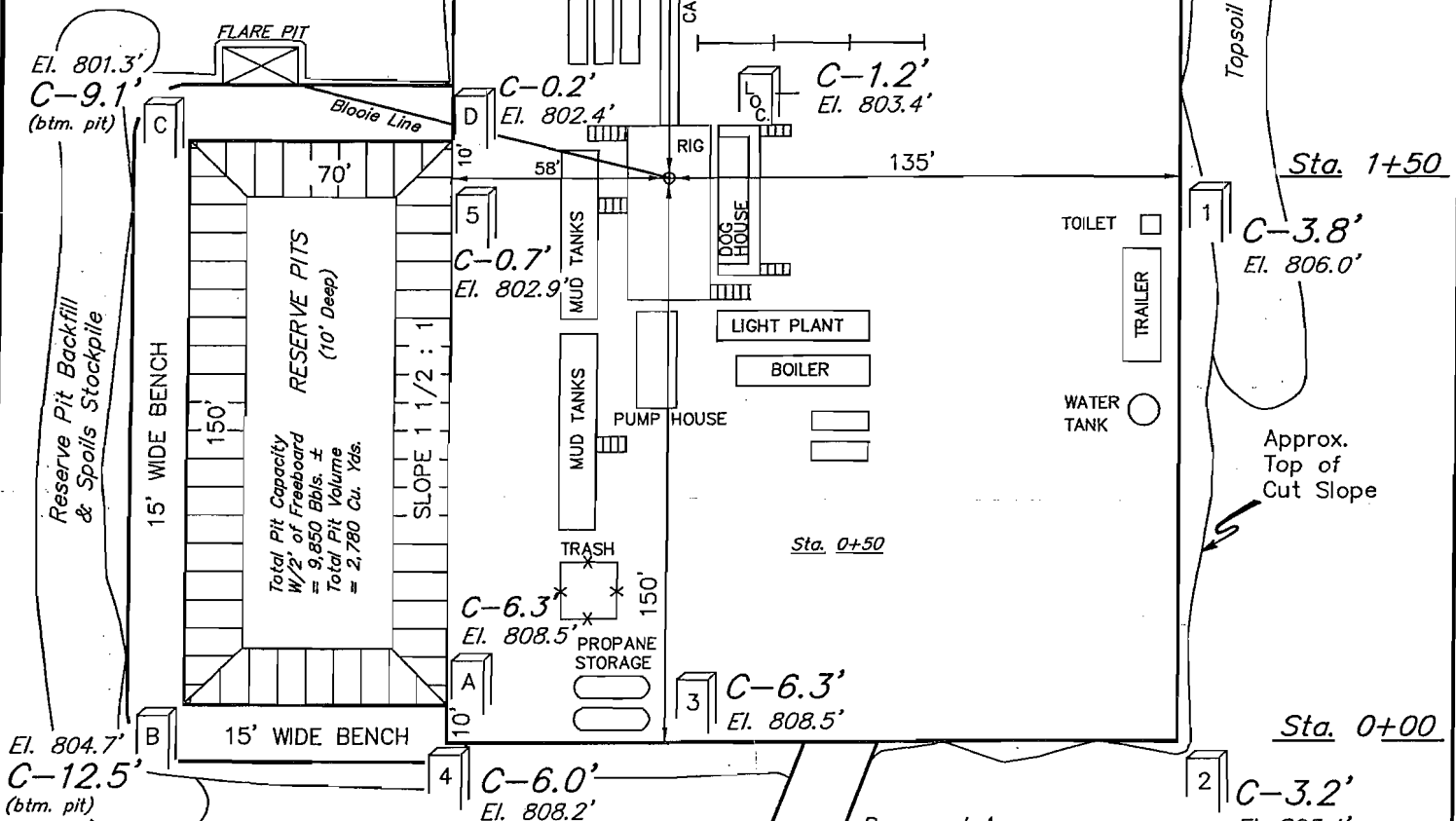

### NOTES:

Elev. Ungraded Ground At Loc. Stake = 4803.4'  
FINISHED GRADE ELEV. AT LOC. STAKE = 4802.2'

FIGURE #1

UINTAH ENGINEERING & LAND SURVEYING  
85 So. 200 East \* Vernal, Utah 84078 \* (435) 789-1017

# Kerr-McGee Oil & Gas Onshore LP

FIGURE #2

## TYPICAL CROSS SECTIONS FOR

NBU #922-18G

SECTION 18, T9S, R22E, S.L.B.&M.

2009' FNL 1936' FEL

1" = 20'  
X-Section  
Scale  
1" = 50'  
DATE: 02-08-07  
Drawn By: C.H.

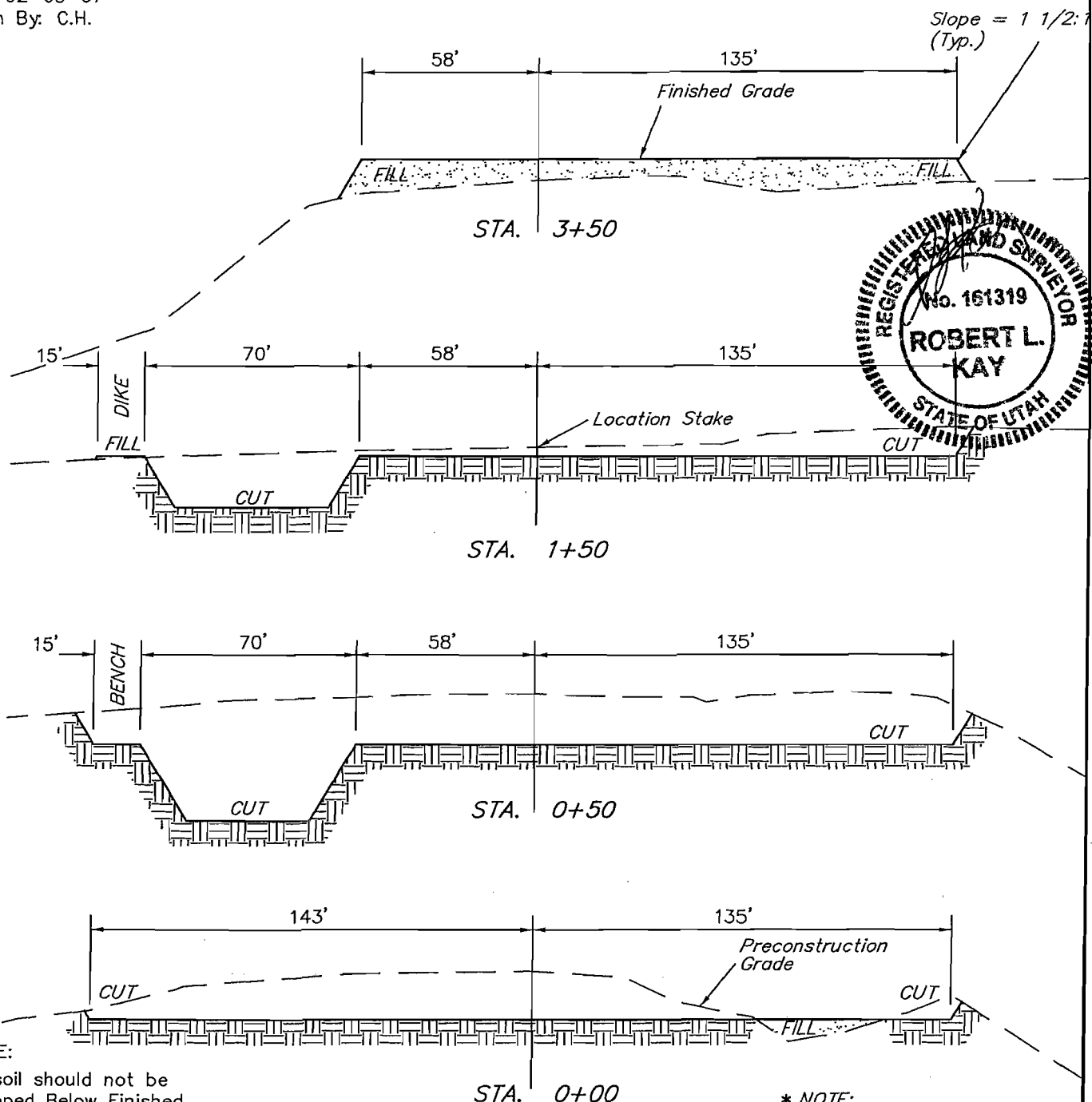

### NOTE:

Topsoil should not be Stripped Below Finished Grade on Substructure Area.

### \* NOTE:

FILL QUANTITY INCLUDES 5% FOR COMPACTION

### APPROXIMATE YARDAGES

CUT  
(12") Topsoil Stripping = 3,420 Cu. Yds.  
Remaining Location = 9,180 Cu. Yds.  
  
TOTAL CUT = 12,600 CU.YDS.  
FILL = 6,280 CU.YDS.

EXCESS MATERIAL = 6,320 Cu. Yds.  
Topsoil & Pit Backfill = 4,810 Cu. Yds.  
(1/2 Pit Vol.)  
EXCESS UNBALANCE = 1,510 Cu. Yds.  
(After Interim Rehabilitation)

UINTAH ENGINEERING & LAND SURVEYING  
85 So. 200 East \* Vernal, Utah 84078 \* (435) 789-1017

**WORKSHEET**  
**APPLICATION FOR PERMIT TO DRILL**

APD RECEIVED: 06/11/2007

API NO. ASSIGNED: 43-047-39371

WELL NAME: NBU 922-18G

OPERATOR: KERR-MCGEE OIL & GAS ( N2995 )

PHONE NUMBER: 435-781-7024

CONTACT: SHEILA UPCHEGO

PROPOSED LOCATION:

SWNE 18 090S 220E

SURFACE: 2009 FNL 1936 FEL

BOTTOM: 2009 FNL 1936 FEL

COUNTY: Uintah

LATITUDE: 40.03774 LONGITUDE: -109.4795

UTM SURF EASTINGS: 629720 NORTHINGS: 4432844

FIELD NAME: NATURAL BUTTES ( 630 )

INSPECT LOCATN BY: / /

Tech Review	Initials	Date
Engineering		
Geology		
Surface		

LEASE TYPE: 1 - Federal

LEASE NUMBER: UTU-0461

PROPOSED FORMATION: WSMVD

SURFACE OWNER: 2 - Indian

COALBED METHANE WELL? NO

RECEIVED AND/OR REVIEWED:

☒ Plat  
☒ Bond: Fed[1] Ind[] Sta[] Fee[]  
(No. RLB0005239 )  
☒ Potash (Y/N)  
☒ Oil Shale 190-5 (B) or 190-3 or 190-13  
☒ Water Permit  
(No. 43-8496 )  
☒ RDCC Review (Y/N)  
(Date: )  
☒ Fee Surf Agreement (Y/N)  
☒ Intent to Commingle (Y/N)

LOCATION AND SITING:

\_\_\_ R649-2-3.  
Unit: NATURAL BUTTES  
\_\_\_ R649-3-2. General  
Siting: 460 From Qtr/Qtr & 920' Between Wells  
\_\_\_ R649-3-3. Exception  
☒ Drilling Unit  
Board Cause No: 173.14  
Eff Date: 12.29.99  
Siting: 460' from boundary of Unknown Tracts  
\_\_\_ R649-3-11. Directional Drill

COMMENTS:

*See Separate File*

STIPULATIONS:

*1-Federal Approval  
2-OIL SHALE*



# United States Department of the Interior

## BUREAU OF LAND MANAGEMENT

Utah State Office  
P.O. Box 45155  
Salt Lake City, Utah 84145-0155

IN REPLY REFER TO:  
3160  
(UT-922)

June 18, 2007

### Memorandum

To: Assistant District Manager Minerals, Vernal District

From: Michael Coulthard, Petroleum Engineer

Subject: 2007 Plan of Development Natural Buttes Unit Uintah County, Utah.

Pursuant to email between Diana Whitney, Division of Oil, Gas and Mining, and Mickey Coulthard, Utah State Office, Bureau of Land Management, the following wells are planned for calendar year 2007 within the Natural Buttes Unit, Uintah County, Utah.

API #	WELL NAME	LOCATION
-------	-----------	----------

(Proposed PZ Wasatch/MesaVerde)

43-047-39375	NBU 1021-05MT	Sec 05 T10S R21E 0745 FSL 0529 FWL
43-047-39376	NBU 1021-11I	Sec 11 T10S R21E 2387 FSL 1247 FEL
43-047-39377	NBU 1021-11O	Sec 11 T10S R21E 1192 FSL 2437 FEL
43-047-39378	NBU 1021-11N	Sec 11 T10S R21E 1258 FSL 1861 FWL
43-047-39379	NBU 1021-11P	Sec 11 T10S R21E 0232 FSL 1170 FEL
43-047-39380	NBU 1021-11M	Sec 11 T10S R21E 0425 FSL 1318 FWL
43-047-39381	NBU 1021-11J	Sec 11 T10S R21E 2252 FSL 2402 FEL
43-047-39383	NBU 1021-12A	Sec 12 T10S R21E 0835 FNL 0781 FEL
43-047-39382	NBU 1021-12M	Sec 12 T10S R21E 1022 FSL 0329 FWL
43-047-39384	NBU 1021-12N	Sec 12 T10S R21E 0677 FSL 2302 FWL
43-047-39385	NBU 1021-12K	Sec 12 T10S R21E 1532 FSL 1952 FWL
43-047-39386	NBU 1021-12L	Sec 12 T10S R21E 1580 FSL 0196 FWL
43-047-39360	NBU 921-16J	Sec 16 T09S R21E 1994 FSL 1660 FEL
43-047-39361	NBU 921-16HT	Sec 16 T09S R21E 1858 FNL 1013 FEL
43-047-39362	NBU 921-16MT	Sec 16 T09S R21E 1261 FSL 1248 FWL
43-047-39363	NBU 921-17K	Sec 17 T09S R21E 2147 FSL 1635 FWL
43-047-39364	NBU 921-17J	Sec 17 T09S R21E 1508 FSL 1748 FEL
43-047-39365	NBU 921-20M	Sec 20 T09S R21E 0568 FSL 0586 FWL
43-047-39366	NBU 921-20O	Sec 20 T09S R21E 1026 FSL 1859 FEL
43-047-39367	NBU 921-23C	Sec 23 T09S R21E 0817 FNL 1945 FWL
43-047-39368	NBU 921-25NT	Sec 25 T09S R21E 1150 FSL 2607 FWL
43-047-39369	NBU 922-18O	Sec 18 T09S R22E 1255 FSL 2083 FEL

Page 2

43-047-39370 NBU 922-18I Sec 18 T09S R22E 1600 FSL 0901 FEL  
43-047-39371 NBU 922-18G Sec 18 T09S R22E 2009 FNL 1936 FEL  
43-047-39372 NBU 922-20E Sec 20 T09S R22E 2182 FNL 0452 FWL  
43-047-39387 NBU 1022-6B-2 Sec 06 T10S R22E 0160 FNL 2289 FEL  
43-047-39389 NBU 1022-24B Sec 24 T10S R22E 1035 FNL 1619 FEL  
43-047-39374 NBU 1020-24BT Sec 24 T10S R20E 0914 FNL 1966 FEL  
43-047-39373 NBU 1020-01KT Sec 01 T10S R20E 1731 FSL 1834 FWL

Our records indicate the NBU 1022-24B is closer than 460 feet from the Natural Buttes Unit boundary.

We have no objections to permitting the wells so long as the unit operator receives an exception to the locating and siting requirements of the State of Utah (R649-3-2).

/s/ Michael L. Coulthard

bcc: File – Natural Buttes Unit  
Division of Oil Gas and Mining  
Central Files  
Agr. Sec. Chron  
Fluid Chron

MCoulthard:mc:6-18-07



JON M. HUNTSMAN, JR.  
Governor

GARY R. HERBERT  
Lieutenant Governor

# State of Utah

## DEPARTMENT OF NATURAL RESOURCES

MICHAEL R. STYLER  
Executive Director

### Division of Oil Gas and Mining

JOHN R. BAZA  
Division Director

June 19, 2007

Kerr-McGee Oil & Gas  
1368 S 1200 East  
Vernal, UT 84078

Re: Natural Buttes Unit 922-18G Well, 2009' FNL, 1936' FEL, SW NE, Sec. 18, T. 9 South,  
R. 22 East, Uintah County, Utah

Gentlemen:

Pursuant to the provisions and requirements of Utah Code Ann. § 40-6-1 *et seq.*, Utah Administrative Code R649-3-1 *et seq.*, and the attached Conditions of Approval, approval to drill the referenced well is granted.

This approval shall expire one year from the above date unless substantial and continuous operation is underway, or a request for extension is made prior to the expiration date. The API identification number assigned to this well is 43-047-39371.

Sincerely,

Gil Hunt  
Associate Director

pab  
Enclosures

cc: Uintah County Assessor  
Bureau of Land Management, Vernal Office



**Operator:** Kerr-McGee Oil & Gas  
**Well Name & Number** Natural Buttes Unit 922-18G  
**API Number:** 43-047-39371  
**Lease:** UTU-0461

**Location:** SW NE                      **Sec.** 18                      **T.** 9 South                      **R.** 22 East

### **Conditions of Approval**

**1. General**

Compliance with the requirements of Utah Admin. R. 649-1 *et seq.*, the Oil and Gas Conservation General Rules, and the applicable terms and provisions of the approved Application for permit to drill.

**2. Notification Requirements**

Notify the Division with 24 hours of spudding the well.

- Contact Carol Daniels at (801) 538-5284.

Notify the Division prior to commencing operations to plug and abandon the well.

- Contact Dustin Doucet at (801) 538-5281 office      (801) 733-0983 home

**3. Reporting Requirements**

All required reports, forms and submittals will be promptly filed with the Division, including but not limited to the Entity Action Form (Form 6), Report of Water Encountered During Drilling (Form 7), Weekly Progress Reports for drilling and completion operations, and Sundry Notices and Reports on Wells requesting approval of change of plans or other operational actions.

**4. State approval of this well does not supersede the required federal approval, which must be obtained prior to drilling.**

**5. In accordance with Order in Cause No. 190-5(b) dated October 28, 1982, the Operator shall comply with requirements of Rules R649-3-31 and R649-3-27 pertaining to Designated Oil Shale Areas. Additionally, the operator shall ensure that the surface and/or production casing is properly cemented over the entire oil shale interval as defined by Rule R649-3-31. The Operator shall report the actual depth the oil shale is encountered to the Division.**

RECEIVED  
VERNAL FIELD OFFICE

2007 JUN -5 PM 2:48

UNITED STATES  
DEPARTMENT OF THE INTERIOR  
BUREAU OF LAND MANAGEMENT

FORM APPROVED  
OMB No. 1004-0136  
Expires November 30, 2000

APPLICATION FOR PERMIT TO DRILL OR REENTER

1a. Type of Work: ☒ DRILL ☐ REENTER

b. Type of Well: ☐ Oil Well ☒ Gas Well ☐ Other ☐ Single Zone ☒ Multiple Zone

2. Name of Operator  
**KERR MCGEE OIL AND GAS ONSHORE LP**

3A. Address  
**1368 SOUTH 1200 EAST VERNAL, UT 84078**

3b. Phone No. (include area code)  
**(435) 781-7024**

4. Location of Well (Report location clearly and in accordance with any State requirements. \*)

At surface **SW/NE 2009'FNL, 1936'FEL**

At proposed prod. Zone

14. Distance in miles and direction from nearest town or post office\*  
**18.55 +/- MILES SOUTHEAST OF OURAY, UTAH**

15. Distance from proposed\*  
location to nearest  
property or lease line, ft.  
(Also to nearest drig. unit line, if any) **1936'**

16. No. of Acres in lease  
**601.96**

17. Spacing Unit dedicated to this well  
**40.00**

18. Distance from proposed location\*  
to nearest well, drilling, completed,  
applied for, on this lease, ft. **REFER TO  
TOPO C**

19. Proposed Depth  
**9730'**

20. BLM/BIA Bond No. on file  
**RLB0005239**

21. Elevations (Show whether DF, KDB, RT, GL, etc.)  
**4802'GL**

22. Approximate date work will start\*  
**UPON APPROVAL**

23. Estimated duration  
**TO BE DETERMINED**

24. Attachments

The following, completed in accordance with the requirements of Onshore Oil and Gas Order No. 1, shall be attached to this form:

1. Well plat certified by a registered surveyor.
2. A Drilling Plan.
3. A Surface Use Plan (if the location is on National Forest System Lands, the SUPO shall be filed with the appropriate Forest Service Office).

4. Bond to cover the operations unless covered by an existing bond on file (see Item 20 above).
5. Operator certification.
6. Such other site specific information and/or plans as may be required by the authorized office.

25. Signature 

Name (Printed/Typed)  
**SHEILA UPCHEGO**

Date  
**6/4/2007**

Title  
**SENIOR LAND ADMIN SPECIALIST**

Approved by (Signature)

Name (Printed/Typed)  
**Jerry Kaveks**

Date  
**10-22-2007**

Title  
**Assistant Field Manager  
Lands & Mineral Resources**

Office  
**VERNAL FIELD OFFICE**

Application approval does not warrant or certify that the applicant holds legal or equitable title to those rights in the subject lease which would entitle the applicant to conduct operations thereon.

Conditions of approval, if any, are attached.

Title 18 U.S.C. Section 1001 and Title 43 U.S.C. Section 1212, make it a crime for any person knowingly and willfully to make to any department or agency of the United States any false, fictitious or fraudulent statements or representations as to any matter within its jurisdiction.

\*(Instructions on reverse)

**NOTICE OF APPROVAL**

**CONDITIONS OF APPROVAL ATTACHED**

**NO 205  
07/11/0033A**



UNITED STATES DEPARTMENT OF THE INTERIOR  
BUREAU OF LAND MANAGEMENT  
VERNAL FIELD OFFICE

170 South 500 East VERNAL, UT 84078 (435) 781-4400



**CONDITIONS OF APPROVAL FOR APPLICATION FOR PERMIT TO DRILL**

Company: Kerr-McGee Oil & Gas Onshore, LP Location: SWNE Sec. 18, T9S, R22E  
Well No: NBU 922-18G Lease No: UTU-0461  
API No: 43-047-39371 Agreement: Natural Buttes Unit

Title	Name	Office Phone Number	Cell Phone Number
Petroleum Engineer:	Matt Baker	(435) 781-4490	(435) 828-4470
Petroleum Engineer:	Michael Lee	(435) 781-4432	(435) 828-7875
Petroleum Engineer:	James Ashley	(435) 781-4470	(435) 828-7874
Petroleum Engineer:	Ryan Angus	(435) 781-4430	(435) 828-7368
Supervisory Petroleum Technician:	Jamie Sparger	(435) 781-4502	(435) 828-3913
NRS/Enviro Scientist:	Paul Buhler	(435) 781-4475	(435) 828-4029
NRS/Enviro Scientist:	Karl Wright	(435) 781-4484	(435) 828-7381
NRS/Enviro Scientist:	Holly Villa	(435) 781-4404	
NRS/Enviro Scientist:		(435) 781-4476	
NRS/Enviro Scientist:	Chuck MacDonald	(435) 781-4441	(435) 828-7481
NRS/Enviro Scientist:	Jannice Cutler	(435) 781-3400	(435) 828-3544
NRS/Enviro Scientist:	Michael Cutler	(435) 781-3401	(435) 828-3546
NRS/Enviro Scientist:	Anna Figueroa	(435) 781-3407	(435) 828-3548
NRS/Enviro Scientist:	Verlyn Pindell	(435) 781-3402	(435) 828-3547
NRS/Enviro Scientist:	Darren Williams	(435) 781-4447	
NRS/Enviro Scientist:	Nathan Packer	(435) 781-3405	(435) 828-3545

Fax: (435) 781-3420

**A COPY OF THESE CONDITIONS SHALL BE FURNISHED TO YOUR  
FIELD REPRESENTATIVE TO INSURE COMPLIANCE**

All lease and/or unit operations are to be conducted in such a manner that full compliance is made with the applicable laws, regulations (43 CFR Part 3160), and this approved Application for Permit to Drill including Surface and Downhole Conditions of Approval. The operator is considered fully responsible for the actions of his subcontractors. A copy of the approved APD must be on location during construction, drilling, and completion operations. **This permit is approved for a two (2) year period, or until lease expiration, whichever occurs first. An additional extension, up to two (2) years, may be applied for by sundry notice prior to expiration.**

**NOTIFICATION REQUIREMENTS**

Location Construction (Notify Environmental Scientist)	- Forty-Eight (48) hours prior to construction of location and access roads.
Location Completion (Notify Environmental Scientist)	- Prior to moving on the drilling rig.
Spud Notice (Notify Petroleum Engineer)	- Twenty-Four (24) hours prior to spudding the well.
Casing String & Cementing (Notify Supv. Petroleum Tech.)	- Twenty-Four (24) hours prior to running casing and cementing all casing strings.
BOP & Related Equipment Tests (Notify Supv. Petroleum Tech.)	- Twenty-Four (24) hours prior to initiating pressure tests.
First Production Notice (Notify Petroleum Engineer)	- Within Five (5) business days after new well begins or production resumes after well has been off production for more than ninety (90) days.

**SURFACE USE PROGRAM  
CONDITIONS OF APPROVAL (COAs)**

**General Surface COAs:**

- If there is an active Gilsonite mining operation within 2 miles of the well location, operator shall notify the Gilsonite operator at least 48 hours prior to any blasting during construction.
- If paleontological materials are uncovered during construction, the operator is to immediately stop work and contact the Authorized Officer (AO). A determination will be made by the AO as to what mitigation may be necessary for the discovered paleontologic material before construction can continue.

**Specific Surface COAs:**

- 1) Paint tanks Carlsbad tan.
  - 2) Culverts as need in road, to be determined by Construction Foreman.
- A 30' foot corridor right-of-way shall be approved. Upon completion of each pipeline in corridor, they shall be identified and filed with the Ute Tribe.
  - A qualified Archaeologist accompanied by a Tribal Technician will monitor trenching construction of pipeline.
  - The Ute Tribe Energy & Minerals Department is to be notified, in writing 48 hours prior to construction of pipeline.
  - Construction Notice shall be given to the department on the Ute Tribe workdays, which are Monday through Thursday. The Company understands that they may be responsible for costs incurred by the Ute Tribe after hours.
  - The Company shall inform contractors to maintain construction of pipelines within the approved ROWs.
  - The Company shall assure the Ute Tribe that "ALL CONTRACTORS, INCLUDING SUB-CONTRACTORS, LEASING CONTRACTORS, AND ETC." have acquired a current and valid Ute Tribal Business License and have "Access Permits" prior to construction, and will have these permits in all vehicles at all times.
  - You are hereby notified that working under the "umbrella" of a company does not allow you to be in the field, and can be subject to those fines of the Ute Tribe Severance Tax Ordinance.
  - Any deviation of submitted APDs and ROW applications the Companies will notify the Ute Tribe and BIA in writing and will receive written authorization of any such change with appropriate authorization.
  - The Company will implement "Safety and Emergency Plan." The Company's safety director will ensure its compliance.
  - All Company employees and/or authorized personnel (sub-contractors) in the field will have approved applicable APDs and/or ROW permits/authorizations on their person(s) during all phases of construction.
  - All vehicular traffic, personnel movement, construction/restoration operations shall be confined to the area examined and approved, and to the existing roadways and/or evaluated access routes.
  - All personnel shall refrain from collecting artifacts, any paleontological fossils, and from disturbing any significant cultural resources in the area.
  - The personnel from the Ute Tribe Energy & Minerals Department shall be notified

shall cultural remains from subsurface deposits be exposed or identified during construction. All construction will cease.

- All mitigative stipulations contained in the Bureau of Indian Affairs Site Specific Environmental Assessment (EA) will be strictly adhered.
- Upon completion of Application for Corridor Right-Way, the company will notify the Ute Tribe Energy & Minerals Department, so that a Tribal Technician can verify Affidavit of Completion.

## **DOWNHOLE CONDITIONS OF APPROVAL**

### **SITE SPECIFIC DOWNHOLE CONDITIONS OF APPROVAL**

- None

**All provisions outlined in Onshore Oil & Gas Order #2 Drilling Operations shall be strictly adhered to.** The following items are emphasized:

### **DRILLING/COMPLETION/PRODUCING OPERATING STANDARDS**

- The spud date and time shall be reported orally to Vernal Field Office within 24 hours of spudding.
- Notify Vernal Field Office Supervisory Petroleum Engineering Technician at least 24 hours in advance of casing cementing operations and BOPE & casing pressure tests.
- Blowout prevention equipment (BOPE) shall remain in use until the well is completed or abandoned. Closing unit controls shall remain unobstructed and readily accessible at all times. Choke manifolds shall be located outside of the rig substructure.
- All BOPE components shall be inspected daily and those inspections shall be recorded in the daily drilling report. Components shall be operated and tested as required by Onshore Oil & Gas Order No. 2 to insure good mechanical working order. All BOPE pressure tests shall be performed by a test pump with a chart recorder and **NOT** by the rig pumps. Test shall be reported in the driller's log.
- BOP drills shall be initially conducted by each drilling crew within 24 hours of drilling out from under the surface casing and weekly thereafter as specified in Onshore Oil & Gas Order No. 2.
- Casing pressure tests are required before drilling out from under all casing strings set and cemented in place.
- No aggressive/fresh hard-banded drill pipe shall be used within casing.
- **Cement baskets shall not be run on surface casing.**
- The operator must report all shows of water or water-bearing sands to the BLM. If flowing water is encountered it must be sampled, analyzed, and a copy of the analyses submitted to the BLM Vernal Field Office.
- The operator must report encounters of all non oil & gas mineral resources (such as Gilsonite, tar sands, oil shale, trona, etc.) to the Vernal Field Office, in writing, within 5 working days of each encounter. Each report shall include the well name/number, well location, date and depth (from KB or GL) of encounter, vertical footage of the encounter and, the name of the person making the report (along with a telephone number) should the BLM need to obtain additional information.

- A complete set of angular deviation and directional surveys of a directional well will be submitted to the Vernal BLM office engineer within 30 days of the completion of the well.
- Chronologic drilling progress reports shall be filed directly with the BLM, Vernal Field Office on a weekly basis in sundry, letter format or e-mail to the Petroleum Engineers until the well is completed.
- A cement bond log (CBL) will be run from the production casing shoe to the top of cement and shall be utilized to determine the bond quality for the production casing. Submit a field copy of the CBL to this office.
- **Please submit an electronic copy of all other logs run on this well in LAS format to UT\_VN\_Welllogs@BLM.gov. This submission will supersede the requirement for submittal of paper logs to the BLM.**
- There shall be no deviation from the proposed drilling, completion, and/or workover program as approved. Safe drilling and operating practices must be observed. Any changes in operation must have prior approval from the BLM Vernal Field Office.

## OPERATING REQUIREMENT REMINDERS:

- All wells, whether drilling, producing, suspended, or abandoned, shall be identified in accordance with 43 CFR 3162.6. There shall be a sign or marker with the name of the operator, lease serial number, well number, and surveyed description of the well.
- In accordance with 43 CFR 3162.4-3, this well shall be reported on the "Monthly Report of Operations" (Oil and Gas Operations Report ((OGOR)) starting with the month in which operations commence and continue each month until the well is physically plugged and abandoned. This report shall be filed in duplicate, directly with the Minerals Management Service, P.O. Box 17110, Denver, Colorado 80217-0110, or call 1-800-525-7922 (303) 231-3650 for reporting information.
- Should the well be successfully completed for production, the BLM Vernal Field office must be notified when it is placed in a producing status. Such notification will be by written communication and must be received in this office by not later than the fifth business day following the date on which the well is placed on production. The notification shall provide, as a minimum, the following informational items:
  - Operator name, address, and telephone number.
  - Well name and number.
  - Well location (¼¼, Sec., Twn, Rng, and P.M.).
  - Date well was placed in a producing status (date of first production for which royalty will be paid).
  - The nature of the well's production, (i.e., crude oil, or crude oil and casing head gas, or natural gas and entrained liquid hydrocarbons).
  - The Federal or Indian lease prefix and number on which the well is located; otherwise the non-Federal or non-Indian land category, i.e., State or private.
  - Unit agreement and/or participating area name and number, if applicable.
  - Communitization agreement number, if applicable.
- Any venting or flaring of gas shall be done in accordance with Notice to Lessees (NTL) 4A and needs prior approval from the BLM Vernal Field Office.
- All undesirable events (fires, accidents, blowouts, spills, discharges) as specified in NTL 3A will be reported to the BLM, Vernal Field Office. Major events, as defined in NTL3A, shall be reported verbally within 24 hours, followed by a written report within 15 days. "Other than Major Events" will be reported in writing within 15 days. "Minor Events" will be reported on the Monthly Report of Operations and Production.
- Whether the well is completed as a dry hole or as a producer, "Well Completion and Recompletion Report and Log" (BLM Form 3160-4) shall be submitted not later than 30 days after completion of the well or after completion of operations being performed, in accordance with 43 CFR 3162.4-1. Two copies of all logs run, core descriptions, and all other surveys or data obtained and compiled during the drilling, workover, and/or completion operations, shall be filed on BLM Form 3160-4. Submit with the well completion report a geologic report including, at a minimum, formation tops, and a summary and conclusions. Also include



deviation surveys, sample descriptions, strip logs, core data, drill stem test data, and results of production tests if performed. Samples (cuttings, fluid, and/or gas) shall be submitted only when requested by the BLM, Vernal Field Office.

- All off-lease storage, off-lease measurement, or commingling on-lease or off-lease, shall have prior written approval from the BLM Vernal Field Office.
- Oil and gas meters shall be calibrated in place prior to any deliveries. The BLM Vernal Field Office Petroleum Engineers will be provided with a date and time for the initial meter calibration and all future meter proving schedules. A copy of the meter calibration reports shall be submitted to the BLM Vernal Field Office. All measurement facilities will conform to the API standards for liquid hydrocarbons and the AGA standards for natural gas measurement. All measurement points shall be identified as the point of sale or allocation for royalty purposes.
- A schematic facilities diagram as required by Onshore Oil & Gas Order No. 3 shall be submitted to the BLM Vernal Field Office within 30 days of installation or first production, whichever occurs first. All site security regulations as specified in Onshore Oil & Gas Order No. 3 shall be adhered to. All product lines entering and leaving hydrocarbon storage tanks will be effectively sealed in accordance with Onshore Oil & Gas Order No. 3.
- Any additional construction, reconstruction, or alterations of facilities, including roads, gathering lines, batteries, etc., which will result in the disturbance of new ground, shall require the filing of a suitable plan and need prior approval of the BLM Vernal Field Office. Emergency approval may be obtained orally, but such approval does not waive the written report requirement.
- No location shall be constructed or moved, no well shall be plugged, and no drilling or workover equipment shall be removed from a well to be placed in a suspended status without prior approval of the BLM Vernal Field Office. If operations are to be suspended for more than 30 days, prior approval of the BLM Vernal Field Office shall be obtained and notification given before resumption of operations.
- Pursuant to Onshore Oil & Gas Order No. 7, this is authorization for pit disposal of water produced from this well for a period of 90 days from the date of initial production. A permanent disposal method must be approved by this office and in operation prior to the end of this 90-day period. In order to meet this deadline, an application for the proposed permanent disposal method shall be submitted along with any necessary water analyses, as soon as possible, but no later than 45 days after the date of first production. Any method of disposal which has not been approved prior to the end of the authorized 90-day period will be considered as an Incident of Noncompliance and will be grounds for issuing a shut-in order until an acceptable manner for disposing of said water is provided and approved by this office.
- Unless the plugging is to take place immediately upon receipt of oral approval, the Field Office Petroleum Engineers must be notified at least 24 hours in advance of the plugging of the well, in order that a representative may witness plugging operations. If a well is suspended or abandoned, all pits must be fenced immediately until they are backfilled. The "Subsequent Report of Abandonment" (Form BLM 3160-5) must be submitted within 30 days after the actual plugging of the well bore, showing location of plugs, amount of cement in each, and amount of casing left in hole, and the current status of the surface restoration.

## DIVISION OF OIL, GAS AND MINING

### ***SPUDDING INFORMATION***

Name of Company: Kerr-McGee Oil & Gas Onshore, LP

Well Name: NBU 922-18G

API No: 43-047-39371 Lease Type: Federal/Indian

Section 18 Township 09S Range 22 E County Uintah

Drilling Contractor Pete Martin Drilling Rig # Bucket

### **SPUDDED:**

Date 12-10-07

Time 1:30 PM

How Dry

***Drilling will Commence:*** \_\_\_\_\_

Reported by Lou Weldon

Telephone # 435-828-7035

Date 12-13-07 Signed RM

**STATE OF UTAH**  
DEPARTMENT OF NATURAL RESOURCES  
DIVISION OF OIL, GAS AND MINING

FORM 6

**ENTITY ACTION FORM**

Operator: KERR MCGEE OIL & GAS ONSHORE LP Operator Account Number: N 2995  
Address: 1368 SOUTH 1200 EAST  
city VERNAL  
state UT zip 84078 Phone Number: (435) 781-7024

**Well 1**

API Number	Well Name		QQ	Sec	Twp	Rng	County
4304739371	NBU 922-18G		SWNE	18	9S	22E	UINTAH
Action Code	Current Entity Number	New Entity Number	Spud Date			Entity Assignment Effective Date	
<u>B</u>	99999	<u>2900</u>	12/10/2007			<u>12/31/07</u>	
<b>Comments:</b> MIRU PETE MARTIN BUCKET RIG. <u>WSMVD</u> SPUD WELL LOCATION ON 12/10/2007 AT 1330 HRS.							

**Well 2**

API Number	Well Name		QQ	Sec	Twp	Rng	County
Action Code	Current Entity Number	New Entity Number	Spud Date			Entity Assignment Effective Date	
<b>Comments:</b>							

**Well 3**

API Number	Well Name		QQ	Sec	Twp	Rng	County
Action Code	Current Entity Number	New Entity Number	Spud Date			Entity Assignment Effective Date	
<b>Comments:</b>							

**ACTION CODES:**

- A - Establish new entity for new well (single well only)
- B - Add new well to existing entity (group or unit well)
- C - Re-assign well from one existing entity to another existing entity
- D - Re-assign well from one existing entity to a new entity
- E - Other (Explain in 'comments' section)

SHEILA UPCHEGO

Name (Please Print)

Signature

SENIOR LAND SPECIALIST

12/11/2007

Title

Date

**RECEIVED**

**DEC 11 2007**

**DIV. OF OIL, GAS & MINING**

UNITED STATES  
DEPARTMENT OF THE INTERIOR  
BUREAU OF LAND MANAGEMENT

**SUNDRY NOTICES AND REPORTS ON WELLS**  
*Do not use this form for proposals to drill or reenter an  
abandoned well. Use Form 3160-3 (APD) for such proposals.*

**SUBMIT IN TRIPLICATE - Other instructions on reverse side**

1. Type of Well  
☐ Oil Well ☒ Gas Well ☐ Other

2. Name of Operator

KERR-McGEE OIL & GAS ONSHORE LP

3a. Address

1368 SOUTH 1200 EAST VERNAL, UT 84078

3b. Phone No. (include area code)

(435) 781-7024

4. Location of Well (Footage, Sec., T., R., M., or Survey Description)

SW/NE SEC. 18, T9S, R22E 2009'FNL, 1936'FEL

FORM APPROVED  
OMB No. 1004-0135  
Expires November 30, 2000

5. Lease Serial No.

UTU-0461

6. If Indian, Allottee or Tribe Name

TRIBAL SURFACE

7. If Unit or CA/Agreement, Name and/or No.

UNIT #891008900A

NATURAL BUTTES UNIT

8. Well Name and No.

NBU 922-18G

9. API Well No.

4304739371

10. Field and Pool, or Exploratory Area

NATURAL BUTTES

11. County or Parish, State

UINTAH COUNTY, UTAH

12. CHECK APPROPRIATE BOX(ES) TO INDICATE NATURE OF NOTICE, REPORT, OR OTHER DATA

TYPE OF SUBMISSION	TYPE OF ACTION			
<input type="checkbox"/> Notice of Intent	<input type="checkbox"/> Acidize	<input type="checkbox"/> Deepen	<input type="checkbox"/> Production (Start/Resume)	<input type="checkbox"/> Water Shut-Off
<input checked="" type="checkbox"/> Subsequent Report	<input type="checkbox"/> Alter Casing	<input type="checkbox"/> Fracture Treat	<input type="checkbox"/> Reclamation	<input type="checkbox"/> Well Integrity
<input type="checkbox"/> Final Abandonment Notice	<input type="checkbox"/> Casing Repair	<input type="checkbox"/> New Construction	<input type="checkbox"/> Recomplete	<input checked="" type="checkbox"/> Other WELL SPUD
	<input type="checkbox"/> Change Plans	<input type="checkbox"/> Plug and Abandon	<input type="checkbox"/> Temporarily Abandon	
	<input type="checkbox"/> Convert to Injection	<input type="checkbox"/> Plug Back	<input type="checkbox"/> Water Disposal	

13. Describe Proposed or Completed Operations (clearly state all pertinent details, including estimated starting date of any proposed work and approximate duration thereof. If the proposal is to deepen directionally or recompleat horizontally, give subsurface locations and measured and true vertical depths of all pertinent markers and zones. Attach the Bond under which the work will be performed or provide the Bond No. on file with BLM/BIA. Required subsequent reports shall be filed within 30 days following completion of the involved operations. If the operation results in a multiple completion or recompleat in a new interval, a Form 3160-4 shall be filed once testing has been completed. Final Abandonment Notices shall be filed only after all requirements, including reclamation, have been completed, and the operator has determined that the site is ready for final inspection.

MIRU PETE MARTIN BUCKET RIG. DRILLED 20" CONDUCTOR HOLE TO 40'. RAN 14" 36.7# SCHEDULE 10 PIPE. CMT W/28 SX READY MIX.

SPUD WELL LOCATION ON 12/10/2007 AT 1330 HRS.

RECEIVED

DEC 14 2007

DIV. OF OIL, GAS & MINING

14. I hereby certify that the foregoing is true and correct

Name (Printed/Typed)

SHEILA UPCHEGO

Signature

Title

SENIOR LAND ADMIN SPECIALIST

Date

December 11, 2007

THIS SPACE FOR FEDERAL OR STATE USE

Approved by

Title

Date

Conditions of approval, if any, are attached. Approval of this notice does not warrant or certify that the applicant holds legal or equitable title to those rights in the subject lease which would entitle the applicant to conduct operations thereon.

Office

Title 18 U.S.C. Section 1001, make it a crime for any person knowingly and willfully to make to any department or agency of the United States any false, fictitious or fraudulent statements or representations as to any matter within its jurisdiction.

(Instructions on reverse)

UNITED STATES  
DEPARTMENT OF THE INTERIOR  
BUREAU OF LAND MANAGEMENTFORM APPROVED  
OMB No. 1004-0135  
Expires November 30, 2000

## SUNDRY NOTICES AND REPORTS ON WELLS

**Do not use this form for proposals to drill or reenter an abandoned well. Use Form 3160-3 (APD) for such proposals.**

**SUBMIT IN TRIPLICATE – Other instructions on reverse side**

1. Type of Well

☐ Oil Well ☒ Gas Well ☐ Other

2. Name of Operator

KERR-McGEE OIL &amp; GAS ONSHORE LP

3a. Address

1368 SOUTH 1200 EAST VERNAL, UT 84078

3b. Phone No. (include area code)

(435) 781-7024

4. Location of Well (Footage, Sec., T., R., M., or Survey Description)

SW/NE SEC. 18, T9S, R22E 2009'FNL, 1936'FEL

5. Lease Serial No.

UTU-0461

6. If Indian, Allottee or Tribe Name

TRIBAL SURFACE

7. If Unit or CA/Agreement, Name and/or No.

UNIT #891008900A

NATURAL BUTTES UNIT

8. Well Name and No.

NBU 922-18G

9. API Well No.

4304739371

10. Field and Pool, or Exploratory Area

NATURAL BUTTES

11. County or Parish, State

UINTAH COUNTY, UTAH

## 12. CHECK APPROPRIATE BOX(ES) TO INDICATE NATURE OF NOTICE, REPORT, OR OTHER DATA

TYPE OF SUBMISSION	TYPE OF ACTION			
<input type="checkbox"/> Notice of Intent	<input type="checkbox"/> Acidize	<input type="checkbox"/> Deepen	<input type="checkbox"/> Production (Start/Resume)	<input type="checkbox"/> Water Shut-Off
<input checked="" type="checkbox"/> Subsequent Report	<input type="checkbox"/> Alter Casing	<input type="checkbox"/> Fracture Treat	<input type="checkbox"/> Reclamation	<input type="checkbox"/> Well Integrity
<input type="checkbox"/> Final Abandonment Notice	<input type="checkbox"/> Casing Repair	<input type="checkbox"/> New Construction	<input type="checkbox"/> Recomplete	<input checked="" type="checkbox"/> Other SET SURFACE
	<input type="checkbox"/> Change Plans	<input type="checkbox"/> Plug and Abandon	<input type="checkbox"/> Temporarily Abandon	CSG
	<input type="checkbox"/> Convert to Injection	<input type="checkbox"/> Plug Back	<input type="checkbox"/> Water Disposal	

13. Describe Proposed or Completed Operations (clearly state all pertinent details, including estimated starting date of any proposed work and approximate duration thereof. If the proposal is to deepen directionally or recompleat horizontally, give subsurface locations and measured and true vertical depths of all pertinent markers and zones. Attach the Bond under which the work will be performed or provide the Bond No. on file with BLM/BIA. Required subsequent reports shall be filed within 30 days following completion of the involved operations. If the operation results in a multiple completion or recompleat in a new interval, a Form 3160-4 shall be filed once testing has been completed. Final Abandonment Notices shall be filed only after all requirements, including reclamation, have been completed, and the operator has determined that the site is ready for final inspection.

MIRU BILL MARTIN AIR RIG ON 01/09/2008. DRILLED 12 1/4" SURFACE HOLE TO 2740'. RAN 9 5/8" 36# J-55 SURFACE CSG. LEAD CMT W/250 SX HIFILL CLASS G @11.0 PPG 3.82 YIELD. TAILED CMT W/200 SX PREM CLASS G @15.8 PPG 1.15 YIELD. GOOD RETURNS THROUGH OUT JOB 20 +/- BBLS LEAD CMT TO PIT. RAN 200' OF 1" PIPE. CMT W/80 SX PREM CLASS G @15.8 PPG 1.15 YIELD. DOWN 1" PIPE GOOD CMT TO SURFACE AND FELL BACK. TOP OUT W/85 SX PREM CLASS G @15.8 PPG 1.15 YIELD. DOWN BACKSIDE GOOD CMT TO SURFACE HOLE STAYED FULL.

WORT.

14. I hereby certify that the foregoing is true and correct

Name (Printed/Typed)

SHEILA UPCHEGO

Title

SENIOR LAND ADMIN SPECIALIST

Date

January 15, 2008

THIS SPACE FOR FEDERAL OR STATE USE

Approved by

Title

Date

Conditions of approval, if any, are attached. Approval of this notice does not warrant or certify that the applicant holds legal or equitable title to those rights in the subject lease which would entitle the applicant to conduct operations thereon.

Office

Title 18 U.S.C. Section 1001, make it a crime for any person knowingly and willfully to make to any department or agency of the United States any false, fictitious or fraudulent statements or representations as to any matter within its jurisdiction.

(Instructions on reverse)

RECEIVED  
Bureau of Land Management, Vernal, Utah

JAN 28 2008

DIV. OF OIL, GAS &amp; MINING

UNITED STATES  
DEPARTMENT OF THE INTERIOR  
BUREAU OF LAND MANAGEMENT

FORM APPROVED  
OMB No. 1004-0135  
Expires November 30, 2000

SUNDRY NOTICES AND REPORTS ON WELLS

Do not use this form for proposals to drill or reenter an abandoned well. Use Form 3160-3 (APD) for such proposals.

SUBMIT IN TRIPLICATE - Other instructions on reverse side

1. Type of Well

☐ Oil Well ☒ Gas Well ☐ Other

2. Name of Operator

KERR-McGEE OIL & GAS ONSHORE LP

3a. Address

1368 SOUTH 1200 EAST VERNAL, UT 84078

3b. Phone No. (include area code)

(435) 781-7024

4. Location of Well (Footage, Sec., T., R., M., or Survey Description)

SW/NE SEC. 18, T9S, R22E 2009'FNL, 1936'FEL

5. Lease Serial No.

UTU-0461

6. If Indian, Allottee or Tribe Name

TRIBAL SURFACE

7. If Unit or CA/Agreement, Name and/or No.

UNIT #891008900A

NATURAL BUTTES UNIT

8. Well Name and No.

NBU 922-18G

9. API Well No.

4304739371

10. Field and Pool, or Exploratory Area

NATURAL BUTTES

11. County or Parish, State

UINTAH COUNTY, UTAH

12. CHECK APPROPRIATE BOX(ES) TO INDICATE NATURE OF NOTICE, REPORT, OR OTHER DATA

TYPE OF SUBMISSION	TYPE OF ACTION			
<input type="checkbox"/> Notice of Intent	<input type="checkbox"/> Acidize	<input type="checkbox"/> Deepen	<input type="checkbox"/> Production (Start/Resume)	<input type="checkbox"/> Water Shut-Off
<input checked="" type="checkbox"/> Subsequent Report	<input type="checkbox"/> Alter Casing	<input type="checkbox"/> Fracture Treat	<input type="checkbox"/> Reclamation	<input type="checkbox"/> Well Integrity
<input type="checkbox"/> Final Abandonment Notice	<input type="checkbox"/> Casing Repair	<input type="checkbox"/> New Construction	<input type="checkbox"/> Recomplete	<input checked="" type="checkbox"/> Other FINAL DRILLING OPERATIONS
	<input type="checkbox"/> Change Plans	<input type="checkbox"/> Plug and Abandon	<input type="checkbox"/> Temporarily Abandon	
	<input type="checkbox"/> Convert to Injection	<input type="checkbox"/> Plug Back	<input type="checkbox"/> Water Disposal	

13. Describe Proposed or Completed Operations (clearly state all pertinent details, including estimated starting date of any proposed work and approximate duration thereof. If the proposal is to deepen directionally or recompleat horizontally, give subsurface locations and measured and true vertical depths of all pertinent markers and zones. Attach the Bond under which the work will be performed or provide the Bond No. on file with BLM/BIA. Required subsequent reports shall be filed within 30 days following completion of the involved operations. If the operation results in a multiple completion or recompleat in a new interval, a Form 3160-4 shall be filed once testing has been completed. Final Abandonment Notices shall be filed only after all requirements, including reclamation, have been completed, and the operator has determined that the site is ready for final inspection.

FINISHED DRILLING FROM 2740' TO 9530' ON 03/30/2008. RAN 4 1/2" 11.6# I-80 PRODUCTION CSG. LEAD CMT W/445 SX HALCO LITE 11.2 PPG 3.00 YIELD. TAILED CMT W/1215 SX 50/50 POZ @ 14.3 PPG 1.31 YIELD. WASH LINES DROP PLUG DISPLACE W/147 BBLS WATER W/CLAY STAY AND MAGNACIDE TO BUMP PLUG W/4000 PSI RELEASE PSI FLOATS HELD HAD 7 BBLS MUD FLUSH BACK TO SURFACE NO CMT WASH STACK HANG CASING W/80K TEST HANGER TO 5000 PSI ND BOP CLEAN PITS SLIPS AND CUT DRILL LINE.

RELEASED ENSIGN RIG 12 ON 03/31/2008 AT 1800 HRS.

14. I hereby certify that the foregoing is true and correct

Name (Printed/Typed)

SHEILA UPCHEGO

Title

SENIOR LAND ADMIN SPECIALIST

Signature

Date

April 1, 2008

THIS SPACE FOR FEDERAL OR STATE USE

Approved by

Title

Date

Conditions of approval, if any, are attached. Approval of this notice does not warrant or certify that the applicant holds legal or equitable title to those rights in the subject lease which would entitle the applicant to conduct operations thereon.

Office

Title 18 U.S.C. Section 1001, make it a crime for any person knowingly and willfully to make to any department or agency of the United States any false, fictitious or fraudulent statements or representations as to any matter within its jurisdiction.

(Instructions on reverse)

RECEIVED

APR 15 2008

DIV. OF OIL, GAS & MINING

UNITED STATES  
DEPARTMENT OF THE INTERIOR  
BUREAU OF LAND MANAGEMENT

FORM APPROVED  
OMB No. 1004-0135  
Expires November 30, 2000

**SUNDRY NOTICES AND REPORTS ON WELLS**

**Do not use this form for proposals to drill or reenter an abandoned well. Use Form 3160-3 (APD) for such proposals.**

**SUBMIT IN TRIPLICATE – Other instructions on reverse side**

1. Type of Well

☐ Oil Well ☒ Gas Well ☐ Other

2. Name of Operator

**KERR-McGEE OIL & GAS ONSHORE LP**

3a. Address

**1368 SOUTH 1200 EAST VERNAL, UT 84078**

3b. Phone No. (include area code)

**(435) 781-7024**

4. Location of Well (Footage, Sec., T., R., M., or Survey Description)

**SW/NE SEC. 18, T9S, R22E 2009'FNL, 1936'FEL**

5. Lease Serial No.

**UTU-0461**

6. If Indian, Allottee or Tribe Name

**TRIBAL SURFACE**

7. If Unit or CA/Agreement, Name and/or No.

**UNIT #891008900A**

**NATURAL BUTTES UNIT**

8. Well Name and No.

**NBU 922-18G**

9. API Well No.

**4304739371**

10. Field and Pool, or Exploratory Area

**NATURAL BUTTES**

11. County or Parish, State

**UINTAH COUNTY, UTAH**

**12. CHECK APPROPRIATE BOX(ES) TO INDICATE NATURE OF NOTICE, REPORT, OR OTHER DATA**

TYPE OF SUBMISSION	TYPE OF ACTION			
<input type="checkbox"/> Notice of Intent	<input type="checkbox"/> Acidize	<input type="checkbox"/> Deepen	<input type="checkbox"/> Production (Start/Resume)	<input type="checkbox"/> Water Shut-Off
<input checked="" type="checkbox"/> Subsequent Report	<input type="checkbox"/> Alter Casing	<input type="checkbox"/> Fracture Treat	<input type="checkbox"/> Reclamation	<input type="checkbox"/> Well Integrity
<input type="checkbox"/> Final Abandonment Notice	<input type="checkbox"/> Casing Repair	<input type="checkbox"/> New Construction	<input type="checkbox"/> Recomplete	<input checked="" type="checkbox"/> Other <b>PRODUCTION START-UP</b>
	<input type="checkbox"/> Change Plans	<input type="checkbox"/> Plug and Abandon	<input type="checkbox"/> Temporarily Abandon	
	<input type="checkbox"/> Convert to Injection	<input type="checkbox"/> Plug Back	<input type="checkbox"/> Water Disposal	

13. Describe Proposed or Completed Operations (clearly state all pertinent details, including estimated starting date of any proposed work and approximate duration thereof. If the proposal is to deepen directionally or recompleat horizontally, give subsurface locations and measured and true vertical depths of all pertinent markers and zones. Attach the Bond under which the work will be performed or provide the Bond No. on file with BLM/BIA. Required subsequent reports shall be filed within 30 days following completion of the involved operations. If the operation results in a multiple completion or recompleat in a new interval, a Form 3160-4 shall be filed once testing has been completed. Final Abandonment Notices shall be filed only after all requirements, including reclamation, have been completed, and the operator has determined that the site is ready for final inspection.

THE SUBJECT WELL LOCATION WAS PLACED ON PRODUCTION ON 05/01/2008 AT 1:00 PM.

PLEASE REFER TO THE ATTACHED CHRONOLOGICAL WELL HISTORY.

**RECEIVED**

**MAY 08 2008**

**DIV. OF OIL, GAS & MINING**

14. I hereby certify that the foregoing is true and correct

Name (Printed/Typed)

**SHEILA UPCHEGO**

Title

**SENIOR LAND ADMIN SPECIALIST**

Signature

Date

**May 2, 2008**

**THIS SPACE FOR FEDERAL OR STATE USE**

Approved by

Title

Date

Conditions of approval, if any, are attached. Approval of this notice does not warrant or certify that the applicant holds legal or equitable title to those rights in the subject lease which would entitle the applicant to conduct operations thereon.

Office

Title 18 U.S.C. Section 1001, make it a crime for any person knowingly and willfully to make to any department or agency of the United States any false, fictitious or fraudulent statements or representations as to any matter within its jurisdiction.

(Instructions on reverse)

WINS No.: 94985

NBU 922-18G

Start Date: 12/10/2007

AFE No.: 2007733

## Operation Summary Report

End Date: 3/31/2008

Operator KERR-MCGEE OIL & GAS ONSHORE LP	FIELD NAME NATURAL BUTTES	SPUD DATE 12/10/07	GL 4,802	KB 4816	ROUTE
API 4304739371	STATE UTAH	COUNTY UINTAH	DIVISION ROCKIES		
Lat/Long.: Lat/Long.: 40.03774 / -109.48023		Q-Q/Sect/Town/Range: SWNE / 18 / 9S / 22E		Footages: 2,009.00' FNL 1,936.00' FEL	
MTD 9530	TVD 9525	LOG MD	PBMD	PBTVD	

EVENT INFORMATION: EVENT ACTIVITY: DRILLING  
 OBJECTIVE: DEVELOPMENT  
 OBJECTIVE2:  
 REASON:  
 DATE WELL STARTED/RESUMED:  
 Event End Status: COMPLETE

RIG OPERATIONS: Begin Mobilization Rig On Location Rig Charges Rig Operation Start Finish Drilling Rig Release Rig Off Location

ENSIGN 12 / 12 03/18/2008 03/19/2008 03/19/2008 03/20/2008 03/31/2008 03/31/2008 04/01/2008

Date	Time Start-End	Duration (hr)	Phase	Code	Subcode	P/U	Operation
12/10/2007							
SUPERVISOR: LEW WELDON							
	0:00 - 13:30	13.50	DRLCON	12		P	WAIT ON PETE MARTIN BUCKET RIG
	13:30 - 19:30	6.00	DRLCON	02		P	MOVE IN AND RIG UP BUCKET RIG SPUD WELL @ 1330 HR 12/10/07 DRILL AND SET 40' OF SCHEDULE 10 PIPE DRILL RODENT HOLES FOR RIG 12 BLM AND STATE NOTFIED OF SPUD
	19:30 - 0:00	4.50	DRLCON	12		P	WOAR
1/11/2008							
SUPERVISOR: LEW WELDON							
	0:00 - 0:00	24.00	DRLSUR	02		P	MOVE IN AND RIG UP AIR RIG SPUD WELL @ 1630 HR 1/9/08 DRILL TO 2740' NO WATER CONDITION HOLE 1 HR AND PREPAIR TO TRIP
1/12/2008							
SUPERVISOR: LEW WELDON							
	0:00 - 3:00	3.00	DRLSUR	05		P	TRIP DP OUT OF HOLE
	3:00 - 6:00	3.00	DRLSUR	11		P	RUN 2701' OF 9 5/8 CSG AND 200' OF 1" PIPE RIG DOWN AIR RIG AND PREPAIR TO CMT
	6:00 - 7:00	1.00	DRLSUR	15		P	CEMENT 1ST STAGE WITH 250 SKS LEAD @ 11# 3.82 23 GAL/SK AND 200 SKS TAIL @ 15.8# 1.15 5.0 GAL SK GOOD RETURNS THRUOUT JOB + - 20 BBL LEAD CMT TO PIT
	7:00 - 7:30	0.50	DRLSUR	15		P	1ST TOP JOB 80 SKS DOWN 1" PIPE GOOD CMT TO SURFACE AND FELL BACK WOC
	7:30 - 8:30	1.00	DRLSUR	15		P	2ND TOP JOB 65 SKS DOWN BS GOOD CMT TO SURFACE AND STAYED AT SURFACE
	8:30 - 0:00	15.50	DRLSUR	12		P	NO VISIBLE LEAKS PIT 1/4 FULL WORT
3/18/2008							
SUPERVISOR: KENNETH GATHINGS							
	13:00 - 0:00	11.00	DRLPRO	01	E	P	RIG DOWN EQUIPMENT TO MOVE TO THE NBU 922-18G
3/19/2008							
SUPERVISOR: KENNETH GATHINGS							
	0:00 - 7:00	7.00	RDMO	01	E	P	RIG DOWN EQUIPMENT / WAIT ON DAYLIGHT TO MOVE
	7:00 - 17:00	10.00	RDMO	01	A	P	LOAD OUT TRUCKS / MOVE EQUIPMENT APPROX 10.5 MILES TO NEW LOCATION / UNLOAD TRUCKS & SET IN EQUIPMENT
	17:00 - 0:00	7.00	RDMO	01	B	P	RIG UP EQUIPMENT
3/20/2008							
SUPERVISOR: KENNETH GATHINGS							
	0:00 - 15:00	15.00	MIRU	01	B	P	RIG UP ROTARY TOOLS



EVENT INFORMATION:	EVENT ACTIVITY: DRILLING	REASON:
	OBJECTIVE: DEVELOPMENT	DATE WELL STARTED/RESUMED:
	OBJECTIVE2:	Event End Status: COMPLETE

RIG OPERATIONS:	Begin Mobilization	Rig On Location	Rig Charges	Rig Operation Start	Finish Drilling	Rig Release	Rig Off Location
ENSIGN 12 / 12	03/18/2008	03/19/2008	03/19/2008	03/20/2008	03/31/2008	03/31/2008	04/01/2008

Date	Time Start-End	Duration (hr)	Phase	Code	Subcode	P/U	Operation
	15:00 - 21:00	6.00	MIRU	13	C	P	PRESSURE TEST PIPE RAMS, BLIND RAMS, INNER & OUTER BOP VALVES; KILL LINE 7 KILL LINE VALVES; CHOKE LINE & ALL CHOKE MANIFOLD VALVES, UPPER & LOWER KELLY VALVES, DART VALVE & FLOOR VALVE AND SUPER CHOKE TO 5000 PSI @ 10 MIN & 250 PSI @ 5 MIN / TEST ANNULAR TO 2500 PSI @ 10 MIN & 250 PSI @ 5 MIN / TEST SURFACE CASING TO 1500 PSI @ 30 MIN
	21:00 - 0:00	3.00	MIRU	01	D	X	RE-DRILL MOUSE HOLE / OFFSET TO HIGH AND DEPTH TO SHALLOW TO INSTALL SLEEVE

3/21/2008

SUPERVISOR: KENNETH GATHINGS

0:00 - 2:30	2.50	MIRU	01	D	X	RE-DRILL MOUSE HOLE
2:30 - 7:00	4.50	PRPSPD	05	A	P	PREP & PICK UP B.H.A. #1
7:00 - 7:30	0.50	PRPSPD	13	B	P	INSTALL ROTATING RUBBER
7:30 - 10:30	3.00	PRPSPD	02	F	P	DRILL CEMENT + FLOAT EQUIPMENT / TAG CEMENT @ 2570'
10:30 - 11:00	0.50	DRLPRO	02	B	P	DRILL F/ 2740' - T/ 2771' (31' @ 62 fph) 26 vis / 8.4 ppg
11:00 - 11:30	0.50	DRLPRO	09	A	P	WIRELINE SURVEY @ 2695' - .28 DEG
11:30 - 14:00	2.50	DRLPRO	02	B	P	DRILL F/ 2771' - T/ 2991' (220' @ 88 fph) 26 vis / 8.4 ppg
14:00 - 14:30	0.50	DRLPRO	06	A	P	SERVICE RIG & EQUIPMENT / FUNCTION TEST PIPE RAMS
14:30 - 17:00	2.50	DRLPRO	02	B	P	DRILL F/ 2991' - T/ 3273' (282' @ 112.8 fph) 26 VIS / 8.4 ppg
17:00 - 17:30	0.50	DRLPRO	09	A	P	WIRELINE SURVEY @ 3195' - 2.14 DEG
17:30 - 23:00	5.50	DRLPRO	02	B	P	DRILL F/ 3273' - T/ 3775' (502' @ 91.2 fph) 34 vis - 8.6 ppg
23:00 - 23:30	0.50	DRLPRO	09	A	P	WIRELINE SURVEY @ 3700' - 1.78 DEG
23:30 - 0:00	0.50	DRLPRO	02	B	P	DRILL F/ 3775' - T/ 3816' (41' @ 82 fph) 34 vis - 8.6 ppg

3/22/2008

SUPERVISOR: KENNETH GATHINGS

0:00 - 16:30	16.50	DRLPRO	02	B	P	DRILL F/ 3816' - T/ 4781' (965' @ 58.4 fph) 36 vis - 9.0 ppg
16:30 - 17:00	0.50	DRLPRO	06	A	P	SERVICE RIG & EQUIPMENT
17:00 - 17:30	0.50	DRLPRO	09	A	P	WIRELINE SURVEY @ 4700' - 1.85 DEG
17:30 - 0:00	6.50	DRLPRO	02	B	P	DRILL F/ 4781' - T/ 5038' (257' @ 39.5 fph) 37 vis - 9.0 ppg

3/23/2008

SUPERVISOR: KENNETH GATHINGS

0:00 - 14:00	14.00	DRLPRO	02	B	P	DRILL F/ 5038' - T/ 5787' (749' @ 53.5 fph) 41 vis / 9.2 ppg / 3% lcm
14:00 - 14:30	0.50	DRLPRO	06	A	P	SERVICE RIG & EQUIPMENT
14:30 - 0:00	9.50	DRLPRO	02	B	P	DRILL F/ 5787' - T/ 6255' (468' @ 49.2 fph) 44 vis / 9.6 ppg / 5% lcm

3/24/2008

SUPERVISOR: KENNETH GATHINGS

0:00 - 11:00	11.00	DRLPRO	02	B	P	DRILL F/ 6255' - T/ 6664' (409' @ 37.1 fph) 46 vis / 9.7 ppg / 5% lcm
11:00 - 11:30	0.50	DRLPRO	09	A	P	WIRELINE SURVEY @ 6585' - 2.17 DEG
11:30 - 14:30	3.00	DRLPRO	02	B	P	DRILL F/ 6664' - T/ 6758' (94' @ 31.3 fph) 42 vis / 9.8 ppg / 5% lcm
14:30 - 15:00	0.50	DRLPRO	06	A	P	SERVICE RIG & EQUIPMENT
15:00 - 23:00	8.00	DRLPRO	02	B	P	DRILL F/ 6758' - T/ 6884' (126' @ 15.7 fph) 42 vis / 10.0 ppg / 5% lcm
23:00 - 0:00	1.00	DRLPRO	05	A	P	PUMP WEIGHT PILL / P.O.O.H. FOR BIT CHANGE

3/25/2008

SUPERVISOR: KENNETH GATHINGS

0:00 - 2:30	2.50	DRLPRO	05	A	P	P.O.O.H. W/ BIT #1
2:30 - 6:30	4.00	DRLPRO	05	A	P	MAKE UP BIT #2 / T.I.H.
6:30 - 7:00	0.50	DRLPRO	03	D	P	MAKE UP KELLY / FILL DRILL PIPE / WASH & REAM 40' TO BOTTOM

EVENT INFORMATION:	EVENT ACTIVITY: DRILLING	REASON:
	OBJECTIVE: DEVELOPMENT	DATE WELL STARTED/RESUMED:
	OBJECTIVE2:	Event End Status: COMPLETE

RIG OPERATIONS:	Begin Mobilization	Rig On Location	Rig Charges	Rig Operation Start	Finish Drilling	Rig Release	Rig Off Location
-----------------	--------------------	-----------------	-------------	---------------------	-----------------	-------------	------------------

ENSIGN 12 / 12	03/18/2008	03/19/2008	03/19/2008	03/20/2008	03/31/2008	03/31/2008	04/01/2008
----------------	------------	------------	------------	------------	------------	------------	------------

Date	Time Start-End	Duration (hr)	Phase	Code	Subcode	P/U	Operation
	7:00 - 11:30	4.50	DRLPRO	02	B	P	CUT NEW BIT PATTERN / DRILL F/ 6884' - T/ 7041' (157' @ 34.8 fph) 42 vis - 10.1 ppg - 5% lcn
	11:30 - 12:00	0.50	DRLPRO	06	A	P	SERVICE RIG & EQUIPMENT / TEST PIPE RAMS / B.O.P. DRILL
	12:00 - 0:00	12.00	DRLPRO	02	B	P	DRILL F/ 7041' - T/ 7392' (351' @ 29.2 fph) 45 vis - 10.1 ppg - 5% lcn

3/26/2008

SUPERVISOR: BRUCE TAYLOR

0:00 - 13:00	13.00	DRLPRO	02	B	P	DRILL 7392'-7794' (402') 30.9'/HR. 18/22K WOB, 50 ROT. 10.3/46
13:00 - 13:30	0.50	DRLPRO	06	A	P	RIG SERVICE
13:30 - 0:00	10.50	DRLPRO	02	B	P	DRILL 7794'-8000' (206') 19.6'/HR. 20/24K WOB, 40 ROT. 10.4/45

3/27/2008

SUPERVISOR: BRUCE TAYLOR

0:00 - 0:30	0.50	DRLPRO	02	B	P	DRILL 8000'-8013' (13')
0:30 - 1:00	0.50	DRLPRO	06	A	P	SERVICE RIG
1:00 - 12:30	11.50	DRLPRO	02	B	P	DRILL 8013'-8298' (285') 24.7'/HR. 18/22K WOB, 110 BOT RPM. 10.8/46
12:30 - 13:00	0.50	DRLPRO	06	A	P	SERVICE RIG. FUNCTION TEST PIPE RAMS.
13:00 - 0:00	11.00	DRLPRO	02	B	P	DRILL 8298'-8530' (232') 21'/HR. 18/22K WOB, 110 BIT RPM. 11.0/44

3/28/2008

SUPERVISOR: BRUCE TAYLOR

0:00 - 2:00	2.00	DRLPRO	02	B	P	DRILL 8530'-8580' (50') 25'/HR. 18/20K SOB, 110 BIT RPM. 11.1/46
2:00 - 2:30	0.50	DRLPRO	06	A	P	RIG SERVICE, FUNCTION TEST HCR.
2:30 - 11:00	8.50	DRLPRO	02	B	P	DRILL 8580'-8724' (144') 16.9'/HR. 20/24K WOB, 110 BIT RPM. 11.2/46
11:00 - 11:00	0.00	DRLPRO	04	C	P	CIRCUATE BOTTOMS UP. PUMP SLUG, DROP SURVEY.
11:00 - 18:00	7.00	DRLPRO	05	A	P	POOH FOR BIT DUE TO SLOW P-RATE.
18:00 - 23:00	5.00	DRLPRO	05	A	P	MAKE UP NEW Q56 AND TIH WITH SAME.
23:00 - 0:00	1.00	DRLPRO	02	B	P	DRILL 8724'-8750' (26') 26'/HR, 10/12K WOB, 110 BIT RPM, 11.3/46

3/29/2008

SUPERVISOR: BRUCE TAYLOR

0:00 - 4:00	4.00	DRLPRO	02	B	P	DRILL 8750'-8926' (176') 44'/HR. 10/12K WOB, 110 BIT RPM, 11.3/46
4:00 - 4:30	0.50	DRLPRO	06	A	P	SERVICE RIG, FUNCTION TEST PIPE RAMS
4:30 - 12:00	7.50	DRLPRO	02	B	P	DRILL 8926'-9210' (284') 37.8'/HR. 12/17K WOB, 110 BIT RPM, 11.3/46
12:00 - 12:30	0.50	DRLPRO	06	A	P	SERVICE RIG, FUNCTION HCR.
12:30 - 0:00	11.50	DRLPRO	02	B	P	DRILL 9210'-9495' (285') 24.7'/HR. 14/17K WOB, 110 BIT RPM, 11.4/45

3/30/2008

SUPERVISOR: BRUCE TAYLOR

0:00 - 0:30	0.50	DRLPRO	02	B	P	DRILL 9495'-9524' (29')
0:30 - 1:00	0.50	DRLPRO	06	A	P	SERVICE RIG, FUNCTION PIPE RAMS
1:00 - 1:30	0.50	DRLPRO	02	B	P	DRILL 9524'-9530' (6') 12'/HR. 14/17K WOB, 110 BIT RPM, 11.4/45
1:30 - 2:30	1.00	DRLPRO	04	C	P	C/C MUD
2:30 - 4:30	2.00	DRLPRO	05	E	P	SHORT TRIP 20 STANDS.
4:30 - 6:00	1.50	DRLPRO	04	C	P	C/C MUD, TRIP GAS 4270 UNITS. HELD SAFETY MEETING WITH WEATHERFORD, RIG UP LAY DOWN MACHINE.
6:00 - 17:30	11.50	DRLPRO	05	A	P	POOH LAYING DOWN DS., BREAK KELLY, LD BHA.
17:30 - 18:00	0.50	DRLPRO	05	A	P	PULL WEAR BSHING

<b>EVENT INFORMATION:</b>	<b>EVENT ACTIVITY:</b> DRILLING	<b>REASON:</b>
	<b>OBJECTIVE:</b> DEVELOPMENT	<b>DATE WELL STARTED/RESUMED:</b>
	<b>OBJECTIVE2:</b>	<b>Event End Status:</b> COMPLETE

<b>RIG OPERATIONS:</b>	Begin Mobilization	Rig On Location	Rig Charges	Rig Operation Start	Finish Drilling	Rig Release	Rig Off Location
ENSIGN 12 / 12	03/18/2008	03/19/2008	03/19/2008	03/20/2008	03/31/2008	03/31/2008	04/01/2008

Date	Time Start-End	Duration (hr)	Phase	Code	Subco de	P/U	Operation
	18:00 - 0:00	6.00	DRLPRO	08	A	P	HELD SAFETY MEETING WITH HALLIBURTON, RIG UP AND RUN IN HOLE AND LOG WITH QUAD COMBO FROM 9536' TO , RUN GR TO SURFACE.
3/31/2008							
SUPERVISOR: BRUCE TAYLOR							
	0:00 - 1:00	1.00	DRLPRO	08	A	P	FINISH RUNNING LOGS, RD
	1:00 - 2:00	1.00	DRLPRO	11	A	P	HELD SAFETY MEETING WITH WEATHERFORD, RU SAME.
	2:00 - 8:00	6.00	DRLPRO	11	B	P	RUN CSG. AS FOLLOWS: FLOAT SHOE, 1 JT. CSG. FLOAT COLLAR, 107 JTS. CSG. MARKER JT. SET AT 4986', 118 JTS. 4 1/2" 11.6 PPF I-80 CSG. OAL 9517.93', SET AT 9517'. CENTRALIZED WITH 15 BOW SPRINGS, 1 ON FIRST 3 JTS. THEN EVERY 3RD JT.
	8:00 - 11:00	3.00	DRLPRO	04	E	P	CIRCULATE BOTTOMS UP WITH RIG PUMP, HELD SAFETY MEETING WITH HOWCO, RU SAME.
	11:00 - 14:00	3.00	DRLPRO	15	A	P	SWITCH TO HOWCO, TEST LINES TO 4500 CEMENT 4 1/2" AS FOLLOWS: 20 BBLS MUD FLUSH @ 8.3 PPG, 10 BBLS WATER, 20 SKS PL2 SCAVENGER MIXED @ 9.5 PPG, LEAD W/ 445 SKS HALCO LIGHT MIXED @ 11.2 PPG, YIELD 3.0, TAIL W/ 1215 SKS 50:50 POZ MIXED @ 14.3PPG, YIELD 1.27, WASH LINES, DROP PLUG & DISPLACE W/147 BBLS WATER W/ CLAYSTAY & MAGNACIDE TO BUMP PLUG W/ 4000 PSI. RELEASE PSI, FLOATS HELD. HAD 7 BBLS MUD FLUSH BACK TO SURFACE, NO CEMENT.
	14:00 - 15:00	1.00	DRLPRO	11	C	P	WASH STACK, HANG CASING WITH 9OK, TEST HANGER TO 5000 PSI. RD CEMENTERS.
	15:00 - 17:00	2.00	DRLPRO	13	A	P	ND BOP'S. CLEAN PITS.
	17:00 - 18:00	1.00	DRLPRO	06	D	P	SLIP AND CUT DRILL LINE. RELEASE RIG @ 18:00 HRS. 3-31-2008

<b>WINS No.: 94985</b>		<b>NBU 922-18G</b>		<b>Start Date: 4/28/2008</b>			
<b>AFE No.: 2007733</b>		<b>Operation Summary Report</b>		<b>End Date:</b>			
Operator KERR-MCGEE OIL & GAS ONSHORE LP		FIELD NAME NATURAL BUTTES	SPUD DATE 12/10/07	GL 4,802	KB 4816		
API 4304739371		STATE UTAH	COUNTY UINTAH		DIVISION ROCKIES		
Lat./Long.: Lat./Long.: 40.03774 / -109.48023		Q-Q/Sect/Town/Range: SWNE / 18 / 9S / 22E		Footages: 2,009.00' FNL 1,936.00' FEL			
MTD 9530	TVD 9525	LOG MD	PBMD	PBTVD			
<b>EVENT INFORMATION:</b>		EVENT ACTIVITY: COMPLETION OBJECTIVE: DEVELOPMENT OBJECTIVE2: ORIGINAL		REASON: MV DATE WELL STARTED/RESUMED: Event End Status:			
<b>RIG OPERATIONS:</b>		Begin Mobilization Rig On Location Rig Charges Rig Operation Start Finish Drilling Rig Release Rig Off Location					
MILES 2 / 2		04/28/2008					
Date	Time Start-End	Duration (hr)	Phase	Code	Subco de	P/U	Operation
4/28/2008							
SUPERVISOR: GARTH McCONKIE							
	7:00 - 7:15	0.25	COMP	48		P	DAY 1 - JSA & SM #1
	7:15 - 8:15	1.00	COMP	30	A	P	MIRU SERVICE UNIT.
	8:15 - 13:15	5.00	COMP	31	I	P	PU 3 7/8" MILL, STRAP & PU OFF OF FLOAT 274 JTS NEW 2 3/8" J55 TBG & RIH. EOT @ 8600'.
	13:15 - 15:15	2.00	COMP	31	I	P	POOH W/137 STDS TBG & STD BK IN DERRICK. LD MILL. NDBOP & NU FRAC VALVE.
	15:15 - 15:15	0.00	COMP	33	C	P	MIRU B&C QUICK TEST. PT CSG & FRAC VALVES TO 7500 PSI (GOOD TEST). RDMO B&C QUICK TEST.
	15:15 - 15:15	0.00	COMP	46		P	16:00 SWL. WHP = 0 PSI. SDFN. PREP WELL TO FRAC W/BJ IN AM.
4/29/2008							
SUPERVISOR: GARTH McCONKIE							
	6:30 - 7:00	0.50	COMP	48		P	DAY 2 - JSA & SM #2 WHP = 0 PSI, MIRU CUTTERS WIRELINE & BJ SERVICES.

<b>Wins No.: 94985</b>		<b>NBU 922-18G</b>		<b>API No.: 4304739371</b>	
<b>EVENT INFORMATION:</b>		EVENT ACTIVITY: COMPLETION		REASON: MV	
		OBJECTIVE: DEVELOPMENT		DATE WELL STARTED/RESUMED:	
		OBJECTIVE2: ORIGINAL		Event End Status:	
<b>RIG OPERATIONS:</b>		Begin Mobilization		Rig On Location	Rig Charges
		Rig Operation Start		Finish Drilling	Rig Release
		Rig Off Location			
<b>MILES 2 / 2</b>		<b>04/28/2008</b>			
<b>Date</b>	<b>Time Start-End</b>	<b>Duration (hr)</b>	<b>Phase</b>	<b>Code</b>	<b>Subcode</b>
					<b>P/U</b>
					<b>Operation</b>
	7:00 - 15:30	8.50	COMP	37	B
					P
					STG 1) RIH W/3 3/8" EXP GNS, 23 GRM, 0.36 HOLES, 90 & 120 DEG PHSG. PERF THE M.V. @ 9334' - 36', 4 SPF, 9224' - 28', 4 SPF, 9147' - 50', 4 SPF, 9076' - 78', 3 SPF, 42 HOLES.
					WHP = 194 PSI, BRK 1.5 BPM @ 3873 PSI, ISIP = 2950 PSI, FG = 0.77. PMP 100 BBLS W/10/1000 SCALE INHIB. PMP 100 BBLS 50 BPM @ 5800 PSI. 42/42 PERFS OPEN. SCREENED OUT (7600 PSI) W/60,200 LBS SAND IN FORMATION. (1170 LBS IN CSG) FLOW WELL BACK BTMS UP. RE FLUSH (ADD 2 BBL HCL) @ 8.7 BPM @ 3943 PSI. MP 6875 PSI, MR 52.2 BPM, AP 5857 PSI, AR 51.3 BPM, ISIP = 2990 PSI, FG = 0.77. NPI = 40 PSI. PMP 1697 BBLS SLK WTR. 61364 LBS TOTAL SAND. (3523 LBS TLC @ END).
					STG 2) RIH W/3 3/8" EXP GNS, 23 GRM, 0.36 HOLES, 90 DEG PHSG. PERF THE M.V. @ 8610' - 16', 4 SPF, 8466' - 70', 40 HOLES.
					WHP = 252 PSI, BRK 4.5 BPM @ 5163 PSI, ISIP = 2710 PSI, FG = 0.76. PMP 200 BBLS 52.3 BPM @ 5800 PSI. 31/42 PERFS OPEN. MP 6820 PSI, MR 53.4 BPM, AP 5593 PSI, AR 51.9 BPM, ISIP = 2615 PSI, FG = 0.75. NPI = (-95) PSI. PMP 1613 BBLS SLK WTR. 57813 LBS TOTAL SAND. (5341 LBS TLC @ END).
					STG 3) RIH W/3 3/8" EXP GNS, 23 GRM, 0.36 HOLES, 90 DEG PHSG. PERF THE M.V. @ 8315' - 20', 4 SPF, 8180' - 85', 4 SPF, 42 HOLES.
					WHP = 163 PSI, BRK 4.7 BPM @ 7540 PSI, ISIP = 2730 PSI, FG = 0.80. PMP 100 BBLS 53 BPM @ 6000 PSI. 31/40 PERFS OPEN. MP 5469 PSI, MR 54 BPM, AP 4845 PSI, AR 52.2 BPM, ISIP = 2730 PSI, FG = 0.78. NPI = (-170) PSI. PMP 1051 BBLS SLK WTR. 35,994 LBS TOTAL SAND. (5633 LBS TLC @ END).
					STG 4) RIH W/3 3/8" EXP GNS, 23 GRM, 0.36 HOLES, 90 & 120 DEG PHSG. PERF THE M.V. @ 8060' - 63', 4 SPF, 8010' - 14', 4 SPF, 7967' - 70', 3 SPF, 7938' - 40', 3 SPF, 43 HOLES.
					WHP = 186 PSI, BRK 2.8 BPM @ 4820 PSI, ISIP = 2390 PSI, FG = 0.74. PMP 100 BBLS 49 BPM @ 4900 PSI. 43/43 PERFS OPEN. MP 5075 PSI, MR 50.6 BPM, AP 4654 PSI, AR 50.3 BPM, ISIP = 2800 PSI, FG = 0.79. NPI = 410 PSI. PMP 1125 BBLS SLK WTR. 37734 LBS TOTAL SAND. (3156 LBS TLC @ END).
					KILL PLUG) RIH W/BAKER 8K CBP & SET @ 7888'. POOH W/GNS.
	15:30 - 17:00	1.50	COMP	30	F
					P
					RDMO CUTTERS WIRELINE & BJ SERVICES.
					ND FRAC VALVES, NUBOP.
					17:00 SWI - SDFN. PREP WELL TO DRLG PLUGS IN AM.
<b>4/30/2008</b>					
<b>SUPERVISOR: GARTH McCONKIE</b>					
	7:00 - 7:15	0.25	COMP	48	P
					DAY 3 - JSA & SM #3

EVENT INFORMATION:	EVENT ACTIVITY: COMPLETION	REASON: MV
	OBJECTIVE: DEVELOPMENT	DATE WELL STARTED/RESUMED:
	OBJECTIVE2: ORIGINAL	Event End Status:

RIG OPERATIONS:	Begin Mobilization	Rig On Location	Rig Charges	Rig Operation Start	Finish Drilling	Rig Release	Rig Off Location
-----------------	--------------------	-----------------	-------------	---------------------	-----------------	-------------	------------------

MILES 2 / 2 04/28/2008

Date	Time Start-End	Duration (hr)	Phase	Code	Subco de	P/U	Operation
	7:15 - 7:15	0.00	COMP	44	C	P	<p>P/U 3 7/8" BIT, POBS &amp; XN NIPPLE. RIH ON NEW 2 3/8" J55 TBG. TAG CBP #1 @ 7888'. R/U PWR SWVL &amp; PMP. P.T. BOP TO 3000 PSI. EST. CIRC W/2% KCL WTR.</p> <p>CBP #1) DRLG OUT BAKER 8K CBP @ 7888' IN 10 MIN. 500 LBS DIFF. RIH TAG SND @ 8028'. C/O 65' SND. FCP = 150 PSI.</p> <p>CBP #2) DRLG OUT BAKER 8K CBP @ 8093' IN 10 MIN. 600 LBS DIFF. RIH TAG SND @ 8320'. C/O 30' SND. FCP = 250 PSI.</p> <p>CBP #3) DRLG OUT BAKER 8K CBP @ 8350' IN 10 MIN. 500 LBS DIFF. RIH TAG SND @ 8616'. C/O 30' SND. FCP = 300 PSI.</p> <p>CBP #4) DRLG OUT BAKER 8K CBP @ 8646' IN 10 MIN. 700 LBS DIFF. RIH TAG SND @ 9336'. C/O 138' SND. TO PBTD @ 9474'. FCP = 300 PSI. CIRC WELL CLEAN W/2% KCL WTR.</p> <p>R/D PWR SWVL. POOH &amp; L/D 35 JTS TBG ON FLOAT (42 JTS TOTAL ON FLOAT). LAND TBG ON HANGER W/267 JTS. EOT @ 8380.72'. POBS &amp; XN NIPPLE @ 8397.75'. AVG 10 MIN/PLUG. C/O 263' OF SND.</p> <p>NDBOP, DROP BALL, NUWH. PMP OFF BIT W/2200 PSI. WAIT 30 MIN FOR BIT TO FALL TO BTM. OPEN WELL TO PIT ON 48 CHOKE. FTP = 100 PSI. SICP = 1850 PSI.</p> <p>15:30 TURN WELL OVER TO FBC.</p> <p>LTR = 4121 BBLS.</p>

5/1/2008

SUPERVISOR: DON DEHERERRA

7:00 -

33 A

7 AM REPORT: CP 1650#, TP 1700#, 20/64" CK, 40 BWPH, TRACE SAND, LIGHT GAS  
TTL BBLS RECOVERED: 2375  
BBLS LEFT TO RECOVER: 3241

13:00 -

PROD

WELL TURNED TO SALES @ 1300 HRS ON 05/01/2008 - FTP 1725#, CP 1900#, 20/64" CK, 1200 MCFD, 960 BWPD

(See instructions and spaces for additional data on reverse side)

## 28b. Production - Interval C

Date First Produced	Test Date	Hours Tested	Test Production →	Oil BBL	Gas MCF	Water BBL	Oil Gravity Corr. API	Gas Gravity	Production Method
Choke Size	Tbg. Press. Flwg. SI	Csg. Press.	24 Hr. Rate →	Oil BBL	Gas MCF	Water BBL	Gas : Oil Ratio	Well Status	

## 28c. Production - Interval D

Date First Produced	Test Date	Hours Tested	Test Production →	Oil BBL	Gas MCF	Water BBL	Oil Gravity Corr. API	Gas Gravity	Production Method
Choke Size	Tbg. Press. Flwg. SI	Csg. Press.	24 Hr. Rate →	Oil BBL	Gas MCF	Water BBL	Gas : Oil Ratio	Well Status	

29. Disposition of Gas (*Sold, used for fuel, vented, etc.*)**SOLD**

## 30. Summary of Porous Zones (Include Aquifers):

Show all important zones of porosity and contents thereof: Cored intervals and all drill-stem tests, including depth interval tested, cushion used, time tool open, flowing and shut-in pressures and recoveries.

## 31. Formation (Log) Markers

Formation	Top	Bottom	Descriptions, Contents, etc.	Name	Top Meas. Depth
WASATCH MESAVERDE	4960' 7701'	7701'			

## 32. Additional remarks (include plugging procedure):

## 33. Circle enclosed attachments:

1. Electrical/Mechanical Logs (1 full set req'd.)      2. Geologic Report      3. DST Report      4. Directional Survey  
5. Sundry Notice for plugging and cement verification      5. Core Analysis      7. Other:

36. I hereby certify that the foregoing and attached information is complete and correct as determined from all available records (see attached instructions)\*

Name (please print) SHEILA UPCHEGOTitle SENIOR LAND ADMIN SPECIALISTSignature Date 05/29/08

Title 18 U.S.C. Section 1001 and Title 43 U.S.C. Section 1212, make it a crime for any person knowingly and willfully to make to any department or agency of the United States any false, fictitious or fraudulent statements or representations as to any matter within its jurisdiction.



UNITED STATES  
DEPARTMENT OF THE INTERIOR  
BUREAU OF LAND MANAGEMENT

FORM APPROVED  
OMB No. 1004-0137  
Expires: July 31, 2010

**SUNDRY NOTICES AND REPORTS ON WELLS**  
*Do not use this form for proposals to drill or to re-enter an abandoned well. Use Form 3160-3 (APD) for such proposals.*

5. Lease Serial No.  
UTU-0461

6. If Indian, Allottee or Tribe Name

TRIBAL SURFACE

**SUBMIT IN TRIPLICATE** - Other instructions on page 2.

1. Type of Well

☐ Oil Well ☒ Gas Well ☐ Other

2. Name of Operator  
KERR MCGEE OIL & GAS ONSHORE LP

3a. Address  
1368 SOUTH 1200 EAST VERNAL, UTAH 84078

3b. Phone No. (include area code)  
435.781.7024

7. If Unit of CA/Agreement, Name and/or No.  
UNIT #891008900A

8. Well Name and No.  
NBU 922-18G

9. API Well No.  
4304739371

10. Field and Pool or Exploratory Area  
NATURAL BUTTES

4. Location of Well (Footage, Sec., T., R., M., or Survey Description)  
SW/NE SEC. 18, T9S, R22E 2009FNL, 1936FEL

11. Country or Parish, State  
UINTAH COUNTY, UTAH

**12. CHECK THE APPROPRIATE BOX(ES) TO INDICATE NATURE OF NOTICE, REPORT OR OTHER DATA**

TYPE OF SUBMISSION	TYPE OF ACTION			
<input checked="" type="checkbox"/> Notice of Intent	<input type="checkbox"/> Acidize	<input type="checkbox"/> Deepen	<input type="checkbox"/> Production (Start/Resume)	<input type="checkbox"/> Water Shut-Off
<input type="checkbox"/> Subsequent Report	<input type="checkbox"/> Alter Casing	<input type="checkbox"/> Fracture Treat	<input type="checkbox"/> Reclamation	<input type="checkbox"/> Well Integrity
<input type="checkbox"/> Final Abandonment Notice	<input type="checkbox"/> Casing Repair	<input type="checkbox"/> New Construction	<input checked="" type="checkbox"/> Recomplete	<input type="checkbox"/> Other _____
	<input type="checkbox"/> Change Plans	<input type="checkbox"/> Plug and Abandon	<input type="checkbox"/> Temporarily Abandon	
	<input type="checkbox"/> Convert to Injection	<input type="checkbox"/> Plug Back	<input type="checkbox"/> Water Disposal	

13. Describe Proposed or Completed Operation: Clearly state all pertinent details, including estimated starting date of any proposed work and approximate duration thereof. If the proposal is to deepen directionally or recompletable horizontally, give subsurface locations and measured and true vertical depths of all pertinent markers and zones. Attach the Bond under which the work will be performed or provide the Bond No. on file with BLM/BIA. Required subsequent reports must be filed within 30 days following completion of the involved operations. If the operation results in a multiple completion or recompletable in a new interval, a Form 3160-4 must be filed once testing has been completed. Final Abandonment Notices must be filed only after all requirements, including reclamation, have been completed and the operator has determined that the site is ready for final inspection.)

THE OPERATOR REQUESTS AUTHORIZATION TO RECOMPLETE THE SUBJECT WELL LOCATION. THE OPERATOR PROPOSES TO COMPLETE THE WASATCH AND MESAVERDE FORMATIONS. THE OPERATOR WILL COMMINGLE THE NEWLY WASATCH AND MESAVERDE FORMATION, ALONG WITH THE EXISTING MESAVERDE FORMATIONS.

PLEASE REFER TO THE ATTACHED RECOMPLETION PROCEDURE.

**COPY SENT TO OPERATOR**

Date: 2.24.2009

Initials: KS

14. I hereby certify that the foregoing is true and correct.

Name (Printed/Typed)  
SHEILA UPCHEGO

Title REGULATORY ANALYST

Signature

Date 02/02/2009

**THIS SPACE FOR FEDERAL OR STATE OFFICE USE**

Approved by

Title

Pet. Eng.

Date

2/17/09

Conditions of approval, if any, are attached. Approval of this notice does not warrant or certify that the applicant holds legal or equitable title to those rights in the subject lease which would entitle the applicant to conduct operations thereon.

Office

Docum

Federal Approval Of This  
Action Is Necessary

Title 18 U.S.C. Section 1001 and Title 43 U.S.C. Section 1212, make it a crime for any person knowingly and willfully to make to any department or agency of the United States any false, fictitious or fraudulent statements or representations as to any matter within its jurisdiction.

(Instructions on page 2)

\* Cause 173-14

**RECEIVED**

**FEB 04 2009**

**DIV. OF OIL, GAS & MINING**

**Name:** NBU 922-18G  
**Location:** SW/NE Sec 18, T9S, R22E  
**Uintah County, UT**  
**Date:** 1/15/2009

**ELEVATIONS:** 4802 GL 4816 KB

**TOTAL DEPTH:** 9530 **PBTD:** 9474  
**SURFACE CASING:** 9 5/8", 36# J-55 ST&C @ 2723'  
**PRODUCTION CASING:** 4 1/2", 11.6#, I-80 LT&C @ 9519'  
 Marker Joint 4987 - 5003'

**TUBULAR PROPERTIES:**

	BURST (psi)	COLLAPSE (psi)	DRIFT DIA. (in.)	CAPACITIES	
				(bbl/ft)	(gal/ft)
2 3/8" 4.7# J-55 tbg	7,700	8,100	1.901"	0.00387	0.1624
4 1/2" 11.6# I-80 (See above)	7780	6350	3.875"	0.0155	0.6528
2 3/8" by 4 1/2" Annulus				0.0101	0.4227

**TOPS:**

1720' Green River  
 1999' Bird's Nest  
 2353' Mahogany  
 4962' Wasatch  
 7644' Mesaverde  
 Estimated T.O.C. from CBL @ 4100'

**GENERAL:**

- A minimum of 13 tanks (cleaned lined 500 bbl) of recycled water will be required. Note: Use biocide in tanks and the water needs to be at least 45°F at pump time.
- All perforation depths are from Halliburtons Induction-Density-Neutron log dated 3/30/08
- 4 fracturing stages required for coverage.
- Procedure calls for 5 CBP's (8000 psi).
- Calculate open perforations after each breakdown. If less than 60% of the perforations appear to be open, ball out with 15% HCl.
- Put scale inhibitor 3 gals/1000 gals (in pad and 1/2 the ramp) and 10 gals/1000 gals in all flushes except the final stage. Remember to pre-load the casing with scale inhibitor for the very first stage with 10 gpt.
- 30/50 mesh Ottawa sand, **Slickwater frac.**
- Maximum surface pressure **6200 psi.**
- Flush volumes are the sum of slick water and acid used during displacement (include scale inhibitor as mentioned above). **DO NOT OVERDISPLACE.** Stage acid and scale inhibitor if necessary to cover the next perforated interval.

- Service companies need to provide surface/production annulus pop-offs to be set for 1500 psi for each frac.
- Pump 20/40mesh **resin coated sand** last 5,000# of all frac stages
- Tubing Currently Landed @~8398
- Originally completed on 5/1/08

### Existing Perforations:

#### PERFORATIONS

<u>Formation (Bench)</u>	<u>Top</u>	<u>Btm</u>	<u>spf</u>	<u>Shots</u>	<u>Date</u>	<u>Reason</u>	<u>Comments</u>
MESA VERDE	7938	7940	3	6	04/29/2008	PRODUCTION	STG 4
MESA VERDE	7967	7970	3	9	04/29/2008	PRODUCTION	STG 4
MESA VERDE	8010	8014	4	16	04/29/2008	PRODUCTION	STG 4
MESA VERDE	8060	8063	4	12	04/29/2008	PRODUCTION	STG 4
MESA VERDE	8180	8185	4	20	04/29/2008	PRODUCTION	STG 3
MESA VERDE	8315	8320	4	20	04/29/2008	PRODUCTION	STG 3
MESA VERDE	8466	8470	4	16	04/29/2008	PRODUCTION	STG 2
MESA VERDE	8610	8616	4	24	04/29/2008	PRODUCTION	STG 2
MESA VERDE	9076	9078	3	6	04/29/2008	PRODUCTION	STG 1
MESA VERDE	9147	9150	4	12	04/29/2008	PRODUCTION	STG 1
MESA VERDE	9224	9228	4	16	04/29/2008	PRODUCTION	STG 1
MESA VERDE	9334	9336	4	8	04/29/2008	PRODUCTION	STG 1

### PROCEDURE:

1. MIRU. Control well with recycled water and biocide as required. ND WH, NU BOP's and test.
2. TOOH with 2-3/8", 4.7#, J-55 (or N-80) tubing (currently landed at ~8398'). Visually inspect for scale and consider replacing if needed.
3. If tubing looks ok consider running a gauge ring to 7879 (50' below proposed CBP). Otherwise P/U a mill and C/O to 7879 (50' below proposed CBP).
4. Set 8000 psi CBP at ~7829'. Pressure test BOP and casing to 6000 psi.

5. Perf the following with 3-3/8" gun, 23 gm, 0.36"hole:

Zone	From	To	spf	# of shots
WASATCH	7686	7688	4	8
MESAVERDE	7704	7706	4	8
MESAVERDE	7722	7724	4	8
MESAVERDE	7783	7785	4	8
MESAVERDE	7797	7799	4	8
# of Perfs/stage				40

6. Breakdown perfs and establish injection rate (include scale inhibitor in fluid). Spot 250 gals of 15% HCL and let soak 5-10 min. Fracture as outlined in Stage 1 on attached listing. Under-displace to ~7636' and trickle 250gal 15%HCL w/ scale inhibitor in flush.
7. Set 8000 psi CBP at ~7276'. Perf the following 3-3/8" gun, 23 gm, 0.36"hole:

Zone	From	To	spf	# of shots
WASATCH	7060	7063	4	12
WASATCH	7116	7120	4	16
WASATCH	7243	7246	4	12
# of Perfs/stage				40

8. Breakdown perfs and establish injection rate. Fracture as outlined in Stage 2 on attached listing. Under-displace to ~7010' and trickle 250gal 15%HCL w/ scale inhibitor in flush.

9. Set 8000 psi CBP at ~6471'. Perf the following with 3-3/8" gun, 23 gm, 0.36" hole:

Zone	From	To	spf	# of shots
WASATCH	6378	6382	4	16
WASATCH	6423	6425	4	8
WASATCH	6430	6432	4	8
WASATCH	6439	6441	4	8
# of Perfs/stage				40

10. Breakdown perfs and establish injection rate. Fracture as outlined in Stage 3 on attached listing. Under-displace to ~6328' and trickle 250gal 15%HCL w/ scale inhibitor in flush.

11. Set 8000 psi CBP at ~5545'. Perf the following with 3-3/8" gun, 23 gm, 0.36" hole:

Zone	From	To	spf	# of shots
WASATCH	5333	5338	4	20
WASATCH	5510	5515	4	20
# of Perfs/stage				40

12. Breakdown perfs and establish injection rate. Fracture as outlined in Stage 4 on attached listing. Under-displace to ~5283' and flush only with recycled water.

13. Set 8000 psi CBP at ~5283'.

14. TIH with 3 7/8" mill, pump off sub, SN and tubing.

15. Mill ALL plugs and clean out to PBTD at 9474'. Land tubing at ±8436" pump off bit and bit sub. This well WILL be commingled at this time.

16. Clean out well with foam and/or swabbing unit until steady flow has been established from recomplete.

17. RDMO

**For design questions, please call**  
**Lisa Weber, Denver, CO**  
**(303)-242-6031 (Cell)**  
**(720)-946-2545 (Office)**

For field implementation questions, please call  
Robert Miller, Vernal, UT  
4350781 7041 (Office)

NOTES:

NBU 922-18G  
Perforation and CBP Summary

Stage	Zones	Perforations		SPF	Holes	Fracture Coverage		
		Top, ft	Bottom, ft					
1	WASATCH	7686	7688	4	8	7686	to	7688
	MESAVERDE	7704	7706	4	8	7689	to	7692
	MESAVERDE	7722	7724	4	8	7701	to	7710
	MESAVERDE	7783	7785	4	8	7711	to	7720
	MESAVERDE	7797	7799	4	8	7721	to	7728
	MESAVERDE		No Perfs			7783	to	7784
	MESAVERDE		No Perfs			7785	to	7787
	MESAVERDE		No Perfs			7795	to	7797
	# of Perfs/stage				40	CBP DEPTH	7,276	
2	WASATCH	7060	7063	4	12	7062	to	7063
	WASATCH	7116	7120	4	16	7116	to	7119
	WASATCH	7243	7246	4	12	7244	to	7247
	# of Perfs/stage				40	CBP DEPTH	6,471	
3	WASATCH	6378	6382	4	16	6378	to	6383
	WASATCH	6423	6425	4	8	6424	to	6426
	WASATCH	6430	6432	4	8	6430	to	6433
	WASATCH	6439	6441	4	8	6440	to	6441
	# of Perfs/stage				40	CBP DEPTH	5,545	
4	WASATCH	5333	5338	4	20	5327	to	5349
	WASATCH	5510	5515	4	20	5502	to	5508
	WASATCH		No Perfs			5510	to	5517
	# of Perfs/stage				40	CBP DEPTH	5,283	
Totals					160			

Fracturing Schedules  
NBU922-18G  
Slickwater Frac

4099 7764  
9° 613' 7" 14

Stage	Zone	Feet of Pay	Perfs Top, ft. Bot, ft.	SPF	Holes	Rate BPM	Fluid Type	Initial ppg	Final ppg	Fluid	Volume gals	Cum Vol gals	Volume BBLs	Cum Vol BBLs	Fluid % of frac	Sand % of frac	Sand lbs	Cum. Sand lbs	Footage from CBP to Flesh	Scale Inhib., gal.
1	WASATCH	2	7686 7686	4	8	Varied	Pump-in test			Sickwater		0	0	0						
	MESAVERDE	3	7704 7706	4	8	0	ISP and 5 min ISP													47
	MESAVERDE	9	7722 7724	4	8	50	Sickwater Pad			Sickwater	13,125	13,125	313	313	15.0%	0.0%	0	0		39
	MESAVERDE	9	7783 7785	4	8	50	Sickwater Ramp	0.25	1.25	Sickwater	43,750	56,875	1,042	1,354	50.0%	39.7%	32,813	32,813		66
	MESAVERDE	7	7797 7799	4	8	50	Sickwater Ramp	1.25	2	Sickwater	30,625	87,500	729	2,083	35.0%	60.3%	49,766	82,578		0
	MESAVERDE	1	No Perfs			50	Flush (4-1/2")				4,985	92,485	119	2,202				82,578		47
	MESAVERDE	2	No Perfs				ISDP and 5 min ISDP													200
	MESAVERDE	2	No Perfs									92,485								
		35	# of Perfs/stage	40		45.9	<< Above pump time (min)								Flush depth	7636	gal/ft CBP depth	2,500 7,276	2,369 360	lbs sand/ft
2	WASATCH	1	7060 7063	4	12	Varied	Pump-in test			Sickwater		0	0	0						
	WASATCH	3	7116 7120	4	16	0	ISP and 5 min ISP													9
	WASATCH	3	7243 7246	4	12	50	Sickwater Pad			Sickwater	2,888	2,888	69	69	15.0%	0.0%	0	0		14
	WASATCH	0				50	Sickwater Ramp	0.25	1.25	Sickwater	9,625	12,513	229	299	50.0%	39.7%	7,219	7,219		0
	WASATCH	0				50	Sickwater Ramp	1.25	2	Sickwater	6,738	19,250	180	458	35.0%	60.3%	10,948	16,167		42
	WASATCH	0				50	Flush (4-1/2")				4,576	23,826	109	567				16,167		65
	WASATCH	0					ISDP and 5 min ISDP					23,826								
	WASATCH	0										23,826								
	WASATCH	0																		
		7	# of Perfs/stage	40		11.8	<< Above pump time (min)								Flush depth	7010	gal/ft CBP depth	2,750 6,471	2,695 539	lbs sand/ft
3	WASATCH	5	6378 6382	4	16	Varied	Pump-in test			Sickwater		0	0	0						
	WASATCH	2	6423 6425	4	8	0	ISP and 5 min ISP													10
	WASATCH	3	6430 6432	4	8	50	Sickwater Pad			Sickwater	3,300	3,300	79	79	15.0%	0.0%	0	0		17
	WASATCH	1	6439 6441	4	8	50	Sickwater Ramp	0.25	1.25	Sickwater	11,000	14,300	262	340	50.0%	39.7%	8,250	8,250		0
	WASATCH	0				50	Sickwater Ramp	1.25	2	Sickwater	7,700	22,000	183	524	35.0%	60.3%	12,513	20,763		36
	WASATCH	0				50	Flush (4-1/2")				4,131	26,131	98	622				20,763		62
	WASATCH	0					ISDP and 5 min ISDP					26,131								
	WASATCH	0										26,131								
	WASATCH	0																		
		11	# of Perfs/stage	40		12.9	<< Above pump time (min)								Flush depth	6328	gal/ft CBP depth	2,000 5,645	1,888 283	lbs sand/ft
4	WASATCH	22	5333 5338	4	20	Varied	Pump-in test			Sickwater		0	0	0						
	WASATCH	6	5510 5515	4	20	0	ISP and 5 min ISP													32
	WASATCH	7	No Perfs			50	Sickwater Pad			Sickwater	10,500	10,500	250	250	15.0%	0.0%	0	0		53
	WASATCH	0				50	Sickwater Ramp	0.25	1.25	Sickwater	35,000	45,500	833	1,083	50.0%	39.7%	26,250	26,250		0
	WASATCH	0				50	Sickwater Ramp	1.25	2	Sickwater	24,500	70,000	583	1,667	35.0%	60.3%	39,813	66,063		0
	WASATCH	0				50	Flush (4-1/2")				3,449	73,449	82	1,749				66,063		84
	WASATCH	0					ISDP and 5 min ISDP													
	WASATCH	0										73,449								
		35	# of Perfs/stage	40		36.5	<< Above pump time (min)								Flush depth	5283	gal/ft CBP depth	2,000 5,283	1,888 0	lbs sand/ft LOOK
Totals		88			160						Total Fluid	215,891 gals 6,140 bbls			5,140 bbls		Total Sand	187,670		411
						1.8									11.4 tanks			Total Scale Inhib. =		

Fracturing Schedules  
 NBU 922-18G  
 Slickwater Frac

4099.7784  
 97.6137714

Stage	Zone	Feet of Pay	Perfs		SPF	Holes	Rate BPM	Fluid Type	Initial ppg	Final ppg	Fluid	Volume gals	Cum Vol gals	Volume BBLs	Cum Vol BBLs	Fluid % of frac	Sand % of frac	Sand lbs	Cum. Sand lbs	Footage from CBP to Flush	Scale Inhib., gal.
1	WASATCH	2	7686	7688	4	8	Varied	Pump-in test			Slickwater		0	0	0						
	MESAVERDE	3	7704	7706	4	8	0	ISIP and 5 min ISIP													47
	MESAVERDE	9	7722	7724	4	8	50	Slickwater Pad			Slickwater	13,125	13,125	313	313	15.0%	0.0%	0	0		39
	MESAVERDE	9	7783	7785	4	8	50	Slickwater Ramp	0.25	1.25	Slickwater	43,750	56,875	1,042	1,354	50.0%	39.7%	32,813	32,813		66
	MESAVERDE	7	7797	7799	4	8	50	Slickwater Ramp	1.25	2	Slickwater	30,625	87,500	729	2,083	35.0%	60.3%	49,766	82,578		0
	MESAVERDE	1	No Perfs				50	Flush (4-1/2")				4,985	92,485	119	2,202				82,578		47
	MESAVERDE	2	No Perfs					ISDP and 5 min ISDP													200
	MESAVERDE	2	No Perfs									92,485									
		35	# of Perfs/stage			40	45.9	<< Above pump time (min)								Flush depth	7636	gal/ft CBP depth	2,500 7,276	2,359 lbs sand/ft	360
2	WASATCH	1	7060	7063	4	12	Varied	Pump-in test			Slickwater		0	0	0						
	WASATCH	3	7116	7120	4	16	0	ISIP and 5 min ISIP													9
	WASATCH	3	7243	7246	4	12	50	Slickwater Pad			Slickwater	2,888	2,888	69	69	15.0%	0.0%	0	0		14
	WASATCH	0					50	Slickwater Ramp	0.25	1.25	Slickwater	9,625	12,513	229	298	50.0%	39.7%	7,219	7,219		0
	WASATCH	0					50	Slickwater Ramp	1.25	2	Slickwater	6,738	19,250	160	458	35.0%	60.3%	10,948	18,167		42
	WASATCH	0					50	Flush (4-1/2")				4,576	23,826	109	567				18,167		65
	WASATCH	0						ISDP and 5 min ISDP					23,826								
	WASATCH	0										23,826									
	WASATCH	0											23,826								
		7	# of Perfs/stage			40	11.8	<< Above pump time (min)								Flush depth	7010	gal/ft CBP depth	2,750 6,471	2,595 lbs sand/ft	539
3	WASATCH	5	6378	6382	4	16	Varied	Pump-in test			Slickwater		0	0	0						
	WASATCH	2	6423	6425	4	8	0	ISIP and 5 min ISIP													10
	WASATCH	3	6430	6432	4	8	50	Slickwater Pad			Slickwater	3,300	3,300	79	79	15.0%	0.0%	0	0		17
	WASATCH	1	6439	6441	4	8	50	Slickwater Ramp	0.25	1.25	Slickwater	11,000	14,300	262	340	50.0%	39.7%	8,250	8,250		0
	WASATCH	0					50	Slickwater Ramp	1.25	2	Slickwater	7,700	22,000	183	524	35.0%	60.3%	12,513	20,763		36
	WASATCH	0					50	Flush (4-1/2")				4,131	26,131	98	622				20,763		62
	WASATCH	0						ISDP and 5 min ISDP					26,131								
	WASATCH	0										26,131									
		11	# of Perfs/stage			40	12.9	<< Above pump time (min)								Flush depth	6328	gal/ft CBP depth	2,000 5,545	1,888 lbs sand/ft	783
4	WASATCH	22	5333	5338	4	20	Varied	Pump-in test			Slickwater		0	0	0						
	WASATCH	6	5510	5515	4	20	0	ISIP and 5 min ISIP													32
	WASATCH	7	No Perfs				50	Slickwater Pad			Slickwater	10,500	10,500	250	250	15.0%	0.0%	0	0		53
	WASATCH	0					50	Slickwater Ramp	0.25	1.25	Slickwater	35,000	45,500	833	1,083	50.0%	39.7%	26,250	26,250		0
	WASATCH	0					50	Slickwater Ramp	1.25	2	Slickwater	24,500	70,000	583	1,667	35.0%	60.3%	39,813	66,063		0
	WASATCH	0					50	Flush (4-1/2")				3,449	73,449	82	1,749				66,063		84
	WASATCH	0						ISDP and 5 min ISDP					73,449								
	WASATCH	0											73,449								
		35	# of Perfs/stage			40	36.5	<< Above pump time (min)								Flush depth	5283	gal/ft CBP depth	2,000 5,283	1,888 lbs sand/ft	0
	Totals	88	# of Perfs/stage			160	1.8	<< Above pump time (min)				Total Fluid	215,891 5,140	gals bbls		5,140 bbls		Total Sand	187,570		LOOK
			# of Perfs/stage													11.4	tanks		Total Scale Inhib. =		411

UNITED STATES  
DEPARTMENT OF THE INTERIOR  
BUREAU OF LAND MANAGEMENTFORM APPROVED  
OMB No. 1004-0137  
Expires: July 31, 2010

## SUNDRY NOTICES AND REPORTS ON WELLS

**Do not use this form for proposals to drill or to re-enter an abandoned well. Use Form 3160-3 (APD) for such proposals.**

5. Lease Serial No.  
UTU-0461

6. If Indian, Allottee or Tribe Name

TRIBAL SURFACE

SUBMIT IN TRIPLICATE – Other instructions on page 2.

1. Type of Well

☐ Oil Well ☒ Gas Well ☐ Other

2. Name of Operator

KERR MCGEE OIL &amp; GAS ONSHORE LP

3a. Address

1368 SOUTH 1200 EAST VERNAL, UTAH 84078

3b. Phone No. (include area code)

435.781.7024

7. If Unit of CA/Agreement, Name and/or No.  
UNIT #891008900A8. Well Name and No.  
NBU 922-18G9. API Well No.  
4304739371

4. Location of Well (Footage, Sec., T., R., M., or Survey Description)

SW/NE SEC. 18, T9S, R22E 2009'FNL, 1936'FEL

10. Field and Pool or Exploratory Area  
NATURAL BUTTES11. Country or Parish, State  
UINTAH COUNTY, UTAH

## 12. CHECK THE APPROPRIATE BOX(ES) TO INDICATE NATURE OF NOTICE, REPORT OR OTHER DATA

TYPE OF SUBMISSION	TYPE OF ACTION			
<input type="checkbox"/> Notice of Intent	<input type="checkbox"/> Acidize	<input type="checkbox"/> Deepen	<input type="checkbox"/> Production (Start/Resume)	<input type="checkbox"/> Water Shut-Off
<input checked="" type="checkbox"/> Subsequent Report	<input type="checkbox"/> Alter Casing	<input type="checkbox"/> Fracture Treat	<input type="checkbox"/> Reclamation	<input type="checkbox"/> Well Integrity
<input type="checkbox"/> Final Abandonment Notice	<input type="checkbox"/> Casing Repair	<input type="checkbox"/> New Construction	<input checked="" type="checkbox"/> Recomplete	<input type="checkbox"/> Other _____
	<input type="checkbox"/> Change Plans	<input type="checkbox"/> Plug and Abandon	<input type="checkbox"/> Temporarily Abandon	
	<input type="checkbox"/> Convert to Injection	<input type="checkbox"/> Plug Back	<input type="checkbox"/> Water Disposal	

13. Describe Proposed or Completed Operation: Clearly state all pertinent details, including estimated starting date of any proposed work and approximate duration thereof. If the proposal is to deepen directionally or recomplete horizontally, give subsurface locations and measured and true vertical depths of all pertinent markers and zones. Attach the Bond under which the work will be performed or provide the Bond No. on file with BLM/BIA. Required subsequent reports must be filed within 30 days following completion of the involved operations. If the operation results in a multiple completion or recompletion in a new interval, a Form 3160-4 must be filed once testing has been completed. Final Abandonment Notices must be filed only after all requirements, including reclamation, have been completed and the operator has determined that the site is ready for final inspection.)

THE OPERATOR HAS PERFORMED A RECOMPLETION ON THE SUBJECT WELL LOCATION. THE OPERATOR HAS COMPLETED THE NEWLY WASATCH AND MESAVERDE FORMATIONS, AND HAS COMMINGLED THE NEWLY WASATCH AND MESAVERDE FORMATIONS ALONG WITH THE EXISTING MESAVERDE FORMATIONS. THE OPERATOR HAS PLACED THE SUBJECT WELL ON PRODUCTION ON 02/20/2009 AT 10:30 AM.

PLEASE REFER TO THE ATTACHED RECOMPLETION CHRONOLOGICAL WELL HISTORY.

RECEIVED

MAR 02 2009

DIV. OF OIL, GAS &amp; MINING

14. I hereby certify that the foregoing is true and correct.

Name (Printed/Typed)

SHEILA UPCHEGO

Title REGULATORY ANALYST

Signature

Date 02/24/2009

THIS SPACE FOR FEDERAL OR STATE OFFICE USE

Approved by

Title

Date

Conditions of approval, if any, are attached. Approval of this notice does not warrant or certify that the applicant holds legal or equitable title to those rights in the subject lease which would entitle the applicant to conduct operations thereon.

Office

Title 18 U.S.C. Section 1001 and Title 43 U.S.C. Section 1212, make it a crime for any person knowingly and willfully to make to any department or agency of the United States any false, fictitious or fraudulent statements or representations as to any matter within its jurisdiction.

(Instructions on page 2)



# ROCKIES

## Operation Summary Report

Well: NBU 922-18G			Spud Conductor: 12/10/2007			Spud Date: 1/9/2008		
Project: UTAH			Site: UINTAH			Rig Name No: MILES 3/3		
Event: RECOMPLETION			Start Date: 2/12/2009			End Date:		
Active Datum: RKB @4,816.00ft (above Mean Sea Level)			UWI: 0/9/S/22/E/18/0/SWNE/6/PM/N/2,009.00/E/0/1,936.00/0/0					
Date	Time Start-End	Duration (hr)	Phase	Code	Subcode2	P/U	MD From (ft)	Operation
2/12/2009	7:00 - 17:00	10.00	COMP	31		P		7:AM HSM. MOVE TO LOC. RU RIG. 295 PSI ON WELL. BLOW DOWN. PUMP 20 BBLS DOWN TBG. ND WELLHEAD. NU BOP. UNLAND 23/8" TBG. POOH W/ 267 JTS , POBS. ALL TBG CLEAN. SWI 6:PM
2/13/2009	7:00 - 15:00	8.00	COMP	31		P		7:AM HSM. OPEN WELL, 500 PSI. BLOW DOWN. ND BOP, NU FRAC VALVES. RU CUTTERS. RIH W/ 37/8" GUAGE TO 7880'. RIH W/ 8K CBP, SET @ 7829'. FILL WELL. PRES TEST TO 6200 PSI. HELD, BLED PRES. RIH PERF WASATCH @ 7686-88, 4SPF, PERF MESAVERDE @ 7704-06, 7722-24, 7783-85, 7797-99, 4SPF. 40 HOLES TOTAL. 33/8" GUN. SWI 3:PM
2/16/2009	6:30 - 7:00	0.50	COMP	48		P		DAY 3 - JSA & SM #3
	7:00 - 8:25	1.42	COMP	36	E	P		STG #1) WHP = 384 PSI. BRK DWN PERFS 4.6 BPM @ 2665 PSI. EST INJ. RATE 9.8 BPM @ 2350 PSI. ISIP = 1858 PSI, FG = 0.68. PMP 3 BBLS HCL & 100 BBLS SLK WTR W/10/1000 SCALE INHIB. PMP 160 BBLS 51.3 BPM @ 4130 PSI. 30/40 PERFS OPEN - 75%. MP 5194 PSI, MR 51.6 BPM, AP 4129 PSI, AR 51.1 BPM, ISIP = 2709 PSI, FG = 0.78. NPI = 851 PSI, PMP 2472 BBLS SLK WTR, 77,586 LBS OTTOWA SND, 5,046 LBS TLC, 82,633 LBS TOTAL SAND.
	8:25 - 9:35	1.17	COMP	37	B	P		STG #2) RIH W/3 3/8" EXP GNS, 23 GRM, 0.36 HOLES, 120 DEG PHSG. SET BAKER 8K CBP @ 7276'. PERF WASATCH FROM 7243' - 46', 4 SPF, 7116' - 20', 4 SPF, 7060' - 63', 4 SPF, 40 HOLES, POOH W/TOOLS.
	9:30 - 9:55	0.42	COMP	36	E	P		STG #2) WHP = 17 PSI. BRK DWN PERFS 4.6 BPM @ 2292 PSI. EST INJ. RATE 10.2 BPM @ 2350 PSI. ISIP = 2011 PSI, FG = 0.72. PMP 160 BBLS 51.0 BPM @ 3780 PSI. 39/40 PERFS OPEN - 98%. MP 4645 PSI, MR 52.4 BPM, AP 3895 PSI, AR 51.9 BPM, ISIP = 2165 PSI, FG = 0.75. NPI = 154 PSI, PMP 597 BBLS SLK WTR, 13,130 LBS OTTOWA SND, 4,842 LBS TLC, 17,973 LBS TOTAL SAND.
	9:55 - 11:55	2.00	COMP	37	B	P		STG #3) RIH W/3 3/8" EXP GNS, 23 GRM, 0.36 HOLES, 120 DEG PHSG. SET BAKER 8K CBP @ 6471'. PLUG DID NOT SET. POOH W/TOOLS. REPLACE SETTING HEAD. RUN BACK IN HOLE. SET BAKER 8K CBP @ 6471'. PERF WASATCH FROM 6439' - 41', 4 SPF, 6430' - 32', 4 SPF, 6423' - 25', 4 SPF, 6378' - 82', 4 SPF, 40 HOLES, POOH W/TOOLS.
	11:55 - 12:13	0.30	COMP	36	E	P		STG #3) WHP = 21 PSI. BRK DWN PERFS 3.8 BPM @ 1670 PSI. EST INJ. RATE 9.6 BPM @ 1342 PSI. ISIP = 991 PSI, FG = 0.60. PMP 140 BBLS 50.0 BPM @ 3630 PSI. 39/40 PERFS OPEN - 98%. MP 3661 PSI, MR 50.5 BPM, AP 2724 PSI, AR 50.2 BPM, ISIP = 1147 PSI, FG = 0.62. NPI = 156 PSI, PMP 667 BBLS SLK WTR, 16,043 LBS OTTOWA SND, 4,775 LBS TLC, 20,818 LBS TOTAL SAND.

## ROCKIES

## Operation Summary Report

Well: NBU 922-18G

Spud Conductor: 12/10/2007

Spud Date: 1/9/2008

Project: UTAH

Site: UINTAH

Rig Name No: MILES 3/3

Event: RECOMPLETION

Start Date: 2/12/2009

End Date:

Active Datum: RKB @4,816.00ft (above Mean Sea Level)

UWI: 0/9/S/22/E/18/0/SWNE/6/PM/N/2,009.00/E/0/1,936.00/0/0

Date	Time Start-End	Duration (hr)	Phase	Code	Subcode2	P/U	MD From (ft)	Operation
	12:13 - 12:48	0.58	COMP	37	B	P		STG #4) RIH W/3 3/8" EXP GNS, 23 GRM, 0.36 HOLES, 120 DEG PHSG. SET BAKER 8K CBP @ 5545'. PERF WASATCH FROM 5510' - 15', 4 SPF, 5333' - 38', 4 SPF, 40 HOLES, POOH W/TOOLS.
	12:48 - 13:50	1.03	COMP	36	E	P		STG #4) WHP = 34 PSI. BRK DWN PERFS 3.6 BPM @ 2403 PSI. EST INJ. RATE 10.9 BPM @ 1510 PSI. ISIP = 1260 PSI, FG = 0.68. PMP 280 BBLS 50.0 BPM @ 3050 PSI. 32/40 PERFS OPEN - 79%. MP 4097 PSI, MR 51.1 BPM, AP 2981 PSI, AR 50.2 BPM, ISIP = 1888 PSI, FG = 0.79. NPI = 628 PSI, PMP 1877 BBLS SLK WTR, 61,317 LBS OTTOWA SND, 8,687 LBS TLC, 70,004 LBS TOTAL SAND.
	13:50 - 14:35	0.75	COMP	34	I	P		KILL PLUG) RIH W/BAKER 8K CBP & SET @ 5257'. POOH W/WIRELINE TOOLS & L/D. RDMO CUTTERS WIRELINE & WEATHERFORD PMPG SERV.
	14:35 - 14:35	0.00	COMP	31	I	P		ND FRAC VALVES, NU BOP. PU 3 7/8" BIT, POBS & XN NIPPLE. RIH ON 166 JTS USED 2 3/8" 4.7# J55 TBG. EOT @ 5220'.
2/17/2009	7:00 - 7:30	0.50	COMP	48		P		1700 - SWI - SDFN. DAY 4 - JSA & SM #4

## ROCKIES

## Operation Summary Report

Well: NBU 922-18G			Spud Conductor: 12/10/2007			Spud Date: 1/9/2008		
Project: UTAH			Site: UINTAH			Rig Name No: MILES 3/3		
Event: RECOMPLETION			Start Date: 2/12/2009			End Date:		
Active Datum: RKB @4,816.00ft (above Mean Sea Level)			UWI: 0/9/S/22/E/18/0/SWNE/6/PM/N/2,009.00/E/0/1,936.00/0/0					
Date	Time Start-End	Duration (hr)	Phase	Code	Subcode2	P/U	MD From (ft)	Operation
	7:30 - 15:30	8.00	COMP	44	C	P		WHP = 0 PSI. EOT @ 5220' R/D TBG EQUIP. R/U PWR SWVL. EST. CIRC. W/2% KCL WTR. PRESSURE TEST BOP TO 3000 PSI. RIH TAG FILL @ 5217'. C/O OUT 30' OF FILL.  CBP #1) DRLG OUT BAKER 8K CBP @ 5247' IN 8 MIN. 500 PSI DIFF. RIH TAG FILL @ 5515'. C/O 30' OF SND. FCP = 100 PSI.  CBP #2) DRLG OUT BAKER 8K CBP @ 5545' IN 8 MIN. 100 PSI DIFF. RIH TAG FILL @ 6431'. (SHUT WELL IN WAIT FOR WTR TRKS TO HAUL FLOWBACK TANK). SICP = 200 PSI. C/O 30' OF SND. FCP = 100 PSI.  CBP #3) DRLG OUT BAKER 8K CBP @ 6471' IN 8 MIN. 300 PSI DIFF. RIH TAG FILL @ 7261'. C/O 15' OF SND. FCP = 200 PSI.  CBP #4) DRLG OUT BAKER 8K CBP @ 7276' IN 10 MIN. 400 PSI DIFF. RIH TAG FILL @ 7809'. C/O 20' OF SND. FCP = 150 PSI.  CBP #5) DRLG OUT BAKER 8K CBP @ 7829' IN 8 MIN. 0 PSI DIFF. RIH TAG 10' BRIDGE @ 9300'. RIH TAG FILL @ 9462'. PBTD @ 9474'. FCP = 50 PSI. R/D PWR SWVL. POOH & L/D 34 JTS TBG ON FLOAT. (100 JTS ON FLOAT TOTAL). LAND TBG ON HANGER W/267 JTS USED 2 3/8" 4.7# J55 TBG. EOT @ 8397.85', POBS W/XN NIPPLE @ 8395.65'.  R/D FLOOR & TBG EQUIP. ND BOP, DROP BALL, NU WELL HEAD. PMP OFF BIT @ 1100 PSI. WAIT 30 MIN FOR BIT TO FALL TO BTM. OPEN WELL TO F.B.T. ON 20 CHOKE. FTP = 000 PSI, SICP = 175 PSI.  15:30 - TURN WELL TO F.B.C. LTR = 4813 BBLS.  RDMO SERVICE UNIT. SDFN. 7 AM FLBK REPORT: CP 1300#, TP 825#, 20/64" CK, 32 BWPH, LIGHT SAND, - GAS TTL BBLS RECOVERED: 1615 BBLS LEFT TO RECOVER: 4218 7 AM FLBK REPORT: CP 1625#, TP 1150#, 20/64" CK, 20 BWPH, LIGHT SAND, - GAS TTL BBLS RECOVERED: 2183 BBLS LEFT TO RECOVER: 3650 7 AM FLBK REPORT: CP 1450#, TP 1150#, 20/64" CK, 15 BWPH, LIGHT SAND, - GAS TTL BBLS RECOVERED: 2559 BBLS LEFT TO RECOVER: 3274 7 AM FLBK REPORT: CP 1250#, TP 1050#, 20/64" CK, 9 BWPH, LIGHT SAND, 1700 GAS TTL BBLS RECOVERED: 2843 BBLS LEFT TO RECOVER: 2990
2/18/2009	7:00 -			33	A			
2/19/2009	7:00 -			33	A			
2/20/2009	7:00 -			33	A			
2/21/2009	7:00 -			33	A			

UNITED STATES  
DEPARTMENT OF THE INTERIOR  
BUREAU OF LAND MANAGEMENTFORM APPROVED  
OMB NO. 1004-0137  
Expires: July 31, 2010

## WELL COMPLETION OR RECOMPLETION REPORT AND LOG

5. Lease Serial No.  
UTU-04611a. Type of Well ☐ Oil Well ☒ Gas Well ☐ Dry ☐ Other  
b. Type of Completion: ☐ New Well ☒ Work Over ☐ Deepen ☐ Plug Back ☐ Diff. Resvr.,

Other: \_\_\_\_\_

2. Name of Operator  
KERR MCGEE OIL & GAS ONSHORE LP6. If Indian, Allottee or Tribe Name  
TRIBAL SURFACE7. Unit or CA Agreement Name and No.  
UNIT #891008900A8. Lease Name and Well No.  
NBU 922-18G3. Address  
1368 SOUTH 1200 EAST VERNAL, UTAH 840783a. Phone No. (include area code)  
435.781.70249. AFI Well No.  
4304739371

4. Location of Well (Report location clearly and in accordance with Federal requirements)\*

At surface SW/NE 2009'FNL, 1936'FEL

10. Field and Pool or Exploratory  
NATURAL BUTTES11. Sec., T., R., M., on Block and  
Survey or Area  
SEC. 18, T9S, R22E

At top prod. interval reported below

12. County or Parish  
UINTAH, COUNTY13. State  
UT

At total depth

14. Date Spudded  
12/07/200715. Date T.D. Reached  
03/30/200816. Date Completed 02/20/2009  
☐ D & A ☒ Ready to Prod.17. Elevations (DF, RKB, RT, GL)\*  
4802'GL18. Total Depth: MD 9530'  
TVD19. Plug Back T.D.: MD 9474'  
TVD20. Depth Bridge Plug Set: MD  
TVD21. Type Electric & Other Mechanical Logs Run (Submit copy of each)  
N/A22. Was well cored? ☒ No ☐ Yes (Submit analysis)  
Was DST run? ☒ No ☐ Yes (Submit report)  
Directional Survey? ☒ No ☐ Yes (Submit copy)

23. Casing and Liner Record (Report all strings set in well)

Hole Size	Size Grade	Wt. (# ft.)	Top (MD)	Bottom (MD)	Stage Cement Depth	No. of Sks. & Type of Cement	Slurry Vol. (BBL)	Cement Top*	Amount Pulled
20"	14" STEEL	36.7#		40'		28 SX			
12 1/4"	9 5/8" J-55	36#		2740'		615 SX			
7 7/8"	4 1/2 I-80	11.6#		9530'		1660 SX			

24. Tubing Record

Size	Depth Set (MD)	Packer Depth (MD)	Size	Depth Set (MD)	Packer Depth (MD)	Size	Depth Set (MD)	Packer Depth (MD)
2 3/8"	8398'							

25. Producing Intervals

Formation	Top	Bottom	Perforated Interval	Size	No. Holes	Perf. Status
A) WASATCH	5333'	7246'	5333'-7246'	0.36	120	OPEN
B) WSTCH/MESA	7686'	7799'	7686'-7799'	0.36	40	OPEN
C)						
D)						

27. Acid, Fracture, Treatment, Cement Squeeze, etc.

Depth Interval	Amount and Type of Material
5333'-7246'	PMP 3141 BBLS SLICK H2O & 108,796# 30/50 OTTOWA SD
7686'-7799'	PMP 2472 BBLS SLICK H2O & 82,633# 30/50 OTTOWA SD

28. Production - Interval A

Date First Produced	Test Date	Hours Tested	Test Production	Oil BBL	Gas MCF	Water BBL	Oil Gravity Corr. API	Gas Gravity	Production Method
2/20/09	3/7/09	24	→	3	1600	120			FLows FROM WELL
Choke Size	Tbg. Press. Flwg. SI	Csg. Press.	24 Hr. Rate	Oil BBL	Gas MCF	Water BBL	Gas Oil Ratio	Well Status	
20/64	798#	1072#	→	3	1600	120		PRODUCING GAS WELL	

28a. Production - Interval B

Date First Produced	Test Date	Hours Tested	Test Production	Oil BBL	Gas MCF	Water BBL	Oil Gravity Corr. API	Gas Gravity	Production Method
2/20/09	3/7/09	24	→	3	1600	120			FLows FROM WELL
Choke Size	Tbg. Press. Flwg. SI	Csg. Press.	24 Hr. Rate	Oil BBL	Gas MCF	Water BBL	Gas Oil Ratio	Well Status	
20/64	798#	1072#	→	3	1600	120		PRODUCING GAS WELL	

\*(See instructions and spaces for additional data on page 2)

RECEIVED  
MAR 23 2009  
DIV. OF OIL, GAS & MINING

## 28b. Production - Interval C

Date First Produced	Test Date	Hours Tested	Test Production →	Oil BBL	Gas MCF	Water BBL	Oil Gravity Corr. API	Gas Gravity	Production Method
Choke Size	Tbg. Press. Flwg. SI	Csg. Press.	24 Hr. Rate →	Oil BBL	Gas MCF	Water BBL	Gas/Oil Ratio	Well Status	

## 28c. Production - Interval D

Date First Produced	Test Date	Hours Tested	Test Production →	Oil BBL	Gas MCF	Water BBL	Oil Gravity Corr. API	Gas Gravity	Production Method
Choke Size	Tbg. Press. Flwg. SI	Csg. Press.	24 Hr. Rate →	Oil BBL	Gas MCF	Water BBL	Gas/Oil Ratio	Well Status	

## 29. Disposition of Gas (Solid, used for fuel, vented, etc.)

SOLD

## 30. Summary of Porous Zones (Include Aquifers):

Show all important zones of porosity and contents thereof: Cored intervals and all drill-stem tests, including depth interval tested, cushion used, time tool open, flowing and shut-in pressures and recoveries.

## 31. Formation (Log) Markers

Formation	Top	Bottom	Descriptions, Contents, etc.	Name	Top
					Meas. Depth
GREEN RIVER	1720'				
BIRDS NEST	1999'				
MAHOGANY	2353'				
WASATCH	4962'	7691'			
MESAVERDE	7701'	9462'			

## 32. Additional remarks (include plugging procedure):

## 33. Indicate which items have been attached by placing a check in the appropriate boxes:

- ☐ Electrical/Mechanical Logs (1 full set req'd.)
 ☐ Geologic Report
 ☐ DST Report
 ☐ Directional Survey
- ☐ Sundry Notice for plugging and cement verification
 ☐ Core Analysis
 ☐ Other:

## 34. I hereby certify that the foregoing and attached information is complete and correct as determined from all available records (see attached instructions)\*

Name (please print) SHEILA UPCHEGO

Title REGULATORY ANALYST

Signature

Date 03/17/2009

Title 18 U.S.C. Section 1001 and Title 43 U.S.C. Section 1212, make it a crime for any person knowingly and willfully to make to any department or agency of the United States any false, fictitious or fraudulent statements or representations as to any matter within its jurisdiction.

(Continued on page 3)

(Form 3160-4, page 2)

<b>STATE OF UTAH</b> DEPARTMENT OF NATURAL RESOURCES DIVISION OF OIL, GAS, AND MINING		<b>FORM 9</b>																														
<b>SUNDRY NOTICES AND REPORTS ON WELLS</b>  Do not use this form for proposals to drill new wells, significantly deepen existing wells below current bottom-hole depth, reenter plugged wells, or to drill horizontal laterals. Use APPLICATION FOR PERMIT TO DRILL form for such proposals.		<b>5. LEASE DESIGNATION AND SERIAL NUMBER:</b> UTU-0461																														
<b>1. TYPE OF WELL</b> Gas Well		<b>6. IF INDIAN, ALLOTTEE OR TRIBE NAME:</b> UTE																														
<b>2. NAME OF OPERATOR:</b> KERR-MCGEE OIL & GAS ONSHORE, L.P.		<b>7. UNIT or CA AGREEMENT NAME:</b> NATURAL BUTTES																														
<b>3. ADDRESS OF OPERATOR:</b> P.O. Box 173779 1099 18th Street, Suite 600, Denver, CO, 80217 3779		<b>8. WELL NAME and NUMBER:</b> NBU 922-18G																														
<b>4. LOCATION OF WELL</b> <b>FOOTAGES AT SURFACE:</b> 2009 FNL 1936 FEL <b>QTR/QTR, SECTION, TOWNSHIP, RANGE, MERIDIAN:</b> Qtr/Qtr: SWNE Section: 18 Township: 09.0S Range: 22.0E Meridian: S		<b>9. API NUMBER:</b> 43047393710000																														
<b>10. FIELD and POOL or WILDCAT:</b> NATURAL BUTTES		<b>9. FIELD and POOL or WILDCAT:</b> NATURAL BUTTES																														
<b>COUNTY:</b> UINTAH		<b>STATE:</b> UTAH																														
11. CHECK APPROPRIATE BOXES TO INDICATE NATURE OF NOTICE, REPORT, OR OTHER DATA																																
<b>TYPE OF SUBMISSION</b>  <input type="checkbox"/> NOTICE OF INTENT Approximate date work will start:  <input checked="" type="checkbox"/> SUBSEQUENT REPORT Date of Work Completion: 2/26/2016  <input type="checkbox"/> SPUD REPORT Date of Spud:  <input type="checkbox"/> DRILLING REPORT Report Date:	<b>TYPE OF ACTION</b>  <table style="width: 100%; border: none;"> <tr> <td><input type="checkbox"/> ACIDIZE</td> <td><input type="checkbox"/> ALTER CASING</td> <td><input type="checkbox"/> CASING REPAIR</td> </tr> <tr> <td><input type="checkbox"/> CHANGE TO PREVIOUS PLANS</td> <td><input type="checkbox"/> CHANGE TUBING</td> <td><input type="checkbox"/> CHANGE WELL NAME</td> </tr> <tr> <td><input type="checkbox"/> CHANGE WELL STATUS</td> <td><input type="checkbox"/> COMMINGLE PRODUCING FORMATIONS</td> <td><input type="checkbox"/> CONVERT WELL TYPE</td> </tr> <tr> <td><input type="checkbox"/> DEEPEN</td> <td><input type="checkbox"/> FRACTURE TREAT</td> <td><input type="checkbox"/> NEW CONSTRUCTION</td> </tr> <tr> <td><input type="checkbox"/> OPERATOR CHANGE</td> <td><input type="checkbox"/> PLUG AND ABANDON</td> <td><input type="checkbox"/> PLUG BACK</td> </tr> <tr> <td><input type="checkbox"/> PRODUCTION START OR RESUME</td> <td><input type="checkbox"/> RECLAMATION OF WELL SITE</td> <td><input type="checkbox"/> RECOMPLETE DIFFERENT FORMATION</td> </tr> <tr> <td><input type="checkbox"/> REPERFORATE CURRENT FORMATION</td> <td><input type="checkbox"/> SIDETRACK TO REPAIR WELL</td> <td><input type="checkbox"/> TEMPORARY ABANDON</td> </tr> <tr> <td><input type="checkbox"/> TUBING REPAIR</td> <td><input type="checkbox"/> VENT OR FLARE</td> <td><input type="checkbox"/> WATER DISPOSAL</td> </tr> <tr> <td><input type="checkbox"/> WATER SHUTOFF</td> <td><input type="checkbox"/> SI TA STATUS EXTENSION</td> <td><input type="checkbox"/> APD EXTENSION</td> </tr> <tr> <td><input type="checkbox"/> WILDCAT WELL DETERMINATION</td> <td><input checked="" type="checkbox"/> OTHER</td> <td>OTHER: <input style="width: 100px;" type="text" value="TUBING FAILURE"/></td> </tr> </table>		<input type="checkbox"/> ACIDIZE	<input type="checkbox"/> ALTER CASING	<input type="checkbox"/> CASING REPAIR	<input type="checkbox"/> CHANGE TO PREVIOUS PLANS	<input type="checkbox"/> CHANGE TUBING	<input type="checkbox"/> CHANGE WELL NAME	<input type="checkbox"/> CHANGE WELL STATUS	<input type="checkbox"/> COMMINGLE PRODUCING FORMATIONS	<input type="checkbox"/> CONVERT WELL TYPE	<input type="checkbox"/> DEEPEN	<input type="checkbox"/> FRACTURE TREAT	<input type="checkbox"/> NEW CONSTRUCTION	<input type="checkbox"/> OPERATOR CHANGE	<input type="checkbox"/> PLUG AND ABANDON	<input type="checkbox"/> PLUG BACK	<input type="checkbox"/> PRODUCTION START OR RESUME	<input type="checkbox"/> RECLAMATION OF WELL SITE	<input type="checkbox"/> RECOMPLETE DIFFERENT FORMATION	<input type="checkbox"/> REPERFORATE CURRENT FORMATION	<input type="checkbox"/> SIDETRACK TO REPAIR WELL	<input type="checkbox"/> TEMPORARY ABANDON	<input type="checkbox"/> TUBING REPAIR	<input type="checkbox"/> VENT OR FLARE	<input type="checkbox"/> WATER DISPOSAL	<input type="checkbox"/> WATER SHUTOFF	<input type="checkbox"/> SI TA STATUS EXTENSION	<input type="checkbox"/> APD EXTENSION	<input type="checkbox"/> WILDCAT WELL DETERMINATION	<input checked="" type="checkbox"/> OTHER	OTHER: <input style="width: 100px;" type="text" value="TUBING FAILURE"/>
<input type="checkbox"/> ACIDIZE	<input type="checkbox"/> ALTER CASING	<input type="checkbox"/> CASING REPAIR																														
<input type="checkbox"/> CHANGE TO PREVIOUS PLANS	<input type="checkbox"/> CHANGE TUBING	<input type="checkbox"/> CHANGE WELL NAME																														
<input type="checkbox"/> CHANGE WELL STATUS	<input type="checkbox"/> COMMINGLE PRODUCING FORMATIONS	<input type="checkbox"/> CONVERT WELL TYPE																														
<input type="checkbox"/> DEEPEN	<input type="checkbox"/> FRACTURE TREAT	<input type="checkbox"/> NEW CONSTRUCTION																														
<input type="checkbox"/> OPERATOR CHANGE	<input type="checkbox"/> PLUG AND ABANDON	<input type="checkbox"/> PLUG BACK																														
<input type="checkbox"/> PRODUCTION START OR RESUME	<input type="checkbox"/> RECLAMATION OF WELL SITE	<input type="checkbox"/> RECOMPLETE DIFFERENT FORMATION																														
<input type="checkbox"/> REPERFORATE CURRENT FORMATION	<input type="checkbox"/> SIDETRACK TO REPAIR WELL	<input type="checkbox"/> TEMPORARY ABANDON																														
<input type="checkbox"/> TUBING REPAIR	<input type="checkbox"/> VENT OR FLARE	<input type="checkbox"/> WATER DISPOSAL																														
<input type="checkbox"/> WATER SHUTOFF	<input type="checkbox"/> SI TA STATUS EXTENSION	<input type="checkbox"/> APD EXTENSION																														
<input type="checkbox"/> WILDCAT WELL DETERMINATION	<input checked="" type="checkbox"/> OTHER	OTHER: <input style="width: 100px;" type="text" value="TUBING FAILURE"/>																														
12. DESCRIBE PROPOSED OR COMPLETED OPERATIONS. Clearly show all pertinent details including dates, depths, volumes, etc. A WORKOVER FOR TUBING FAILURE HAS BEEN COMPLETED ON THE NBU 922-18G WELL. PLEASE SEE THE ATTACHED OPERATIONS SUMMARY REPORT FOR DETAILS.																																
Accepted by the Utah Division of Oil, Gas and Mining <b>FOR RECORD ONLY</b> March 01, 2016																																
<b>NAME (PLEASE PRINT)</b> Kristina Geno	<b>PHONE NUMBER</b> 720 929-6824	<b>TITLE</b> Regulatory Analyst																														
<b>SIGNATURE</b> N/A	<b>DATE</b> 3/1/2016																															

**US ROCKIES REGION**  
**Operation Summary Report**

Well: NBU 922-18G				Spud Conductor: 12/10/2007				Spud date: 1/9/2008			
Project: UTAH-UINTAH				Site: NBU 922-18G				Rig name no.: ROCKY MOUNTAIN WELL SERVICE 1/1			
Event: WELL WORK EXPENSE				Start date: 2/17/2016				End date: 2/23/2016			
Active datum: RKB @4,816.00usft (above Mean Sea Level)				UWI: 0/9/S/22/E/18/0/SWNE/6/PM/N/2,009.00/E/0/1,936.00/0/0							
Date	Time Start-End	Duration (hr)	Phase	Code	Sub Code	P/U	MD from (usft)	Operation			
2/1/2016	7:00 - 10:30	3.50	MAINT	35		P		RUN JDC PULLING TOOL COULD NOT LATCH STANDING VALVE. RUN JDC PULLING TOOL HIT DOWN HARD COULD NOT LATCH STANDING VALVE. RUN IMPRESSION LOOKS LIKE FISH NECK WITH SOMETHING ON THE SIDE OF FISH NECK			
								FLUID LEVEL 4044 SEAT NIPPLE DEPTH 8370			
								SN TYPE TD (Max Depth)			
2/17/2016	7:00 - 7:15	0.25	MAINT	48		P		HSM, SPOTTING EQUIP			
	7:15 - 13:00	5.75	MAINT	30	A	P		ROAD RIG FROM CIGE 212 TO LOC. MIRU, SPOT EQUIP. MIRU, BLOW WELL DOWN, N/D WELL HEAD. P/U ON TBG. TBG NOT STUCK, LAND BACK. N/U BOPS, R/U TBG EQUIP			
	13:00 - 17:30	4.50	MAINT	45	A	P		MIRU SCAN TECH, SCAN 267 JNT 2-3/8 J-55 TBG. JNT #77 HAD HOLE IN IT. TBG FULL R/U SWAB EQUIP, SWABBED WELL DOWN, WELL KEEPS BLOWING UP TBG, CAN'T PUMP DOWN TBG, PRESSURES UP.			
2/18/2016	7:00 - 7:15	0.25	MAINT	48		P		HSM, L/D TBG			
	7:15 - 15:00	7.75	MAINT					SICP=425#, SITP=0#, BLOW WELL DOWN CONTROL W/ 30 BBLS. CONT TO SCAN 268 TOTAL JNT 2-3/8 J-55 TBG, 71 YELLOW / BLUE BAND, 197 JNTS RED [JUNK], P/U 3-7/8 MILL W/ POBS PKG, TALLEY AND START P/U 2-3/8 P-110 TBG. P/U 155 JNTS 2-3/8 P-110 TBG W/ EOT @=4,928'			
								SWIFWE			
2/22/2016	7:00 - 7:15	0.25	MAINT	48		P		HSM, CHECKING PRESSURES			
	7:15 - 10:00	2.75	MAINT	31	I	P		SICP=#, SITP=#, BLOW WELL DOWN CONT TO P/U 2-3/8 P-110 TBG, TAG W/ 293 JNTS @=9,278', P/U POWER SWIVEL,MIRU WEATHERFORD AIR FOAM N2 UNIT.			
	10:00 - 11:30	1.50	MAINT	31	H	P		BREAK CIRC.			
	11:30 - 14:30	3.00	MAINT	44	D	P		C/O FROM 9,278' DOWN TO 9,283' MILLED IN SAME SPOT FOR 2 HRS DID NOT MAKE ANY HOLE [ON OLD POBS] CONTROL TBG W/ 15 BBLS, R/D POWER SWIVEL			
	14:30 - 17:00	2.50	MAINT	31	I	P		L/D 29 JNTS, PULL 180 JNTS W/ EOT @=2,684' SWIFN.			
2/23/2016	7:00 - 7:15	0.25	MAINT	48		P		HSM, BROACHING TBG			
	7:15 - 12:30	5.25	MAINT	31	I	P		SICP=400#, SITP=0#, BLOW WELL DOWN CONTROL W/ 25 BBLS, CONT TO POOH W/ MILL. L/D MILL. P/U PROFILE NOTCHED COLLAR {1.875} RIH W/ 264 JNTS 2-3/8 P-110 TBG, P/U HANGER AND LAND W/ EOT @= 8,388.94'. BROACHED TBG. R/D TBG EQUIP. N/D BOPS, N/U WELL HEAD BLOW WELL AROUND W/ AIR FOAM / N2 UNIT.			
								RDMO.			
2/26/2016	7:00 - 11:00	4.00	PROD	42	B	P		FLUID LEVEL=5500			



Effective Date: 6/30/2020

FORMER OPERATOR:	NEW OPERATOR:
Kerr-McGee Oil and Gas Onshore, L.P.	Caerus Uinta, LLC
Groups: 10/9/2020 sent list to operators to review.	

WELL INFORMATION:

Well Name	API Number	Town	Dir	Range	Dir	Sec	Entity Number	Type	Status
See Attached list									

Total Well Count: 3508  
Pre-Notice Completed: 11/10/2020

OPERATOR CHANGES DOCUMENTATION:

- Sundry or legal documentation was received from the **FORMER** operator on: 8/11/2020
- Sundry or legal documentation was received from the **NEW** operator on: 8/11/2020
- New operator Division of Corporations Business Number: 11801118-0161

REVIEW:

Receipt of Acceptance of Drilling Procedures for APD on: 10/16/2020  
Reports current for Production/Disposition & Sundries: 11/10/2020  
OPS/SI/TA well(s) reviewed for full cost bonding: Approved by Dustin 11/9/2020  
UIC5 on all disposal/injection/storage well(s) Approved on: Approved by Dayne 10/16/2020  
Surface Facility(s) included in operator change:

East Bench  
Archie Bench  
Bonanza  
Bridge  
Goat Pasture  
Goat Pasture Manifold  
Morgan State 921-36P  
Morgan States  
NBU 1022-14B  
NBU 921-25A  
NBU 922-29J  
NBU 922-32N  
Pipeline  
Sage Grouse  
Sand Wash

NEW OPERATOR BOND VERIFICATION:

State/fee well(s) covered by Bond Number(s): 6135000111  
LPM9344488-Shut-In Bond

DATA ENTRY:

Well(s) update in the RBDMS on: 11/19/2020  
Group(s) update in RDBMS on: 11/19/2020  
Surface Facilities update in RBDMS on: 11/19/2020  
Entities Updated in RBDMS on: 11/19/2020

COMMENTS: Shut-In Wells that were reviewed.

CIGE 236 4304732861  
CIGE 42 4304730492  
CIGE 55 4304730512  
Love 1121-16N 4304736256  
Morgan State 16-36 4304733093  
NBU 341-29E 4304733055  
NBU 691-29E 4304750027  
NBU 921-33F 4304736391  
NBU 99 4304731745  
Ouray SWD 1 4304733449  
State 1022-32O 4304735315  
State 921-32M 4304734872



STATE OF UTAH  
DEPARTMENT OF NATURAL RESOURCES  
DIVISION OF OIL, GAS AND MINING

FORM 9

**SUNDRY NOTICES AND REPORTS ON WELLS**

Do not use this form for proposals to drill new wells, significantly deepen existing wells below current bottom-hole depth, reenter plugged wells, or to drill horizontal laterals. Use APPLICATION FOR PERMIT TO DRILL form for such proposals.

1. TYPE OF WELL OIL WELL <input type="checkbox"/> GAS WELL <input checked="" type="checkbox"/> OTHER _____		5. LEASE DESIGNATION AND SERIAL NUMBER: U-02278-ST
2. NAME OF OPERATOR: CAERUS UINTA LLC		6. IF INDIAN, ALLOTTEE OR TRIBE NAME:
3. ADDRESS OF OPERATOR: 1001 17TH ST. STE 1600 CITY DENVER STATE CO ZIP 80202		7. UNIT or CA AGREEMENT NAME: NATURAL BUTTES
4. LOCATION OF WELL FOOTAGES AT SURFACE: 1162 FSL 1365 FWL		8. WELL NAME and NUMBER: CIGE 20
QTR/QTR, SECTION, TOWNSHIP, RANGE, MERIDIAN: SESW 20 10S 21E S		9. API NUMBER: 43047304850000
COUNTY: UTAH		10. FIELD AND POOL, OR WILDCAT:

11. CHECK APPROPRIATE BOXES TO INDICATE NATURE OF NOTICE, REPORT, OR OTHER DATA			
TYPE OF SUBMISSION	TYPE OF ACTION		
<input checked="" type="checkbox"/> NOTICE OF INTENT (Submit in Duplicate) Approximate date work will start: 06/30/2020	<input type="checkbox"/> ACIDIZE	<input type="checkbox"/> DEEPEN	<input type="checkbox"/> REPERFORATE CURRENT FORMATION
<input type="checkbox"/> SUBSEQUENT REPORT (Submit Original Form Only) Date of work completion:	<input type="checkbox"/> ALTER CASING	<input type="checkbox"/> FRACTURE TREAT	<input type="checkbox"/> SIDETRACK TO REPAIR WELL
	<input type="checkbox"/> CASING REPAIR	<input type="checkbox"/> NEW CONSTRUCTION	<input type="checkbox"/> TEMPORARILY ABANDON
	<input type="checkbox"/> CHANGE TO PREVIOUS PLANS	<input checked="" type="checkbox"/> OPERATOR CHANGE	<input type="checkbox"/> TUBING REPAIR
	<input type="checkbox"/> CHANGE TUBING	<input type="checkbox"/> PLUG AND ABANDON	<input type="checkbox"/> VENT OR FLARE
	<input type="checkbox"/> CHANGE WELL NAME	<input type="checkbox"/> PLUG BACK	<input type="checkbox"/> WATER DISPOSAL
	<input type="checkbox"/> CHANGE WELL STATUS	<input type="checkbox"/> PRODUCTION (START/RESUME)	<input type="checkbox"/> WATER SHUT-OFF
	<input type="checkbox"/> COMMINGLE PRODUCING FORMATIONS	<input type="checkbox"/> RECLAMATION OF WELL SITE	<input checked="" type="checkbox"/> OTHER: Transfer remediation liabilities
	<input type="checkbox"/> CONVERT WELL TYPE	<input type="checkbox"/> RECOMPLETE - DIFFERENT FORMATION	

12. DESCRIBE PROPOSED OR COMPLETED OPERATIONS. Clearly show all pertinent details including dates, depths, volumes, etc.

Effective June 30, 2020, operation of the following wells was taken over by:  
Caerus Uinta LLC  
1001 17th Street, Suite 1600  
Denver, CO 80202  
303-565-4600

The previous Operator was Kerr-McGee Oil & Gas Onshore LP  
PO Box 173779  
Denver, CO 80217-3779

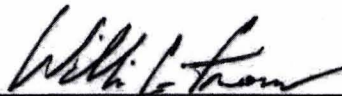
  
William C. Irons  
Attorney-in-Fact

Please see the attached wells for a complete list that will be transferred upon approval. As the Attorney-in-Fact for Kerr-McGee Oil & Gas Onshore LP I ask that you accept this letter as Kerr-McGee's official resignation and request to transfer operating rights to Caerus Uinta LLC, whose operator number is 105039. UDOGM Bond# 6135000111 and BLM Bond# COB000387.

Kerr-McGee will be transferring cleanup/soils remediation to Caerus Uinta LLC for Incident #5772. The new contact for Caerus is Grizz Oleen, EHS Field Lead (435) 790-9669.

NAME (PLEASE PRINT) <u>Aubree Besant</u>	TITLE <u>Director of Land</u>
SIGNATURE _____	DATE _____

(This space for State use only)

**APPROVED**

By: Rachel Medina  
Utah Division of  
Oil, Gas, and Mining

(See Instructions on Reverse Side)

RECEIVED

AUG 11 2020

DIV OF OIL, GAS & MINING

STATE OF UTAH  
DEPARTMENT OF NATURAL RESOURCES  
DIVISION OF OIL, GAS AND MINING

FORM 9

**SUNDRY NOTICES AND REPORTS ON WELLS**

Do not use this form for proposals to drill new wells, significantly deepen existing wells below current bottom-hole depth, reenter plugged wells, or to drill horizontal laterals. Use APPLICATION FOR PERMIT TO DRILL form for such proposals.

5. LEASE DESIGNATION AND SERIAL NUMBER:  
U-02278-ST

6. IF INDIAN, ALLOTTEE OR TRIBE NAME:

7. UNIT or CA AGREEMENT NAME:  
NATURAL BUTTES

1. TYPE OF WELL  
OIL WELL ☐ GAS WELL ☒ OTHER \_\_\_\_\_

8. WELL NAME and NUMBER:  
CIGE 20

2. NAME OF OPERATOR:  
CAERUS UINTA LLC

9. API NUMBER:  
43047304850000

3. ADDRESS OF OPERATOR:  
1001 17TH ST. STE 1600 CITY DENVER STATE CO ZIP 80202 PHONE NUMBER: 303-565-4600

10. FIELD AND POOL, OR WILDCAT:

4. LOCATION OF WELL

FOOTAGES AT SURFACE: 1162 FSL 1365 FWL

COUNTY: UINTAH

QTR/QTR, SECTION, TOWNSHIP, RANGE, MERIDIAN: SESW 20 10S 21E S

STATE: UTAH

11. CHECK APPROPRIATE BOXES TO INDICATE NATURE OF NOTICE, REPORT, OR OTHER DATA

TYPE OF SUBMISSION	TYPE OF ACTION		
<input checked="" type="checkbox"/> NOTICE OF INTENT (Submit in Duplicate) Approximate date work will start: 06/30/2020	<input type="checkbox"/> ACIDIZE	<input type="checkbox"/> DEEPEN	<input type="checkbox"/> REPERFORATE CURRENT FORMATION
	<input type="checkbox"/> ALTER CASING	<input type="checkbox"/> FRACTURE TREAT	<input type="checkbox"/> SIDETRACK TO REPAIR WELL
	<input type="checkbox"/> CASING REPAIR	<input type="checkbox"/> NEW CONSTRUCTION	<input type="checkbox"/> TEMPORARILY ABANDON
	<input type="checkbox"/> CHANGE TO PREVIOUS PLANS	<input checked="" type="checkbox"/> OPERATOR CHANGE	<input type="checkbox"/> TUBING REPAIR
	<input type="checkbox"/> CHANGE TUBING	<input type="checkbox"/> PLUG AND ABANDON	<input type="checkbox"/> VENT OR FLARE
<input type="checkbox"/> SUBSEQUENT REPORT (Submit Original Form Only) Date of work completion:	<input type="checkbox"/> CHANGE WELL NAME	<input type="checkbox"/> PLUG BACK	<input type="checkbox"/> WATER DISPOSAL
	<input type="checkbox"/> CHANGE WELL STATUS	<input type="checkbox"/> PRODUCTION (START/RESUME)	<input type="checkbox"/> WATER SHUT-OFF
	<input type="checkbox"/> COMMINGLE PRODUCING FORMATIONS	<input type="checkbox"/> RECLAMATION OF WELL SITE	<input checked="" type="checkbox"/> OTHER: Transfer remediation liabilities
	<input type="checkbox"/> CONVERT WELL TYPE	<input type="checkbox"/> RECOMPLETE - DIFFERENT FORMATION	

12. DESCRIBE PROPOSED OR COMPLETED OPERATIONS. Clearly show all pertinent details including dates, depths, volumes, etc.

Effective June 30, 2020, operation of the following wells was taken over by:

Caerus Uinta LLC  
1001 17th Street, Suite 1600  
Denver, CO 80202  
303-565-4600

The previous Operator was Kerr-McGee Oil & Gas Onshore LP  
PO Box 173779  
Denver, CO 80217-3779

William C. Irons  
Attorney-in-Fact

Please see the attached wells for a complete list that will be transferred upon approval. As the Attorney-in-Fact for Kerr-McGee Oil & Gas Onshore LP I ask that you accept this letter as Kerr-McGee's official resignation and request to transfer operating rights to Caerus Uinta LLC, whose operator number is 105039. UDOGM Bond# 6135000111 and BLM Bond# COB000387.

Kerr-McGee will be transferring cleanup/soils remediation to Caerus Uinta LLC for Incident #5772. The new contact for Caerus is Grizz Oleen, EHS Field Lead (435) 790-9669.

NAME (PLEASE PRINT) Aubree Besant

TITLE Director of Land

SIGNATURE

DATE

July 17, 2020

RECEIVED

(This space for State use only)

**APPROVED**

By: Rachel Medina  
Utah Division of  
Oil, Gas, and Mining

AUG 11 2020

DIV OF OIL, GAS & MINING





October 2, 2025

Utah Department of Natural Resources  
Division of Oil, Gas and Mining  
1594 West North Temple  
Suite 1210  
Salt Lake City, UT 84116  
Attn: MykelLynn Bryson

RE: Notice of Name Change – Caerus Uinta, LLC

To Whom It May Concern:

Effective September 1, 2025, Caerus Uinta, LLC has changed its name to **KODA GNB, LLC**. KODA Uinta, LLC remains a wholly owned subsidiary of KODA Holdings, LLC.

This is a name change only; there is no change to addresses, tax identification numbers, or bank accounts.

Enclosed for your processing and records are the following:

1. Delaware Secretary of State Name Change Certificate
2. Updated W9 showing name change
3. Name Change Rider B014249 - Blanket Bond
4. Name Change Rider 612418229 - Blanket Idle well Bond
5. Name Change Rider B013581 – Pipeline Pit 1 & 2
6. Name Change Rider B013582 – Bonanza Pit 1 & 2
7. Name Change Rider B013583 – Goat Pasture Pit 1 & 2

Please feel free to contact me at [aly.schuster@kodaresources.com](mailto:aly.schuster@kodaresources.com) or 720-500-0140 should you have any questions or need any additional information.

Sincerely,  
KODA GNB, LLC

A handwritten signature in blue ink, appearing to read "Aly Schuster". The signature is fluid and cursive, with a long horizontal stroke at the end.

Aly Schuster  
Senior Landman

Enclosure

1401 Wynkoop St, Suite 300  
Denver, CO 80202

[owners@kodaresources.com](mailto:owners@kodaresources.com) | [www.kodaresources.com](http://www.kodaresources.com)

# Delaware

The First State

Page 1

I, CHARUNI PATIBANDA-SANCHEZ, SECRETARY OF STATE OF THE  
STATE OF DELAWARE, DO HEREBY CERTIFY THE ATTACHED IS A TRUE AND  
CORRECT COPY OF THE CERTIFICATE OF AMENDMENT OF "CAERUS UINTA  
LLC", CHANGING ITS NAME FROM "CAERUS UINTA LLC" TO "KODA GNB,  
LLC", FILED IN THIS OFFICE ON THE TWENTY-NINTH DAY OF AUGUST,  
A.D. 2025, AT 9:14 O'CLOCK P.M.



7877090 8100  
SR# 20253839085

You may verify this certificate online at [corp.delaware.gov/authver.shtml](http://corp.delaware.gov/authver.shtml)

A handwritten signature in cursive script, reading "C. B. Sanchez".

Charuni Patibanda-Sanchez, Secretary of State

Authentication: 204623735  
Date: 09-02-25

State of Delaware  
Secretary of State  
Division of Corporations  
Delivered 09:11 PM 08/29/2025  
FILED 09:14 PM 08/29/2025  
SR 20253839085 - File Number 7877090

## STATE OF DELAWARE CERTIFICATE OF AMENDMENT

1. Name of Limited Liability Company: Caerus Uinta LLC
2. The Certificate of Formation of the limited liability company is hereby amended as follows:

The name of the limited liability company is: KODA  
GNB, LLC.

IN WITNESS WHEREOF, the undersigned have executed this Certificate on  
the 29th day of August, A.D. 2025.

By: \_\_\_\_\_

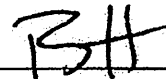

Authorized Person(s)

Name: Ryan Midgett

Print or Type