

UNITED STATES
DEPARTMENT OF THE INTERIOR
GEOLOGICAL SURVEY

43-637-30964

APPLICATION FOR PERMIT TO DRILL, DEEPEN, OR PLUG BACK

1a. TYPE OF WORK
 DRILL DEEPEN PLUG BACK

b. TYPE OF WELL
 OIL WELL GAS WELL OTHER
 SINGLE ZONE MULTIPLE ZONE

2. NAME OF OPERATOR
 Tenneco Oil Company

3. ADDRESS OF OPERATOR
 P.O. Box 3249, Englewood, CO 80155

4. LOCATION OF WELL (Report location clearly and in accordance with any State requirements.)*
 At surface
 810' FSL, 695' FEL
 At proposed prod. zone
 Same as above

14. DISTANCE IN MILES AND DIRECTION FROM NEAREST TOWN OR POST OFFICE*
 Approximately 2 miles NW of Blanding, Utah

15. DISTANCE FROM PROPOSED* LOCATION TO NEAREST PROPERTY OR LEASE LINE, FT. (Also to nearest drlg. unit line, if any)
 695'

16. NO. OF ACRES IN LEASE
 1904.8

17. NO. OF ACRES ASSIGNED TO THIS WELL
 80 ✓

18. DISTANCE FROM PROPOSED LOCATION* TO NEAREST WELL, DRILLING, COMPLETED, OR APPLIED FOR, ON THIS LEASE, FT.
 6371' *AKA*

20. ROTARY OR CABLE TOOLS
 Rotary

21. ELEVATIONS (Show whether DF, RT, GR, etc.)
 6517' GR

22. APPROX. DATE WORK WILL START*
 12/1/83

PROPOSED CASING AND CEMENTING PROGRAM

SIZE OF HOLE	SIZE OF CASING	WEIGHT PER FOOT	SETTING DEPTH	QUANTITY OF CEMENT
17-1/2"	13-3/8"	54.5#	+ 225'	Circulate to surface
11"	8-5/8"	24#	+ 2400' ✓	Circulate to surface
8-3/4"	5-1/2"	17#	+ 6371'	Circulate to cover all possible productive zones

The gas is dedicated.
See attached.

Tenneco respectfully requests this well to be placed on a confidential status. An agreement has been reached with the surface owners regarding restoration. They request restoration to be done in accordance with BLM standards, with the stipulation that only crested wheatgrass be planted.

RECEIVED
NOV 20 1983

CONFIDENTIAL

DIVISION OF OIL, GAS & MINING
 IN ABOVE SPACE DESCRIBE PROPOSED PROGRAM: If proposal is to deepen or plug back, give data on present productive zone and proposed new productive zone. If proposal is to drill or deepen directionally, give depth, size of subsurface locations and measured and true vertical depths. Give blowout preventer program, if any.

24. SIGNED Denise Wilson TITLE Production Analyst DATE 11/21/83

(This space for Federal or State office use)

PERMIT NO. _____ APPROVAL DATE _____

APPROVED BY _____ TITLE _____ DATE _____
 CONDITIONS OF APPROVAL, IF ANY:

COMPANY TENNECO OIL COMPANY

LEASE BLANDING NW Unit WELL NO. 8-16

SEC. 8, T. 36S, R. 22E
SAN JUAN COUNTY, UTAH

LOCATION 810' FSL 695' FEL

ELEVATION 6517 ungraded ground

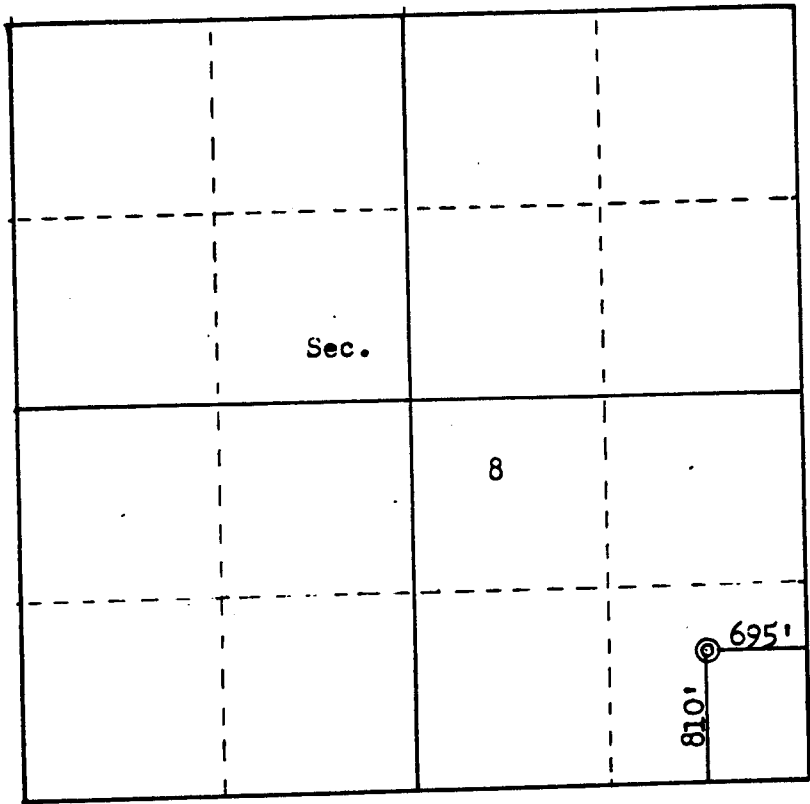

SCALE—4 INCHES EQUALS 1 MILE

THIS IS TO CERTIFY THAT THE ABOVE PLAT WAS PREPARED FROM FIELD NOTE OF ACTUAL SURVEYS, MADE BY ME UNDER MY SUPERVISION AND THAT THE SAME ARE TRUE AND CORRECT TO THE BEST OF MY KNOWLEDGE AND BELIEF.

SEAL:

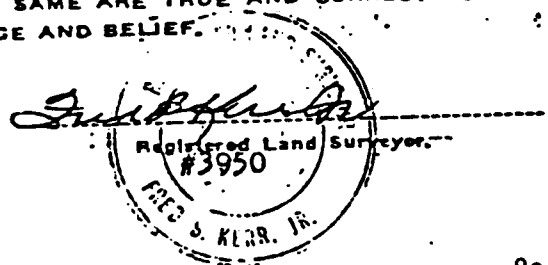

SURVEYED October 31, 19 83

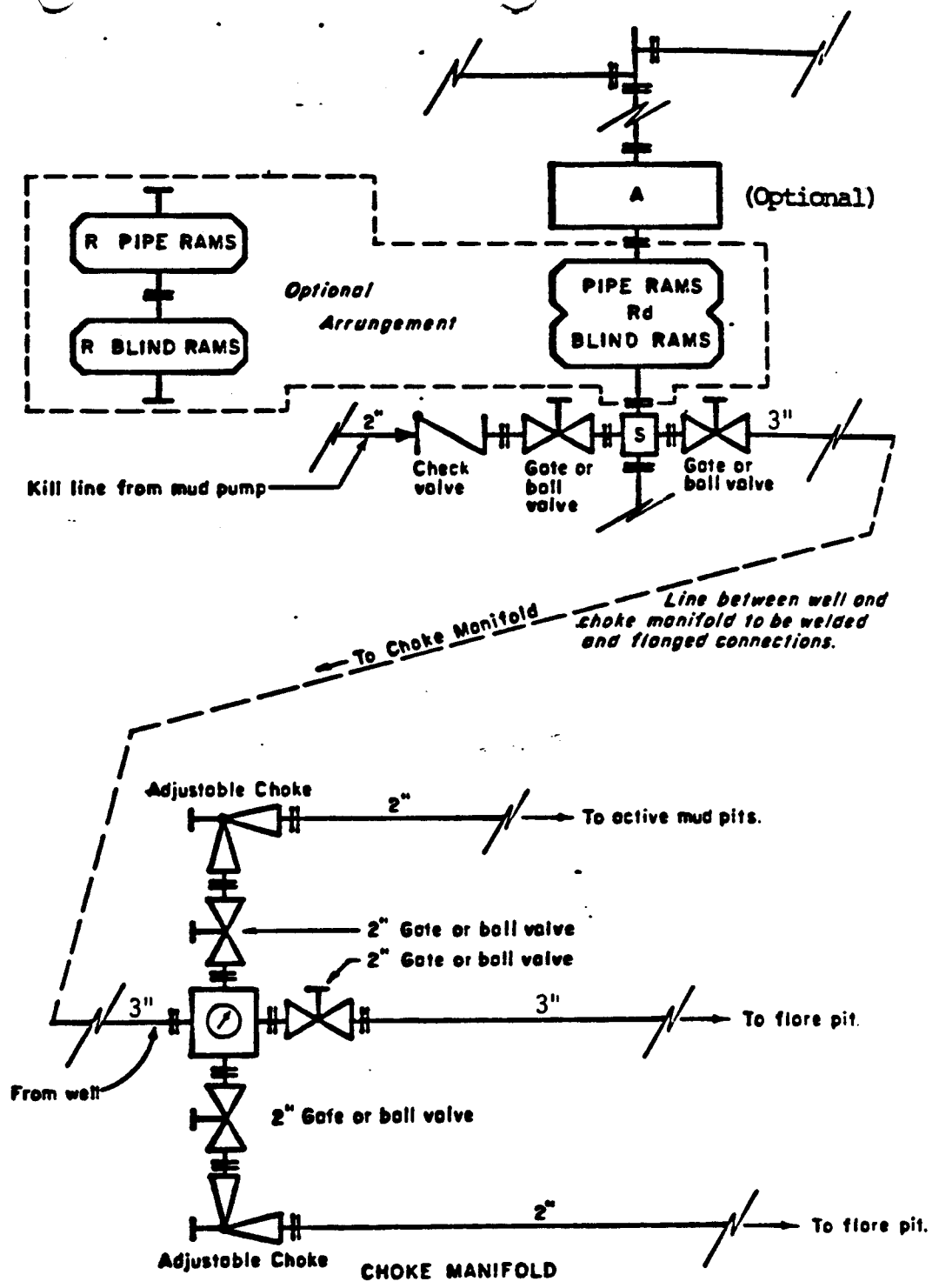

- All equipment to be 5,000 psi working pressure except as noted.
- Rd Double ram type preventer with two sets of rams.
 - R Single ram type preventer with one set of rams.
 - S Drilling spool with side outlet connections for choke and kill lines.
 - A Annular type blowout preventer. (Optional)

ARRANGEMENT B

TENNECO OIL COMPANY
ROCKY MOUNTAIN DIVISION

REQUIRED MINIMUM
BLOWOUT PREVENTER AND
CHOKE MANIFOLD

J. MAGILL 10-26-70 EVI

Doc. 1536R

TENNECO OIL COMPANY
WESTERN ROCKY MOUNTAIN DIVISION
6062 SOUTH WILLOW DRIVE
ENGLEWOOD, COLORADO 80155

DRILLING PROCEDURE

DATE: November 10, 1983

LEASE: Tenneco Blanding Unit

WELL NO.: 8-16

LOCATION: 810' FSL 695' FEL
Sec. 8, T36S, R22E
San Juan County, Utah

FIELD: Wildcat

ELEVATION 6,517' G.L.
6530' K.B.

TOTAL DEPTH: 6371'

PROJECTED HORIZON: Akah

SUBMITTED BY: Tom Dunning

DATE 11/10/83

APPROVED BY: W. C. Long & Co. Inc.

DATE 11-10-83

CC: Administration
CRJ Well File
Field File

ESTIMATED FORMATION TOPS

	SURFACE	
Dakota Sand		
Morrison Shale	88'	
Entrada Sand	1037'	(Water)
Navajo Sand	1297'	(Water)
Kayenta Shale	1837'	(Water)
Wingate Sand	2012'	(Water)
Chinle Shale	2357'	
Shinarump Sand	2887'	
Organ Rock Shale	3427'	
Cedar Mesa Sand	3837'	
Hermosa Lime	5067'	
Ismay	6003'	(Oil and Gas)
Lower Ismay	6148'	
Desert Creek	6246'	(Oil and Gas)
Akah	6351'	
T.D.	6371'	

No abnormal pressures, temperatures or presence of H₂S is anticipated on this hole.

DRILLING, CASING AND CEMENT PROGRAM

1. MIRURT.
2. Set 225' of 13-3/8" casing to be used as surface string. Cement with sufficient volume to circulate cement to the surface.
3. Nipple up 12" casing flange, hydrill, and choke manifold. Pressure test hydrill, manifold, etc to 1000 psi for 15 minutes.
4. Drill 11" hole to 2400' or 50' into the Chinle Shale Formation.
5. Log well as per Exploration Department recommendations.
6. Run 8-5/8" 24#, K-55, ST&C casing to T.D. Cement with sufficient volume to circulate cement to surface.
7. WOC. Nipple up 10" casing head, BOP's and choke manifold. Pressure test BOP's, manifold, etc to 3000 psi for 15 minutes. Drill out float collar and shoe.
8. Drill 8-3/4" hole to T.D. Core and DST as shows warrant.
9. Log well as per Exploration Department recommendations.
10. If well is productive, run 5-1/2" 17#, K-55, ST&C casing to T.D. Cement with sufficient volume to cover all possible productive zones.
11. If the well is non-productive, P & A as per Regulatory Agency specifications.

CASING PROGRAM

SURFACE:	0-225'	225'	13 3/8", 54.5#, K-55, ST&C
INTERMEDIATE:	0-2400'	2400'	8 5/8", 24#, K-55, ST&C
PRODUCTION:	0-6371'	6371'	5 1/2", 17#, K-55, ST&C

MUD PROGRAM

0-225' Spud mud.
225'-2400' Fresh water. Mud sweeps as needed to clean hole.
2400'-5800' Fresh water. Mud sweeps as needed to clean hole.
5800'-6371' LSND

EVALUATION

Cores and DST's: One 60' core in the Ismay.

One DST in the Ismay; possibly others in either Lower Ismay or Desert Creek as shows warrant.

Deviation Surveys

0-225' Every 100' unless hole conditions prohibit running the surveys. Maximum deviation at T.D. = 1°.
225'-2400' Every 500' or on trips. Maximum deviation 1° per 100' or 3° at T.D.
2400'-6371' Every 500' or on trips. Maximum deviation 1° per 100' or 6° at T.D.

Samples:

One full bag every thirty feet from surface to 4500'.
One full bag every ten feet from 4500' to T.D.

Logs:

Intermediate Hole: GR-BHC-CAL; DIL-GR-CAL

Production Hole: GR-BHC-CAL; DLL-MSFL-GR-CAL; CNL-LDT-GR-CAL
(5000'-T.D.); HDT (5500'-T.D.)

BLOWOUT EQUIPMENT

1. Double ram hydraulic with pipe and blind rams operated by an accumulator.
2. Preventors must be checked for operation every 24 hours. This check must be recorded on the IADC Drilling Report Sheet.

REPORTS

Drilling Reports for the past 24 hours will include depth, footage, time distribution, activity breakdown, mud properties, bit record, bottom hole assembly, daily and cumulative mud cost, deviation surveys, and other pertinent information to be called into Division Office by 7:30 AM Monday thru Friday.

TENNECO OIL COMPANY
P.O. Box 3249
ENGLEWOOD, COLORADO 80155
PHONE: 303-740-4800

OFFICE DIRECTORY

Charles R. Jenkins	740-2575
Ted McAdam	740-2576
Tom Dunning	740-4813

In case of emergency or after hours call the following in the preferred order.

(1) Tom Dunning Project Drilling Engineer	740-4813 797-2154	Office Home
(2) Ted McAdam Drilling Engineering Supervisor	740-2576 978-0724	Office Home
(3) Charles R. Jenkins Division Drilling Engineer	740-2575 987-2290	Office Home
(4) Harry Hufft Division Production Manager	771-5257	Home

Multi Point Surface Use Plan for: Tenneco Blanding Unit 8-16

I. EXISTING ROADS

- A. Proposed Well Site Location: See Exhibits 1, 2, & 3
- B. Planned Access Route: There will be + 750 feet of new access road. See exhibit #2, total disturbed width will be 20'. No surfacing material will be used. All grades are less than 8%. The road will be upgraded to Class III standards after completion.
- C. Access Road Labelled: See Exhibit 2
- D. The existing roads are shown on Exhibit 2. San Juan County road department (801-587-2231 Ext. 43) will be contacted before county roads are used.
- E. Existing Road Maintenance or Improvement: Existing dirt road will be maintained to surface management agency standards Class III i.e.; crowned and ditched or dipped from existing road to the location prior to use for moving the drill rig on site.

II. PLANNED ACCESS ROUTE

- A. Route Location: See I B above and Exhibit 2. The proposed new access route was selected to provide the shortest distance to the well site with safe and acceptable grades from the main connector road. Temporary access per surface management agency requirements will be built initially. If the well is a producer, the temporary road will be improved as follows;
 - 1. Width: The average dirt width will be 30 feet. The average traveled surface width will be 20 feet. Road construction will be in accordance with the surface management agency BLM standards.
 - 2. Maximum Grades: Grades will be kept to a minimum using all available engineering techniques. We will construct safe and passable grades that use existing topographic and surface geologic conditions. Maximum grade of new access will be less than 8%.
 - 3. Turnouts: Not required

4. Ditching, crowning and drainage design: Prior to construction of the new access road, the surface vegetation and topsoil will be windrowed to each side of the alignment outside construction limits. The subgrade surface will be minimum elevation of one foot above ditch grade. The road surface will be center crowned and the inslopes will have a maximum slope of 3:1. Fill slopes will be a maximum of 2:1. Water bars and/or water dips will be placed per BLM requirements. Tenneco will contact the San Juan Resource Area Manager at least 48 hours prior to commencing construction of access road and well pad.

5. Construction activity will cease when soils of road and well pad surface become saturated to a depth of 3 (three) inches or more unless otherwise approved by San Juan Resource Area Manager. During the summer and periods of dry weather, dust will be abated using water or other Resource Manager approved method.

6. Culvert Use, major cuts and fills: There is a possibility of installing a culvert under the road by the location, if deemed necessary for drainage.

Maximum cut: Cuts will be to a minimum.

Maximum fill: Fill will be to a minimum.

7. Surfacing Material: The proposed new access road will be constructed using native materials.

8. Gates, Cattleguards, Fence Cuts:

Gates: One gate exists south of the proposed location, which separates federal surface from fee surface. This gate will be widened as necessary for rig movement as per BLM specifications.

Cattleguards: Landowner does not require any installations of cattleguards.

Fence cuts: None

9. New portion of access road will be center staked. Access road will be built along line flagged for pre-drill inspection.

III. LOCATION OF EXISTING WELLS

The proposed well is a wildcat well, nearby wells include:

- A. Water Wells: N/A
- B. Abandoned Wells: N/A
- C. Temporarily Abandoned Wells: N/A
- D. Disposal Wells: N/A

- E. Producing Wells: N/A
- F. Shut-in: N/A
- G. Injection Wells: N/A
- H. Monitoring or Observation Wells: N/A

IV. LOCATION OF EXISTING AND/OR PROPOSED FACILITIES AND CONSTRUCTION METHODS

A. Existing facilities owned or controlled by Lessee/Operator within one mile:

- 1. Tank batteries: N/A
- 2. Production facilities: N/A
- 3. Oil gathering lines: N/A
- 4. Gas gathering lines: N/A
- 5. Injection lines: N/A
- 6. Disposal lines: N/A

B. New facilities in the event of production:

- 1. New facilities may consist of a well head, storage tank, production unit, meter house, all of which would remain within the disturbed area.
- 2. All permanent facilities will be painted brown to blend in with surrounding environment.

C. Construction Methods

- 1. Refer to Exhibit 3 for pad topography and cross sections.
- 2. The location and proposed access road will be cleared prior to any construction. All dead trees from chaining activities will be disposed of by Tenneco. Stumps will be buried in areas designated by surface management agency or burned in reserve pit prior to placement of drilling facilities. If any burning is done, Tenneco will obtain a state burning permit and notify the San Juan County Health Department 24 hours in advance. Any stump left in place will be cut to a height not to exceed 12 inches. All slash less than four inches in diameter will be chipped and scattered outside of cleared area. All material four inches or greater diameter will be removed. Tenneco will provide the dirt contractor with a copy of the surface use plan prior to any surface disturbance.
- 3. Tenneco will immediately notify the San Juan Resource Area Manager of any and all cultural/historical resources discovered as a result of operations under this permit. All activities will be suspended in the area of any such object found and leave such discoveries intact until told to proceed by San Juan Resource Area Manager. Notice to proceed will be based upon evaluation of the cultural significance of the object. Evaluation of such object will be conducted by a qualified professional selected by San Juan Resource Area Manager from a

federal agency where possible and practical. When not practical, Tenneco will follow the mitigation requirements set forth by the San Juan Resource Area Manager concerning protection, preservation or disposition of any sites or material discovered. In those situations where the San Juan Resource Area Manager determines that data recovery and/or salvage excavations are necessary, Tenneco will bear the cost of such data recovery and/or salvage operations.

4. Land ownership: The planned site lies on fee surface.
 - : The planned access road lies on fee surface (+ 750' new road).
 5. Construction of pad will be conducted as follows: Topsoil will be stripped to a depth of 12 inches. Topsoil will then be stockpiled on the northwest corner of the location and identified in some manner to avoid accidental waste or improper usage. Pits will be constructed with soil materials native to site. Construction methods will be employed to assure that no drainage flows are impounded and to prevent the loss of any hydrocarbon from site. This will be done in a manner to facilitate rapid recovery and clean-up operations. Pits will be lined with bentonite (to prevent any possibility of seepage).
 6. Protective measures for wildlife and livestock:
Pits will be fenced on 3 (three sides) during drilling and on 4 (four sides) after completion to prevent entry of livestock or wildlife in the following manner; four strand barbed wire with metal post.
- D. Plans for re-habilitation of disturbed areas no longer needed for operations after construction and drilling completed.
1. Upon completion of well, areas required for continued use will be graded to provide drainage and minimize erosion. Those areas unnecessary for use will be graded to blend with the surrounding topography. Topsoil will be replaced on those areas and seeded according to the surface managing agency's specifications. See X C. Seeding will be completed after October 1 and before February 28. Landowner has requested restoration to be done in accordance with BLM standards, with the understanding that only crested wheatgrass be planted.

V. LOCATION AND TYPE OF WATER SUPPLY

- A. The water will be obtained from a legal private source:
City of Blanding

- B. Water transportation system: Water will be trucked to the location over existing roads.
- C. Water wells: N/A
A temporary use permit for acquisition of water will be obtained from the Utah State Engineer.

VI. SOURCE OF CONSTRUCTION MATERIALS

- A. Materials: Construction materials will consist of soil encountered within the boundaries.
- B. Materials foreign to site: N/A
- C. Refer to Exhibit #2 for access road detail.

- VII.
- A. Cuttings will be contained within the limits of the reserve pit.
 - B. Drilling fluids will be retained in the reserve pit.
 - C. Produced fluids: No substantial amount of produced water is anticipated. The amount of fluid hydrocarbons that may be produced while treating will be retained in the reserve pit. Prior to cleanup operations, the hydrocarbons will be skimmed or removed as the situation dictates.
 - D. Sewage: Sanitary facilities will consist of at least one chemical toilet and after completion of operations, the sewage will be removed and disposed of by subcontractor and hauled by truck to a sanitary land-fill.
 - E. Garbage: The small amount of refuse will be contained in a trash cage until operations are completed and then will be disposed of at a legal and environmentally safe location.
 - F. Clean up of well site: After drilling, the surface of the drill pad will be cleaned and graded to accommodate a completion rig. The mouse hole and rat hole will be backfilled to prevent injury and hazard for livestock and personnel. Reserve pit will be fenced until dry and then will be backfilled using native materials except topsoil, and contoured to natural terrain.

VIII. ANCILLARY FACILITIES

- A. N/A

IX. WELL SITE LAYOUT

- A. Refer to Exhibits**
1. Location of pits: 3
 2. Rig Orientation: 3 & 4

X. PLANS FOR RESTORATION OF SURFACE

- A.** The San Juan Resource Area Manager will be notified at least 48 hours prior to commencing reclamation work.
- B.** Reserve Pit Clean-up: The pit will be fenced on three sides prior to rig release and maintained until clean-up. Prior to backfill operations, any hydrocarbon material on pit surface will be removed. The fluids contained in the pit shall be allowed to evaporate and then the pit shall be backfilled with soil excavated from the site (excluding any topsoil removed during construction). The restored surface of the reserve pit will be contoured to prevent impoundment of drainage flows. The gradient of the surface will be maintained to prevent sudden acceleration of drainage flows which could cause continued erosion of the surface. Following backfill completion, topsoil removed from the disturbed areas will be replaced in a uniform layer over surface. The reserve pit will be seeded per the landowner's request as specified under IV.D.1.
- C.** Restoration plans if production is developed: The reserve pit will be backfilled and restored as described in X B. In addition, those disturbed areas not required for production facilities will be contoured to approximate original topography. Tenneco will upgrade and maintain access roads as necessary to prevent soil erosion and accommodate year-round traffic. Topsoil will then be placed on those areas of pad not needed for operations, ripped or disked and seeded, per the following mix: 100% crested wheatgrass (to a depth of 12").

Tenneco will use certified seed. Seedbed will be prepared by disking or ripping following natural contours. Seed will be drilled on contour at depth no greater than 1/2 inch. In areas that cannot be drilled, we will broadcast at double the seeding rate and harrow the seed into the soil. Seeding will be completed after September 1 and prior to prolonged ground frost. Perennial vegetation will be established. Tenneco will perform any additional work necessary in the event of seeding failures.

Following final improvement and surfacing of that portion of new access road, the topsoil windrowed to each side of the alignment will be placed on cut slopes.

- D. Restoration plans if no production is developed: The reserve pit will be backfilled and restored as described in X B. Access road and location will be restored to approximate the original contours. During reclamation of site, fill material will be pushed into cuts and up over backslope. No water trapping depressions will be left. Topsoil will be distributed evenly over location and seeded according to the method, manner and type described in X C.
- E. Private surface restoration: The landowner, Preston Nielson, has requested restoration to be in accordance with BLM standards, with the understanding that only crested wheatgrass be planted.

XI. OTHER INFORMATION

- A. Surface Description: The topography is relatively sloping, with a fairly steep drainage (Big Canyon) west of the location. Vegetation includes crested wheatgrass, wild sunflower, and fourwing saltbush.
- B. Other Surface-Use Activities:
The predominant surface use is grazing.
- C. Proximity of Water, Dwelling and Historical Sites:
1. Water: There is a spring one (1) mile northwest.
2. Occupied Dwellings: None within one (1) mile.
3. Historical Sites: An archaeological reconnaissance survey has been performed for this location and access and the report will be on file with the appropriate area surface management agency.

XII. OPERATOR'S REPRESENTATIVE

Field personnel who can be contacted concerning compliance of this Surface Use Plan are as follows:

Denise Wilson
P.O. Box 3249
Englewood, CO 80155
(303) 740-2591

XIII. CERTIFICATION

I hereby certify that I, or persons under my direct supervision, have inspected the proposed drill site and access route; that I am familiar with the conditions as they actually exist; that the statements made in this plan are, to the best of my knowledge, true and correct; and that the work associated with the operations proposed herein will be performed by Tenneco Oil Company and its contractors and sub-contractors in conformity with this plan and the terms and conditions under which it is approved.

DATE: November 21, 1983

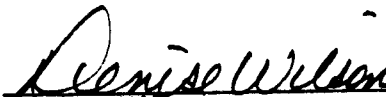
Denise Wilson Production Analyst
Denise Wilson

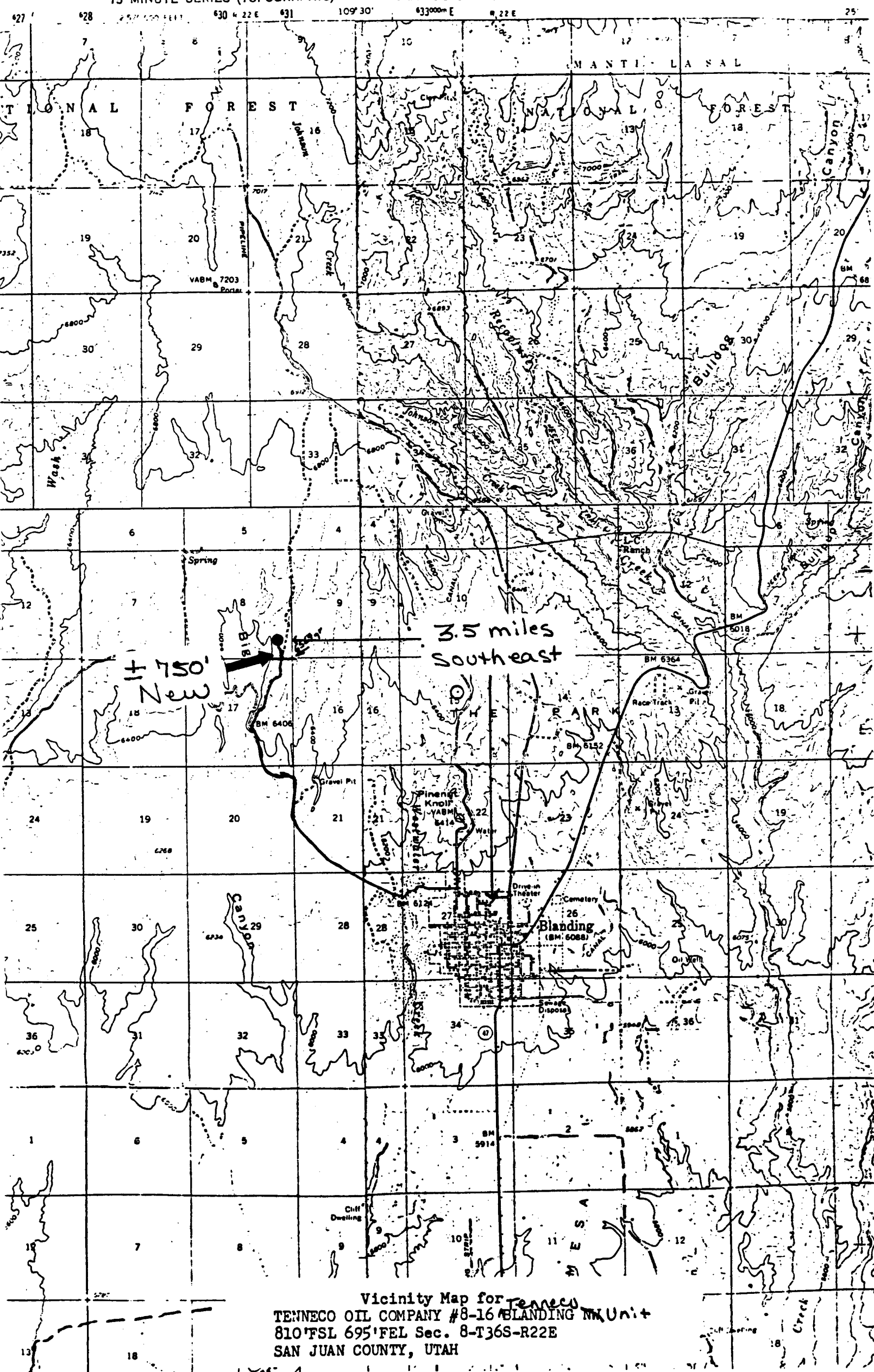

Vicinity Map for ~~Tenneco~~
TENNECO OIL COMPANY #8-16 BLANDING NM Unit
810' FSL 695' FEL Sec. 8-T36S-R22E
SAN JUAN COUNTY, UTAH

Profile for
 TENNECO OIL COMPANY #8-16 BLANDING NW Unit
 810' FSL 695' FEL Sec. 8-T36S-R22E
 SAN JUAN COUNTY, UTAH

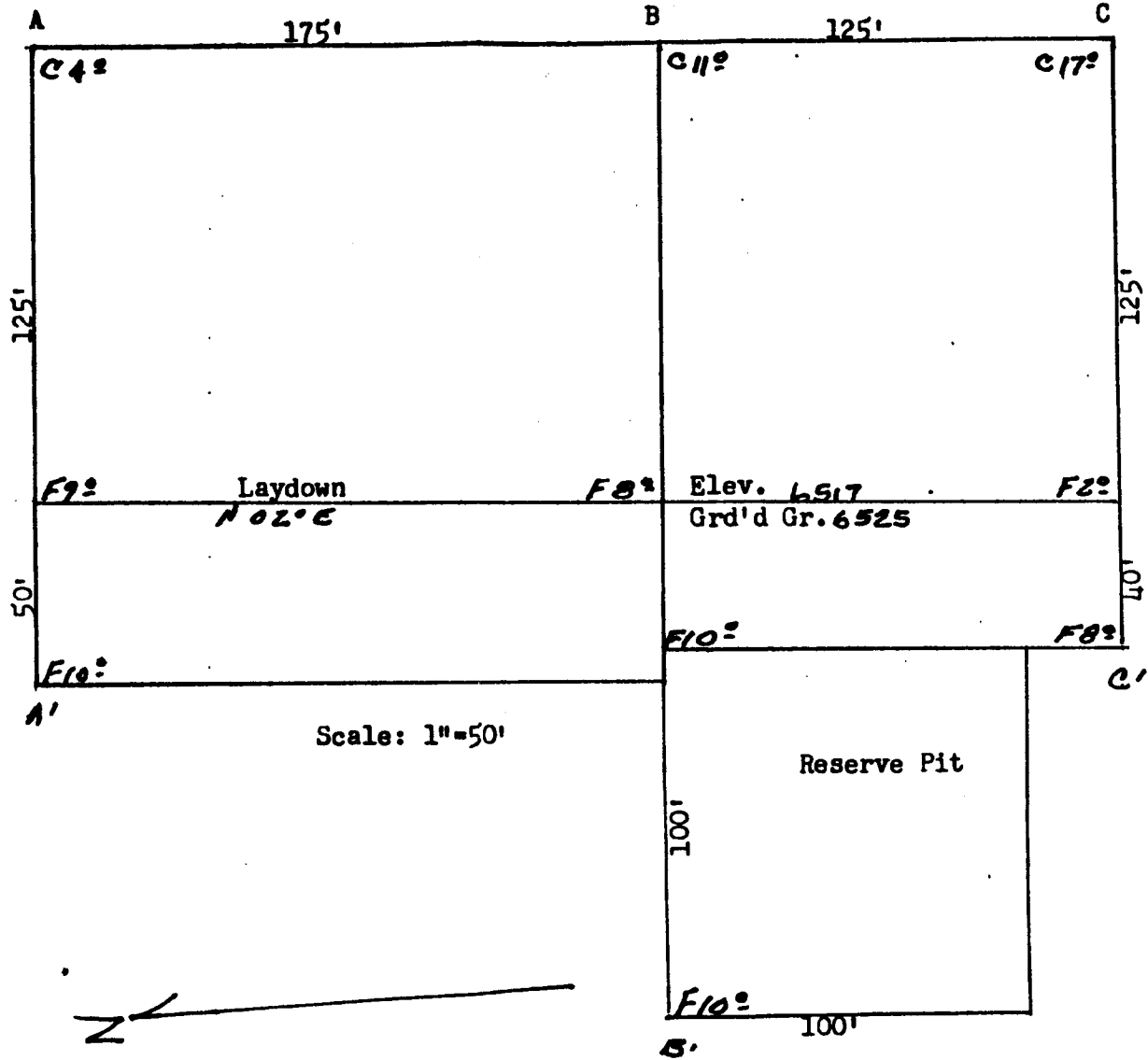

Scale: 1"=50'

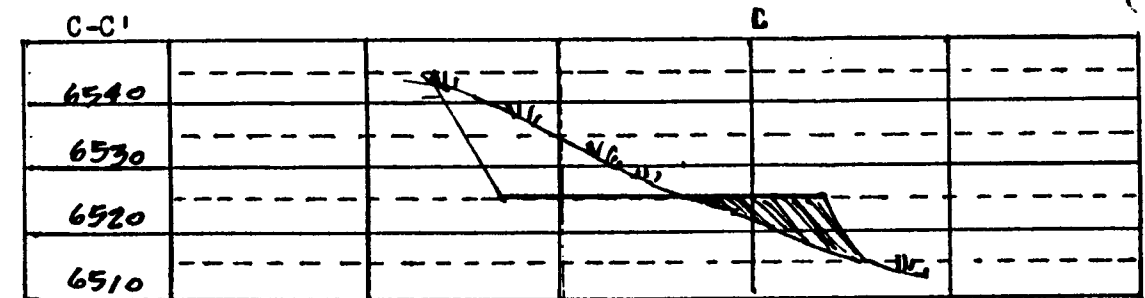
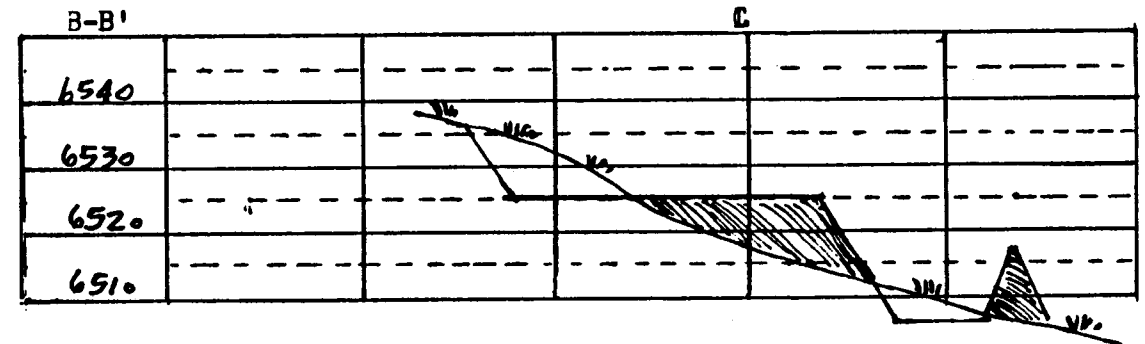
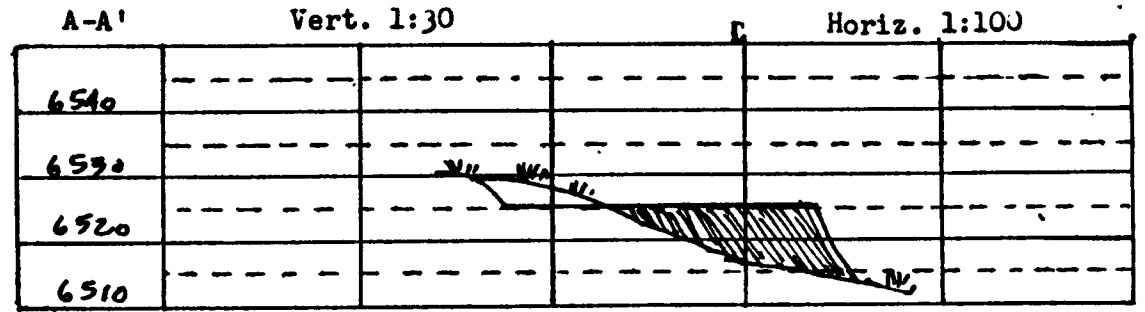

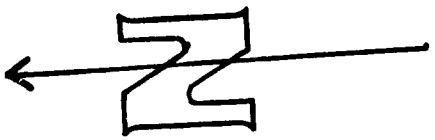
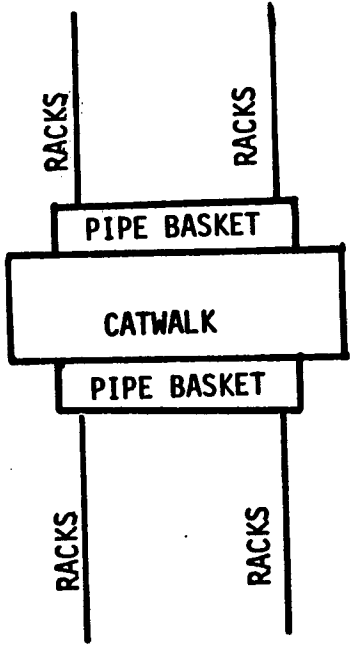
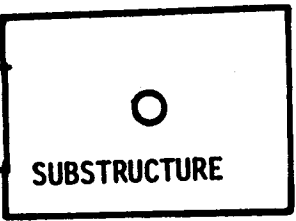
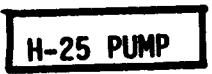
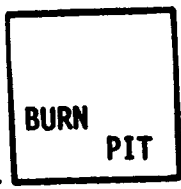
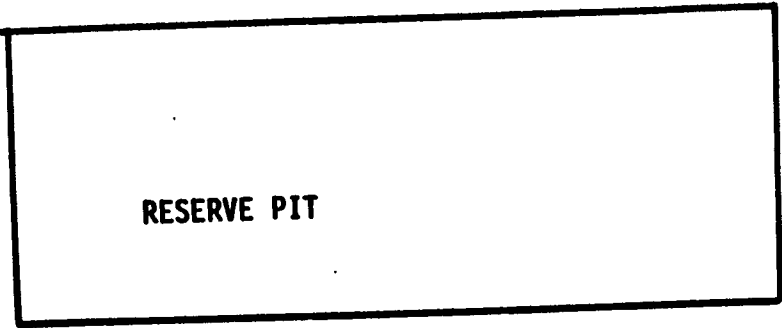

RIG LAYOUT

OPERATOR TENNECO OIL CO

DATE 11-29-83

WELL NAME TENNECO BLANDING UNIT # 8-16

SEC SESE 8 T 36 S R 22 E COUNTY SAN JUAN

43-037-30964
API NUMBER

FED
TYPE OF LEASE

POSTING CHECK OFF:

<input type="checkbox"/>	INDEX	<input type="checkbox"/>	MAP	<input type="checkbox"/>	HL
<input type="checkbox"/>	NID	<input type="checkbox"/>		<input type="checkbox"/>	PI

PROCESSING COMMENTS:

_____ 11-30-83

_____ *[Signature]*

CHIEF PETROLEUM ENGINEER REVIEW:

11/30/83

APPROVAL LETTER:

SPACING: A-3 BLANDING c-3-a _____
UNIT CAUSE NO. & DATE

c-3-b c-3-c

SPECIAL LANGUAGE:

WATER

_____ 4/28/84 Doug Bruner advised
of preparation to run
production casing. also
water permit verification
from City of Blanding.

RECONCILE WELL NAME AND LOCATION ON APD AGAINST SAME DATA ON PLAT MAP.

AUTHENTICATE LEASE AND OPERATOR INFORMATION

VERIFY ADEQUATE AND PROPER BONDING

AUTHENTICATE IF SITE IS IN A NAMED FIELD, ETC.

APPLY SPACING CONSIDERATION

ORDER _____

UNIT BLANSING

c-3-b

c-3-c

CHECK DISTANCE TO NEAREST WELL.

CHECK OUTSTANDING OR OVERDUE REPORTS FOR OPERATOR'S OTHER WELLS.

IF POTASH DESIGNATED AREA, SPECIAL LANGUAGE ON APPROVAL LETTER

IF IN OIL SHALE DESIGNATED AREA, SPECIAL APPROVAL LANGUAGE.

VERIFY LEGAL AND SUFFICIENT DRILLING WATER

November 30, 1983

Tenneco Oil Company
P. O. Box 3249
Englewood, Colorado 80155

RE: Tenneco Blanding Unit 8-16
SESE Sec. 8, T. 36S, R. 22E
810' FSL, 695' FEL
San Juan County, Utah

Gentlemen:

Insofar as this office is concerned, approval to drill the above referred to oil well is hereby granted in accordance with Section 40-6-11, Utah Code Annotated 1953; and predicated on Rule A-3, General Rules and Regulations and Rules of Practice and Procedure. Prior to spudding, a copy of the Utah Division of Water Rights (Phone No. 801-533-6071) approval for use or purchase of drilling water must be submitted to this office, otherwise this approval is void.

Should you determine that it will be necessary to plug and abandon this well, you are hereby requested to immediately notify the following:

RONALD J. FIRTH - Chief Petroleum Engineer
Office: 533-5771
Home: 571-6068

Enclosed please find Form OGC-8-X, which is to be completed whether or not water sands (aquifers) are encountered during drilling. Your cooperation in completing this form will be appreciated.

Further, it is requested that this Division be notified within 24 hours after drilling operations commence, and that the drilling contractor and rig number be identified.

The API number assigned to this well is 43-037-30964.

ONE:20064,

Norman C. Stout
Administrative Assistant

NCS/as
cc: Branch of Fluid Minerals
Encl.

UNITED STATES
DEPARTMENT OF THE INTERIOR
GEOLOGICAL SURVEY

5. LEASE DESIGNATION AND SERIAL NO.
U-23141

6. IF INDIAN, ALLOTTEE OR TRIBE NAME

7. UNIT AGREEMENT NAME
Blanding Unit

8. FARM OR LEASE NAME
Tenneco Blanding Unit

9. WELL NO.
8-16

10. FIELD AND POOL, OR WILDCAT
Wildcat

11. SEC., T., R., M., OR BLK. AND SURVEY OR AREA
Sec. 8, T36S, R22E

12. COUNTY OR PARISH
San Juan

13. STATE
Utah

17. NO. OF ACRES ASSIGNED TO THIS WELL
80

20. ROTARY OR CABLE TOOLS
Rotary

22. APPROX. DATE WORK WILL START*
12/1/83

APPLICATION FOR PERMIT TO DRILL, DEEPEN, OR PLUG BACK

1a. TYPE OF WORK
DRILL DEEPEN PLUG BACK

b. TYPE OF WELL
OIL WELL GAS WELL OTHER
SINGLE ZONE MULTIPLE ZONE

2. NAME OF OPERATOR
Tenneco Oil Company

3. ADDRESS OF OPERATOR
P.O. Box 3249, Englewood, CO 80155

4. LOCATION OF WELL (Report location clearly and in accordance with any State requirements.)*
At surface
810' FSL, 695' FEL
At proposed prod. zone
Same as above

14. DISTANCE IN MILES AND DIRECTION FROM NEAREST TOWN OR POST OFFICE*
Approximately 2 miles NW of Blanding, Utah

15. DISTANCE FROM PROPOSED* LOCATION TO NEAREST PROPERTY OR LEASE LINE, FT. (Also to nearest drlg. unit line, if any) 695'

16. NO. OF ACRES IN LEASE
1904.8

18. DISTANCE FROM PROPOSED LOCATION* TO NEAREST WELL, DRILLING, COMPLETED, OR APPLIED FOR, ON THIS LEASE, FT.
6371'

19. PROPOSED DEPTH
6371'

20. ROTARY OR CABLE TOOLS
Rotary

21. ELEVATIONS (Show whether DF, RT, GR, etc.)
6517' GR

22. APPROX. DATE WORK WILL START*
12/1/83

PROPOSED CASING AND CEMENTING PROGRAM

SIZE OF HOLE	SIZE OF CASING	WEIGHT PER FOOT	SETTING DEPTH	QUANTITY OF CEMENT
17-1/2"	13-3/8"	54.5#	+ 225'	Circulate to surface
11"	8-5/8"	24#	+ 2400'	Circulate to surface
8-3/4"	5-1/2"	17#	+ 6371'	Circulate to cover all possible productive zones

The gas is dedicated.

See attached.

Tenneco respectfully requests this well to be placed on a confidential status. An agreement has been reached with the surface owners regarding restoration. They request restoration to be done in accordance with BLM standards, with the stipulation that only crested wheatgrass be planted.

CONFIDENTIAL

IN ABOVE SPACE DESCRIBE PROPOSED PROGRAM: If proposal is to deepen or plug back, give data on present productive zone and proposed new productive zone. If proposal is to drill or deepen directionally, give pertinent data on subsurface locations and measured and true vertical depth. Give blowout preventer program, if any.

24. SIGNED Denise Wilson TITLE Production Analyst DATE 11/21/83

(This space for Federal or State office use)

PERMIT NO. _____ APPROVAL DATE _____

APPROVED BY Dennis Padine TITLE District Mgr. DATE 12/1/83

CONDITIONS OF APPROVAL, IF ANY:

RECEIVED
 DISTRICT OFFICE
 NOV 23 AM 9
 RECEIVED
 DISTRICT OFFICE
 DEC -21 AM 9
 RECEIVED
 DISTRICT OFFICE
 NOV 30 AM 9

REC'D. MDONOV 30 1983

ALJ

CONDITIONS OF APPROVAL FOR NOTICE TO WELL

Company Tenneco Oil Company Well No. 8-16
Location Sec. 8, T. 36 S., R. 22 E. Lease No. U-23141

**A COPY OF THESE CONDITIONS SHOULD BE FURNISHED YOUR
FIELD REPRESENTATIVE TO INSURE COMPLIANCE**

All lease and/or unit operations are to be conducted in such a manner that full compliance is made with the applicable laws, regulations (30 CFR 221), and the approved plan of operations. The operator is considered fully responsible for the actions of his subcontractors. The following items are emphasized:

1. There shall be no deviation from the proposed drilling and/or workover program as approved. Safe drilling and operating practices must be observed. All wells, whether drilling producing, suspended, or abandoned shall be identified in accordance with 30 CFR 221.22. Any changes in operations must have prior approval of this office. Pressure tests are required before drilling out from under all casing strings set and cemented in place. Blowout preventer controls must be installed prior to drilling the surface casing plug and will remain in use until the well is completed or abandoned. Preventers will be inspected and operated at least daily to insure good mechanical working order, and this inspection recorded on the daily drilling report. Preventers will be pressure tested before drilling casing cement plugs. All BOP pressure tests must be recorded on the daily drilling report.
2. All shows of fresh water and minerals will be reported and protected. A sample will be taken of any water flows and furnished this office for analysis. All oil and gas shows will be adequately tested for commercial possibilities, reported and protected.
3. No location will be constructed or moved, no well will be plugged, and no drilling or workover equipment will be removed from a well to be placed in a suspended status without prior approval of this office. If operations are to be suspended, prior approval of this office must be obtained and notification given before resumption of operations.

In the event abandonment of the hole is desired, an oral request may be granted by this office, but must be timely followed within 15 days with a "Notice of Intention to Abandon" (Form 9-331). Unless the plugging is to take place immediately upon receipt of oral approval, the District Manager must be notified at least 48 hours in advance of the plugging of the well in order that a representative may witness plugging operation. If a well is suspended or abandoned, all pits must be fenced immediately until they are backfilled. The "Subsequent Report of Abandonment" (Form 9-331) must be submitted within 15 days after the actual plugging of the well bore, reporting where the plugs were placed, and the current status of the surface restoration. If surface restoration has not been completed at that time, a follow-up report on form 9-331 should be filed when all surface restoration has been completed and the location is considered ready for final inspection.

4. The spud date will be reported orally to the respective District Manager's office within 48 hours after spudding. If the spudding occurs on a weekend or holiday, wait until the following regular workday to make this report.

Periodic drilling progress reports must be filed directly with the District Manager's office on a frequency and form or method as may be acceptable to the District Manager.

In accordance with NTL-1, this well must be reported on Form 9-329 "Monthly Report of Operations", starting with the month in which operations commence and continue each month until the well is physically plugged and abandoned. This report should be filed, in duplicate, directly with Royalty Management Accounting Center, Minerals Management Service, P. O. Box 2859, Casper, Wyoming 82602.

Any change in the program must be approved by the District Manager. "Sundry Notices and Reports on Wells" (form 9-331) must be filed for all changes of plans and other operations in accordance with 30 CFR 221.58. Emergency approval may be obtained orally, but such approval does not waive the written report requirement. Any additional construction, reconstruction, or alteration of facilities, including roads, gathering lines, batteries, etc., which will result in the disturbance of new ground will require the filing of a suitable plan pursuant to NTL-6, and prior approval by the District Manager.

5. Whether the well is completed as a dry hole or as a producer, "Well Completion and Recompletion Report and Log" (form 9-330) will be submitted not later than 15 days after completion of the well or after completion of operations being performed, in accordance with 30 CFR 221.59. Two copies of all logs run, core descriptions, core analyses, well-test data, geologic summaries, sample descriptions, and all other surveys or data obtained and compiled during the drilling, workover, and/or completion operations, will be filed with form 9-330. Samples (cuttings, fluid, and/or gas) will be submitted only when requested by this office.
6. Significant surface values (are) (are not) involved at this location. Accordingly, you (must) (need not) notify at least (24) (48) hours prior to commencing field operations to allow this office to have personnel present for consultation during the construction of roads and locations.

Your contact with the District Office is: ~~Lynn Jackson~~ ROBERT (BOB) GRAFF

Office Phone: 801-259-6111 Ext ~~240~~ 216 Home Phone: _____

City: Moab State: Utah

Resource Area Manager's Address and contacts are:

Address: 480 South First West, P.O. Box 7, Monticello, Utah 84535

Your contact is: Brian Wood

Office Phone: 801-587-2201 Home Phone: 801-587-2087

7. SURFACE OPERATING STANDARDS

Unless otherwise specified herein, construction and maintenance of surface facilities approved under this plan shall be in accordance with the guidelines set forth in the BLM/FS/GS Oil and Gas Brochure entitled, "Surface Operating Standards for Oil and Gas Exploration and Development". This includes but is not limited to such items as road construction and maintenance, handling of top soil and rehabilitation.

8. If a replacement rig is contemplated for completion operations, a "Sundry Notice" to that effect must be filed, for prior approval of the District Manager, and all conditions of this approved plan are applicable during all operations conducted with the replacement rig.
9. Pursuant to NTL-2B requirements regarding disposal facilities for new wells, this is authorization for unlined pit disposal of the water produced from this well for a period of 90 days from the date of initial production for sales purposes. During this period, an application for approval of the permanent disposal method, along with the required water analysis and other information must be submitted for the District Manager's approval. Failure to timely file an application within the time allowed will be considered an incident of noncompliance, and will be grounds for issuing a shut-in order until the application is submitted.
10. This permit is valid for a period of one year from the date of approval. If construction does not commence within 90 days from approval, the operator must contact this office 15 days prior to beginning construction. Construction under adverse conditions may require additional stipulations. If the permit terminates, any surface disturbance created under the application must be rehabilitated in accordance with the approved plan. After termination, it is required that a new application be filed for approval for any future operations.
11. If a tank battery is constructed on this lease, it must be surrounded by a fire wall of sufficient capacity to adequately contain the storage capacity of the battery.
12. This Application for Permit to Drill is approved subject to the requirement that, should the well be successfully completed for production, this office must be notified when it is placed in a producing status. Such notification will be by telegram or other written communication, and must be received in this office by not later than the first business day next following the date on which the well is placed on production. The notification shall provide, as a minimum, the following informational items:
 - a. Operator name, address and telephone number.
 - b. Well name and number.
 - c. Well location (1/4, 1/4, Section, Township, Range and Prime Meridian).
 - d. Date was placed in a producing status.
 - e. The nature of the well's production, i.e. crude oil, or crude oil and casinghead gas, or natural gas and entrained liquid hydrocarbons.

- f. The OCS, Federal or Indian lease prefix and number on which the well is located. Otherwise, the non-Federal or non-Indian land category, i.e. State or private.
- g. If appropriate, the unit agreement name, number and participating area name.
- h. If appropriate, the communitization agreement number.

13.

SUPPLEMENTAL STIPULATIONS OF APPROVAL ATTACHED

ADDITIONAL STIPULATIONS FOR PRODUCTION FACILITIES

Your Application for Permit to Drill also included a submittal for production facilities. These production facilities are approved for the lessee and his designated operator under Section 1 of the Oil and Gas Lease with the following conditions:

(1) The oil and gas measurement facilities must be installed on the well location. The oil and gas meters will be calibrated in place prior to any deliveries. Tests for meter accuracy are to be conducted monthly for the first three months on new meter installations and at least quarterly thereafter. Please provide this office with a date and time for the initial meter calibration and all future meter proving schedules. A copy of the meter calibration reports are to be submitted to the Salt Lake City District Oil and Gas Supervisor. Royalty payments will be made on all production volume as determined by the meter measurements or the tank measurements. All measurement facilities must conform with the API standards for liquid hydrocarbons and the AGA standard for natural gas measurement.

(2) Gas meter runs for each well will be located within 500 feet of the wellhead. The gas flowline will be buried from the wellhead to the meter and 500 feet downstream of the meter run or any production facilities. Meter runs must be housed and/or fenced.

(3) All disturbed areas not required for operations will be rehabilitated.

(4) All produced liquids must be contained including the dehydrator vent/condensate line effluent. All production pits must be fenced.

(5) The well activity, the well status and the date the well is placed on production must be reported on Lessee's Monthly Report of Operations, Form 9-329.

(6) All off-lease storage, off-lease measurement, or commingling on lease or off-lease must have written approval.

(7) All product lines entering and leaving hydrocarbon storage tanks must be locked/sealed.

(8) You are reminded of the requirements for handling, storing, or disposing of water produced from oil and gas wells under NTL-2B.

(9) All materials, trash, junk, debris, etc. not required for production must be removed from the well site and production facility site at the completion of these operations.

(10) A copy of the Gas Sales Contract will be provided to this office and the Royalty Accounting Department as directed.

(11) Construction and maintenance for surface use approved under this plan should be in accordance with the surface use standards as set forth in the BLM/GS Oil and Gas Brochure entitled, "Surface Operating Standards for Oil and Gas Exploration and Development." This includes, but is not limited to, such items as road construction and maintenance, handling of top soil and rehabilitation.

(12) "Sundry Notice and Reports on Wells" (form 9-331) will be filed for all changes of plans and other operations in accordance with 30 CFR 221.58. Emergency approval may be obtained verbally, but such approval does not waive the written report requirement. Any additional construction, reconstruction, or alternations of facilities, including roads, gathering lines, batteries, measurement facilities, etc., will require the filing of a suitable plan and prior approval by the survey.

UNITED STATES
DEPARTMENT OF THE INTERIOR
GEOLOGICAL SURVEY

APPLICATION FOR PERMIT TO DRILL, DEEPEN, OR PLUG BACK

1a. TYPE OF WORK
 DRILL DEEPEN PLUG BACK

b. TYPE OF WELL
 OIL WELL GAS WELL OTHER SINGLE ZONE MULTIPLE ZONE

2. NAME OF OPERATOR
 Tenneco Oil Company

3. ADDRESS OF OPERATOR
 P.O. Box 3249, Englewood, CO 80155

4. LOCATION OF WELL (Report location clearly and in accordance with any State requirements.)*
 At surface
 810' FSL, 695' FEL
 At proposed prod. zone
 Same as above

5. LEASE DESIGNATION AND SERIAL NO.
 U-23141

6. IF INDIAN, ALLOTTEE OR TRIBE NAME

7. UNIT AGREEMENT NAME
 Blanding Unit

8. FARM OR LEASE NAME
 Tenneco Blanding Unit

9. WELL NO.
 8-16

10. FIELD AND POOL, OR WILDCAT
 Wildcat

11. SEC., T., R., M., OR BLK. AND SURVEY OR AREA
 Sec. 8, T36S, R22E

12. COUNTY OR PARISH
 San Juan

13. STATE
 Utah

14. DISTANCE IN MILES AND DIRECTION FROM NEAREST TOWN OR POST OFFICE*
 Approximately 2 miles NW of Blanding, Utah

15. DISTANCE FROM PROPOSED* LOCATION TO NEAREST PROPERTY OR LEASE LINE, FT. (Also to nearest drlg. unit line, if any)
 695'

16. NO. OF ACRES IN LEASE
 1904.8

17. NO. OF ACRES ASSIGNED TO THIS WELL
 80

18. DISTANCE FROM PROPOSED LOCATION* TO NEAREST WELL, DRILLING, COMPLETED, OR APPLIED FOR, ON THIS LEASE, FT.

19. PROPOSED DEPTH
 6371'

20. ROTARY OR CABLE TOOLS
 Rotary

21. ELEVATIONS (Show whether DF, RT, GR, etc.)
 6517' GR

22. APPROX. DATE WORK WILL START*
 12/1/83

DIVISION OF
OIL, GAS & MINING

PROPOSED CASING AND CEMENTING PROGRAM

SIZE OF HOLE	SIZE OF CASING	WEIGHT PER FOOT	SETTING DEPTH	QUANTITY OF CEMENT
17-1/2"	13-3/8"	54.5#	+ 225'	Circulate to surface
11"	8-5/8"	24#	+ 2400'	Circulate to surface
8-3/4"	5-1/2"	17#	+ 6371'	Circulate to cover all possible productive zones

The gas is dedicated.

See attached.

Tenneco respectfully requests this well to be placed on a confidential status. An agreement has been reached with the surface owners regarding restoration. They request restoration to be done in accordance with BLM standards, with the stipulation that only crested wheatgrass be planted.

CONFIDENTIAL

IN ABOVE SPACE DESCRIBE PROPOSED PROGRAM: If proposal is to deepen or plug back, give data on present productive zone and proposed new productive zone. If proposal is to drill or deepen directionally, give pertinent data on subsurface locations and measured and true vertical depths. Give blowout preventer program, if any.

24. SIGNED *Denise Wilson* TITLE Production Analyst DATE 11/21/83

(This space for Federal or State office use)

PERMIT NO. _____ APPROVAL DATE _____

APPROVED BY /s/ GENE NODINE TITLE DISTRICT MANAGER DATE DEC 01 1983

CONDITIONS OF APPROVAL, IF ANY:

CONDITIONS OF APPROVAL ATTACHED

FLARING OR VENTING
GAS IS SUBJECT OF NTL 4-A
DATED 1/1/80

REC'D. MDONOV 30 1983

COMPANY TENNECO OIL COMPANY

LEASE BLANDING NW Unit WELL NO. 8-16

SEC. 8, T. 36S, R. 22E
SAN JUAN COUNTY, UTAH

LOCATION 810' FSL 695' FEL

ELEVATION 6517 ungraded ground

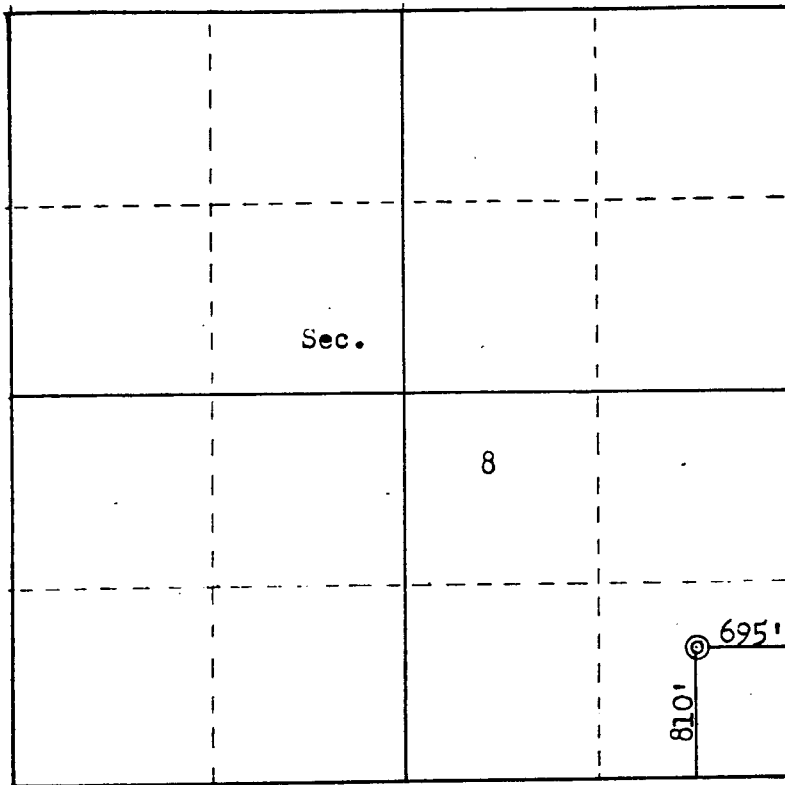

SCALE—4 INCHES EQUALS 1 MILE

THIS IS TO CERTIFY THAT THE ABOVE PLAT WAS PREPARED FROM FIELD NOTE OF ACTUAL SURVEYS MADE BY ME UNDER MY SUPERVISION AND THAT THE SAME ARE TRUE AND CORRECT TO THE BEST OF MY KNOWLEDGE AND BELIEF.

SEAL:

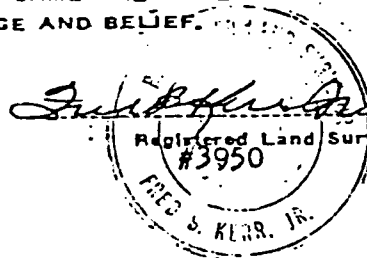

SURVEYED October 31, 1983

Tenneco Oil Company
Well No. 8-16
Sec. 8, T. 36 S., R. 22 E.
San Juan, County
Lease U-23141

Supplemental Stipulation:

1. Adequate and sufficient electric/radioactive logs will be run to locate and identify anticipated coal beds in the Dakota Sandstone. Casing and cementing programs will be adjusted to eliminate any potential influence of the well bore or productive hydrocarbon zones on the coal resource. Surface casing program may require adjustment for protection of fresh water aquifers.

CONDITIONS OF APPROVAL FOR NOTICE TO DRILL

Company Tenneco Oil Company

Well No. 8-16

Location Sec. 8, T. 36 S., R. 22 E.

Lease No. U-23141

**A COPY OF THESE CONDITIONS SHOULD BE FURNISHED YOUR
FIELD REPRESENTATIVE TO INSURE COMPLIANCE**

All lease and/or unit operations are to be conducted in such a manner that full compliance is made with the applicable laws, regulations (30 CFR 221), and the approved plan of operations. The operator is considered fully responsible for the actions of his subcontractors. The following items are emphasized:

1. There shall be no deviation from the proposed drilling and/or workover program as approved. Safe drilling and operating practices must be observed. All wells, whether drilling producing, suspended, or abandoned shall be identified in accordance with 30 CFR 221.22. Any changes in operations must have prior approval of this office. Pressure tests are required before drilling out from under all casing strings set and cemented in place. Blowout preventer controls must be installed prior to drilling the surface casing plug and will remain in use until the well is completed or abandoned. Preventers will be inspected and operated at least daily to insure good mechanical working order, and this inspection recorded on the daily drilling report. Preventers will be pressure tested before drilling casing cement plugs. All BOP pressure tests must be recorded on the daily drilling report.
2. All shows of fresh water and minerals will be reported and protected. A sample will be taken of any water flows and furnished this office for analysis. All oil and gas shows will be adequately tested for commercial possibilities, reported and protected.
3. No location will be constructed or moved, no well will be plugged, and no drilling or workover equipment will be removed from a well to be placed in a suspended status without prior approval of this office. If operations are to be suspended, prior approval of this office must be obtained and notification given before resumption of operations.

In the event abandonment of the hole is desired, an oral request may be granted by this office, but must be timely followed within 15 days with a "Notice of Intention to Abandon" (Form 9-331). Unless the plugging is to take place immediately upon receipt of oral approval, the District Manager must be notified at least 48 hours in advance of the plugging of the well in order that a representative may witness plugging operation. If a well is suspended or abandoned, all pits must be fenced immediately until they are backfilled. The "Subsequent Report of Abandonment" (Form 9-331) must be submitted within 15 days after the actual plugging of the well bore, reporting where the plugs were placed, and the current status of the surface restoration. If surface restoration has not been completed at that time, a follow-up report on form 9-331 should be filed when all surface restoration has been completed and the location is considered ready for final inspection.

4. The spud date will be reported orally to the respective District Manager's office within 48 hours after spudding. If the spudding occurs on a weekend or holiday, wait until the following regular workday to make this report.

Periodic drilling progress reports must be filed directly with the District Manager's office on a frequency and form or method as may be acceptable to the District Manager.

In accordance with NTL-1, this well must be reported on Form 9-329 "Monthly Report of Operations", starting with the month in which operations commence and continue each month until the well is physically plugged and abandoned. This report should be filed, in duplicate, directly with Royalty Management Accounting Center, Minerals Management Service, P. O. Box 2859, Casper, Wyoming 82602.

Any change in the program must be approved by the District Manager. "Sunday Notices and Reports on Wells" (form 9-331) must be filed for all changes of plans and other operations in accordance with 30 CFR 221.58. Emergency approval may be obtained orally, but such approval does not waive the written report requirement. Any additional construction, reconstruction, or alteration of facilities, including roads, gathering lines, batteries, etc., which will result in the disturbance of new ground will require the filing of a suitable plan pursuant to NTL-6, and prior approval by the District Manager.

5. Whether the well is completed as a dry hole or as a producer, "Well Completion and Recompletion Report and Log" (form 9-330) will be submitted not later than 15 days after completion of the well or after completion of operations being performed, in accordance with 30 CFR 221.59. Two copies of all logs run, core descriptions, core analyses, well-test data, geologic summaries, sample descriptions, and all other surveys or data obtained and compiled during the drilling, workover, and/or completion operations, will be filed with form 9-330. Samples (cuttings, fluid, and/or gas) will be submitted only when requested by this office.
6. Significant surface values (are) (are not) involved at this location. Accordingly, you (must) (need not) notify at least (24) (48) hours prior to commencing field operations to allow this office to have personnel present for consultation during the construction of roads and locations.

Your contact with the District Office is: Lynn Jackson

Office Phone: 801-259-6111 Ext 248 Home Phone: _____

City: Moab State: Utah

Resource Area Manager's Address and contacts are:

Address: 480 South First West, P.O. Box 7, Monticello, Utah 84535

Your contact is: Brian Wood

Office Phone: 801-587-2201 Home Phone: 801-587-2087

7. SURFACE OPERATING STANDARDS

Unless otherwise specified herein, construction and maintenance of surface facilities approved under this plan shall be in accordance with the guidelines set forth in the BLM/FS/GS Oil and Gas Brochure entitled, "Surface Operating Standards for Oil and Gas Exploration and Development". This includes but is not limited to such items as road construction and maintenance, handling of top soil and rehabilitation.

8. If a replacement rig is contemplated for completion operations, a "Sundry Notice" to that effect must be filed, for prior approval of the District Manager, and all conditions of this approved plan are applicable during all operations conducted with the replacement rig.
9. Pursuant to NTL-2B requirements regarding disposal facilities for new wells, this is authorization for unlined pit disposal of the water produced from this well for a period of 90 days from the date of initial production for sales purposes. During this period, an application for approval of the permanent disposal method, along with the required water analysis and other information must be submitted for the District Manager's approval. Failure to timely file an application within the time allowed will be considered an incident of noncompliance, and will be grounds for issuing a shut-in order until the application is submitted.
10. This permit is valid for a period of one year from the date of approval. If construction does not commence within 90 days from approval, the operator must contact this office 15 days prior to beginning construction. Construction under adverse conditions may require additional stipulations. If the permit terminates, any surface disturbance created under the application must be rehabilitated in accordance with the approved plan. After termination, it is required that a new application be filed for approval for any future operations.
11. If a tank battery is constructed on this lease, it must be surrounded by a fire wall of sufficient capacity to adequately contain the storage capacity of the battery.
12. This Application for Permit to Drill is approved subject to the requirement that, should the well be successfully completed for production, this office must be notified when it is placed in a producing status. Such notification will be by telegram or other written communication, and must be received in this office by not later than the first business day next following the date on which the well is placed on production. The notification shall provide, as a minimum, the following informational items:
 - a. Operator name, address and telephone number.
 - b. Well name and number.
 - c. Well location (1/4, 1/4, Section, Township, Range and Prime Meridian).
 - d. Date was placed in a producing status.
 - e. The nature of the well's production, i.e. crude oil, or crude oil and casinghead gas, or natural gas and entrained liquid hydrocarbons.

- f. The OCS, Federal or Indian lease prefix and number on which the well is located. Otherwise, the non-Federal or non-Indian land category, i.e. State or private.
- g. If appropriate, the unit agreement name, number and participating area name.
- h. If appropriate, the communitization agreement number.

13.

SUPPLEMENTAL STIPULATIONS OF APPROVAL ATTACHED

ADDITIONAL STIPULATIONS FOR PRODUCTION FACILITIES

Your Application for Permit to Drill also included a submittal for production facilities. These production facilities are approved for the lessee and his designated operator under Section 1 of the Oil and Gas Lease with the following conditions:

- (1) The oil and gas measurement facilities must be installed on the well location. The oil and gas meters will be calibrated in place prior to any deliveries. Tests for meter accuracy are to be conducted monthly for the first three months on new meter installations and at least quarterly thereafter. Please provide this office with a date and time for the initial meter calibration and all future meter proving schedules. A copy of the meter calibration reports are to be submitted to the Salt Lake City District Oil and Gas Supervisor. Royalty payments will be made on all production volume as determined by the meter measurements or the tank measurements. All measurement facilities must conform with the API standards for liquid hydrocarbons and the AGA standard for natural gas measurement.
- (2) Gas meter runs for each well will be located within 500 feet of the wellhead. The gas flowline will be buried from the wellhead to the meter and 500 feet downstream of the meter run or any production facilities. Meter runs must be housed and/or fenced.
- (3) All disturbed areas not required for operations will be rehabilitated.
- (4) All produced liquids must be contained including the dehydrator vent/condensate line effluent. All production pits must be fenced.
- (5) The well activity, the well status and the date the well is placed on production must be reported on Lessee's Monthly Report of Operations, Form 9-329.
- (6) All off-lease storage, off-lease measurement, or commingling on lease or off-lease must have written approval.
- (7) All product lines entering and leaving hydrocarbon storage tanks must be locked/sealed.
- (8) You are reminded of the requirements for handling, storing, or disposing of water produced from oil and gas wells under NTL-2B.
- (9) All materials, trash, junk, debris, etc. not required for production must be removed from the well site and production facility site at the completion of these operations.
- (10) A copy of the Gas Sales Contract will be provided to this office and the Royalty Accounting Department as directed.
- (11) Construction and maintenance for surface use approved under this plan should be in accordance with the surface use standards as set forth in the BLM/GS Oil and Gas Brochure entitled, "Surface Operating Standards for Oil and Gas Exploration and Development." This includes, but is not limited to, such items as road construction and maintenance, handling of top soil and rehabilitation.
- (12) "Sundry Notice and Reports on Wells" (form 9-331) will be filed for all changes of plans and other operations in accordance with 30 CFR 221.58. Emergency approval may be obtained verbally, but such approval does not waive the written report requirement. Any additional construction, reconstruction, or alternations of facilities, including roads, gathering lines, batteries, measurement facilities, etc., will require the filing of a suitable plan and prior approval by the survey.

MAR 28 1984
UNITED STATES
DEPARTMENT OF THE INTERIOR
DIVISION OF GEOLOGICAL SURVEY

APPLICATION FOR PERMIT TO DRILL, DEEPEN, OR PLUG BACK

5. LEASE DESIGNATION AND SERIAL NO.
U-23141

6. IF INDIAN, ALLOTTEE OR TRIBE NAME

7. UNIT AGREEMENT NAME
Blanding Unit.

8. FARM OR LEASE NAME
TENNECO BLANDING UNIT

9. WELL NO.
8-16

10. FIELD AND POOL, OR WILDCAT

1a. TYPE OF WORK
DRILL DEEPEN PLUG BACK

b. TYPE OF WELL
OIL SINGLE ZONE MULTIPLE ZONE

DATE: 3-26-84
ATTN: ARLENE SOLLIS

Operator, 1625 Broadway 80202
r, COLO

As we discussed on the phone today. I'll be out of town the rest of the week - any questions or problems, pls call Curley Grimlie, Mgr of Operations 303/825-4771

Barbara Biggs

ance with any
2) Sec. 1
y, Utah
Same
OR POST OFFIC
st of
16. f
95'
19. f

*Operator Name Chg.
Please chge. Card, file, etc
Thank*

Is may
6S-R22E
18. STATE
Utah
ORE WILL START*
1984
face

23. PROPOSED CASING A

SIZE OF HOLE	SIZE OF CASING	WEIGHT PER FOOT
17 1/2"	13-3/8"	conductor
12 1/2"	9-5/8"	36#, K-55 ST&
8-3/4"	5 1/2"	15.5#, K-55 LT&C 6371' (TD)

Buckhorn Petroleum Co. hereby accepts from Tenneco Oil Co of Operator with respect to the subject well and locations of BLM and State approval. Copies of Designation Buckhorn are enclosed. Buckhorn is bonded for operation by Hartford Accident & Indemnity Company #4451609.

We propose to change the approved Plan of Operations submitted above and on the attached (hole size, casing and cement we anticipate using Coleman Drilling Co. rig #2; rig layout (10" Shaffer LWS 3000# WP hydraulic BOP) are attached.

Surface damages have been negotiated with the surface owner Blanding, 4-23-84 by Rod Smith.

Water & Purchases from City of Blanding 3/26/84

IN ABOVE SPACE DESCRIBE PROPOSED PROGRAM: If proposal is to deepen or plug back, give data on previous program. If proposal is to drill or deepen directionally, give pertinent data on subsurface locations and measured and true vertical depths. Give blowout preventer program, if any.

24. SIGNED Rodney D. Smith TITLE Petroleum Engineer DATE March 26, 1984
(This space for Federal or State office use)

PERMIT NO. _____ APPROVAL DATE _____ OF UTAH OIL, GAS, AND MINING DATE: _____ BY: _____

APPROVED BY THE STATE OF UTAH DIVISION OF OIL, GAS, AND MINING
DATE: _____ BY: _____
Operator change and change of Plan of Operation

MAR 28 1984

UNITED STATES
DEPARTMENT OF THE INTERIOR
DIVISION OF GEOLOGICAL SURVEY

APPLICATION FOR PERMIT TO DRILL, DEEPEN, OR PLUG BACK

1a. TYPE OF WORK
 DRILL DEEPEN PLUG BACK

b. TYPE OF WELL
 OIL WELL GAS WELL OTHER SINGLE ZONE MULTIPLE ZONE

2. NAME OF OPERATOR
 BUCKHORN PETROLEUM CO.

3. ADDRESS OF OPERATOR (Ste 1200 Dome Tower, 1625 Broadway 80202)
 P. O. Box 5928 T.A.; Denver, COLO 80217

4. LOCATION OF WELL (Report location clearly and in accordance with any State requirements.*)
 At surface 810' FSL & 695' FEL (SE $\frac{1}{4}$ SE $\frac{1}{4}$) Sec. 8-T36S-R22E
 San Juan County, Utah
 At proposed prod. zone Approx. Same 43-037-30964

14. DISTANCE IN MILES AND DIRECTION FROM NEAREST TOWN OR POST OFFICE*
 Approximately 3 miles northwest of Blanding, Utah

15. DISTANCE FROM PROPOSED* LOCATION TO NEAREST PROPERTY OR LEASE LINE, FT. (Also to nearest drlg. unit line, if any)
 695'

18. DISTANCE FROM PROPOSED LOCATION* TO NEAREST WELL, DRILLING, COMPLETED, OR APPLIED FOR, ON THIS LEASE, FT.
 6371'

21. ELEVATIONS (Show whether DF, RT, GR, etc.)
 6517' GL, est 6530' KB

23. PROPOSED CASING AND CEMENTING PROGRAM

SIZE OF HOLE	SIZE OF CASING	WEIGHT PER FOOT	SETTING DEPTH	QUANTITY OF CEMENT
17 $\frac{1}{2}$ "	13-3/8"	conductor	40' below GL	Redimix to surface
12 $\frac{1}{2}$ "	9-5/8"	36#,K-55 ST&C	to \pm 550' KB	300 sx 'B' (circ'd)
8-3/4"	5 $\frac{1}{2}$ "	15.5#,K-55 LT&C	6371' (TD)	375 sx 'H'

5. LEASE DESIGNATION AND SERIAL NO.
 U-23141

6. IF INDIAN, ALLOTTEE OR TRIBE NAME

7. UNIT AGREEMENT NAME
 Blanding Unit.

8. FARM OR LEASE NAME
 TENNECO BLANDING UNIT

9. WELL NO.
 8-16

10. FIELD AND POOL, OR WILDCAT
 wildcat / Ismay

11. SEC., T., R., M., OR BLK. AND SURVEY OR AREA
 SE $\frac{1}{4}$ SE $\frac{1}{4}$
 Sec. 8-T36S-R22E

12. COUNTY OR PARISH 13. STATE
 San Juan Utah

16. NO. OF ACRES IN LEASE 17. NO. OF ACRES ASSIGNED TO THIS WELL
 1904.8 80

19. PROPOSED DEPTH 20. ROTARY OR CABLE TOOLS
 6371' Rotary

22. APPROX. DATE WORK WILL START*
 April 9, 1984

Buckhorn Petroleum Co. hereby accepts from Tenneco Oil Company the responsibilities of Operator with respect to the subject well and location, and agrees to all stipulations of BLM and State approval. Copies of Designation of Agent from Tenneco to Buckhorn are enclosed. Buckhorn is bonded for operations on BLM lands nationwide by Hartford Accident & Indemnity Company #4451609.

We propose to change the approved Plan of Operations submitted by Tenneco as noted above and on the attached (hole size, casing and cement programs). At this time we anticipate using Coleman Drilling Co. rig #2; rig layout and equipment inventory (10" Shaffer LWS 3000# WP hydraulic BOP) are attached.

Surface damages have been negotiated with the surface owner, Mr. Preston Nielson of Blanding, 4-23-84 by Rod Smith.

IN ABOVE SPACE DESCRIBE PROPOSED PROGRAM: If proposal is to deepen or plug back, give data on present productive zone and proposed new productive zone. If proposal is to drill or deepen directionally, give pertinent data on subsurface locations and measured and true vertical depths. Give blowout preventer program, if any.

24. SIGNED Rodney D. Smith TITLE Petroleum Engineer DATE March 26, 1984
 (This space for Federal or State office use)

PERMIT NO. _____ APPROVAL DATE _____ APPROVED BY THE STATE OF UTAH OIL, GAS, AND MINING

APPROVED BY _____ TITLE _____ DATE: _____ BY: _____

DATE: 3/26/84
 BY: Rodney D. Smith
Operator change and change of Plan of Operation

BUCKHORN PETROLEUM CO.

#8-16 TENNECO BLANDING UNIT

API #43-037-30964

SE $\frac{1}{4}$ SE $\frac{1}{4}$ Sec. 8 - T36S - R22E

San Juan County, UTAH

CONFIDENTIAL

USA. U-23141

Attached to and made a part of Application for Permit to Drill, Deepen, or Plug Back (form 9-331C) dated 3-26-84

The surface hole (12 $\frac{1}{2}$ ") to 550' will be drilled with fresh water/circulated reserve pit, 8.3-8.6 ppg, visc 30-35. After setting surface casing, drill out and drill ahead with water/native mud as above, using high viscosity gel sweeps as needed to keep the hole clean. Mud-up will occur approximately 200' above the projected Ismay top; and the hole will be drilled to TD using a low solids, non-dispersed polymer gel system, 8.9-9.1 ppg, visc 32-36, WL 10-12.

Buckhorn's Representative.

Mr. Rodney D. Smith, Petroleum Engineer

BUCKHORN PETROLEUM CO. (1200 Dome Tower)

P. O. Box 5928 T.A. (1625 Broadway)

Denver, COLO 80217

Office Phone: 303/825-4771 (24-hr ans. serv.)

Residence: 303/278-2323

OR

Mr. D. D. 'Curley' Grimlie, Manager of Operations

BUCKHORN PETROLEUM CO. (as above)

Office Phone: 303/825-4771 (24-hr ans. serv.)

Residence: 303/238-9950

Mobile Phone: 303/628-7550

Our representative on location will be Doug Bruner. We plan to install a telephone on location for his use; and this number will be provided to you as soon as it is available.

Certification.

I hereby certify that I, or persons under my direct supervision, have inspected the proposed drillsite and access route; that I am familiar with the conditions that presently exist; that the statements made in this plan are, to the best of my knowledge, true and correct; and that the work associated with the operations proposed herein will be performed in conformity with this plan and the conditions under which it was approved.

Productive zones will be perforated, treated and tested. Gas will be flared during testing periods. Water produced during testing will be contained in the drilling reserve pit. All possible oil will be stored and sold.

Rodney D. Smith

3-26-84

C O L E M A N D R I L L I N G C O .

Drawer 3337
Farmington, New Mexico 87401
(505) 325-6892—24 hour
(505) 327-4935

DRILLING RIG INVENTORY

RIG # 2

RATED DEPTH CAPACITY 8,000 FEET WITH 4 1/2" DRILL PIPE

DERRICK: 127' LEE C. MOORE W/528,000 HOOK LOAD CAPACITY

SUBSTRUCTURE: LEE C. MOORE - 13' K.B.

DRAWWORKS: H-40 IDECO

ENGINES: 2 EACH V-8 71T DETROIT DIESEL

MUD PUMPS: OPI HDL 700 W/CATERPILLER D-379 TA AUXILIARY MUD PUMP
555 MAX. HP AT 1100 RPM IDECO MM600F
500 INT. HP AT 1100 RPM W/379 TA CATERPILLER
420 CONT. HP AT 1100 RPM

DESILTER: PIONEER 8 CONE CAPACITY 400 GPM

MUD TANK: 1 EACH 600 BBL. (42 GAL. PER BBL.) WORKING CAPACITY

WATER STORAGE: 1 EACH 480 BBL. (42 GAL. PER BBL.)

GENERATORS: 1 EACH 90 KW AC AND 1 EACH 100 KW AC

ROTARY TABLE: 23" IDECO

TRAVELING BLOCK: BREWSTER 5-36 250 TONS W/COMB. HOOK

SWIVEL: L. B. 200 EMSCO

BLOW OUT PREVENTER: 10" SHAFFER LWS 3000 WP HYDRAULIC

SPECIAL: CROWN-O-MATIC
SATALITE AUTOMATIC DRILLER
TONG TORQUE GAUGE
RATE OF PENETRATION RECORDER
SHALE SHAKER
TRAILER HOUSE
TWO-WAY RADIO

MAY, 1983

COLEMAN DRILLING CO.

FRONT OF RIG NO. 2

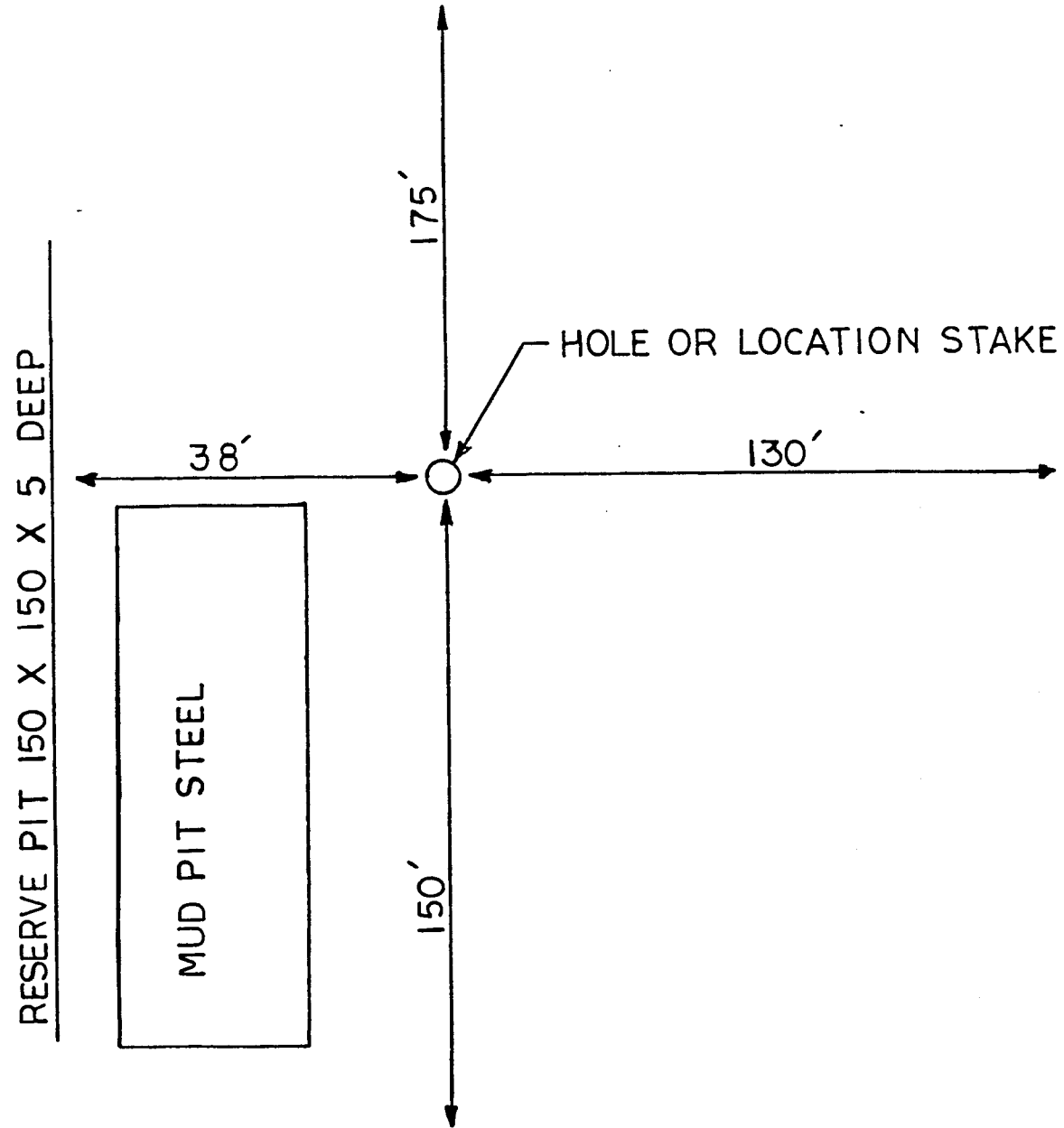

DESIGNATION OF AGENT

Chief, Branch of Fluid Minerals, Oil and Gas Operations:

The undersigned is, on the records of the Bureau of Land Management, Unit Operator under the Blanding Unit Agreement, San Juan County, Utah, No. 14-08-0001-21205 approved April 22, 1983 and hereby designates:

NAME: Buckhorn Petroleum Company

ADDRESS: P.O. Box 5928 T.A.
Denver, CO 80217

as its agent, with full authority to act in its behalf in complying with the terms of the Unit Agreement and regulations applicable thereto and on whom the Chief or his representative may serve written or oral instructions in securing compliance with the Oil and Gas Operating Regulations with respect to drilling, testing and completing unit well No. 8-16, in the SE/4SE/4 Section 8, Township 36 South, Range 22 East, S.L.M., San Juan County, Utah.

It is understood that this designation of agent does not relieve the Unit Operator of responsibility for compliance with the terms of the unit agreement and the Oil and Gas Operating Regulations. It is also understood that this designation of agent does not constitute an assignment of any interest under the unit agreement or any lease committed thereto.

In case of default on the part of the designated agent, the Unit Operator will make full and prompt compliance with all regulations, lease terms, or orders of the Secretary of the Interior or his representative.

The Unit Operator agrees promptly to notify the oil and gas supervisor of any change in the designated agent.

This designation of agent is deemed to be temporary and in no manner a permanent arrangement.

This designation is given only to enable the agent herein designated to drill the above-specified unit well. Unless sooner terminated, this designation shall terminate when there is filed in the appropriate district office of the Bureau of Land Management a completed file of all required Federal reports pertaining to subject well. It is also understood that this designation of agent is limited to field operations and does not cover administrative action requiring specific authorization of the Unit Operator.

TENNECO OIL COMPANY

RECEIVED

MAR 28 1984

DIVISION OF
OIL, GAS & MINING,

P.W. Cayce, Jr.

P.W. Cayce, Jr., Attorney-In-Fact

MSS

PA-10774

UNITED STATES
DEPARTMENT OF THE INTERIOR
GEOLOGICAL SURVEY

APPLICATION FOR PERMIT TO DRILL, DEEPEN, OR PLUG BACK

1a. TYPE OF WORK
 DRILL DEEPEN PLUG BACK

b. TYPE OF WELL
 OIL WELL GAS WELL OTHER
 SINGLE ZONE MULTIPLE ZONE

2. NAME OF OPERATOR
 BUCKHORN PETROLEUM CO.

3. ADDRESS OF OPERATOR (Ste 1200 Dome Tower, 1625 Broadway 80202)
 P. O. Box 5928 T.A.; Denver, COLO 80217

4. LOCATION OF WELL (Report location clearly and in accordance with any State requirements.*)
 At surface 810' FSL & 695' FEL (SE $\frac{1}{4}$ SE $\frac{1}{4}$) Sec. 8-T36S-R22E
 At proposed prod. zone San Juan County, Utah
 Approx. Same 43-037-30964

14. DISTANCE IN MILES AND DIRECTION FROM NEAREST TOWN OR POST OFFICE*
 Approximately 3 miles northwest of Blanding, Utah

15. DISTANCE FROM PROPOSED* LOCATION TO NEAREST PROPERTY OR LEASE LINE, FT. (Also to nearest drg. unit line, if any)
 695'

16. NO. OF ACRES IN LEASE
 1904.8

17. NO. OF ACRES ASSIGNED TO THIS WELL
 80

18. DISTANCE FROM PROPOSED LOCATION* TO NEAREST WELL, DRILLING, COMPLETED, OR APPLIED FOR, ON THIS LEASE, FT.

19. PROPOSED DEPTH
 6371'

20. ROTARY OR CABLE TOOLS
 Rotary

21. ELEVATIONS (Show whether DF, RT, GR, etc.)
 6517' GL, est 6530' KB

22. APPROX. DATE WORK WILL START*
 April 9, 1984

23. PROPOSED CASING AND CEMENTING PROGRAM

SIZE OF HOLE	SIZE OF CASING	WEIGHT PER FOOT	SETTING DEPTH	QUANTITY OF CEMENT
17 $\frac{1}{2}$ "	13-3/8"	conductor	40' below GL	Redimix to surface
12 $\frac{1}{2}$ "	9-5/8"	36#,K-55 ST&C	to \pm 550' KB	300 sx 'B' (circ'd)
8-3/4"	5 $\frac{1}{2}$ "	15.5#,K-55 LT&C	6371' (TD)	375 sx 'H'

Buckhorn Petroleum Co. hereby accepts from Tenneco Oil Company the responsibilities of Operator with respect to the subject well and location, and agrees to all stipulations of BLM and State approval. Copies of Designation of Agent from Tenneco to Buckhorn are enclosed. Buckhorn is bonded for operations on BLM lands nationwide by Hartford Accident & Indemnity Company #4451609.

We propose to change the approved Plan of Operations submitted by Tenneco as noted above and on the attached (hole size, casing and cement programs). At this time we anticipate using Coleman Drilling Co. rig #2; rig layout and equipment inventory (10" Shaffer LWS 3000# WP hydraulic BOP) are attached.

Surface damages have been negotiated with the surface owner, Mr. Preston Nielson of Blanding, 4-23-84 by Rod Smith.

CONFIDENTIAL

IN ABOVE SPACE DESCRIBE PROPOSED PROGRAM: If proposal is to deepen or plug back, give data on present productive zone and proposed new productive zone. If proposal is to drill or deepen directionally, give pertinent data on subsurface locations and measured and true vertical depths. Give blowout preventer program, if any.

24. SIGNED Rodney D. Smith TITLE Petroleum Engineer DATE March 26, 1984

(This space for Federal or State office use)

PERMIT NO. _____ APPROVAL DATE _____

APPROVED BY /S/ GENE NODINE TITLE DISTRICT MANAGER

CONDITIONS OF APPROVAL, IF ANY:
 AMENDMENT APPROVED WITH CONDITIONS RECOGNIZED BY APPROVAL OF TENNECO OIL COMPANY WELL #8-16 ON DECEMBER 1, 1983.

RECEIVED
 APR 11 1984
 FLARING OR VENTING OF GAS IS SUBJECT TO NTL 4-A
 DATED 1/1/80

CONDITIONS OF APPROVAL ATTACHED
 DIVISION OF OIL, GAS & MINING

COMPANY TENNECO OIL COMPANY

LEASE BLANDING NW Unit WELL NO. 8-16

SEC. 8, T. 36S, R. 22E
SAN JUAN COUNTY, UTAH

LOCATION 810' FSL 695' FEL

ELEVATION 6517 ungraded ground

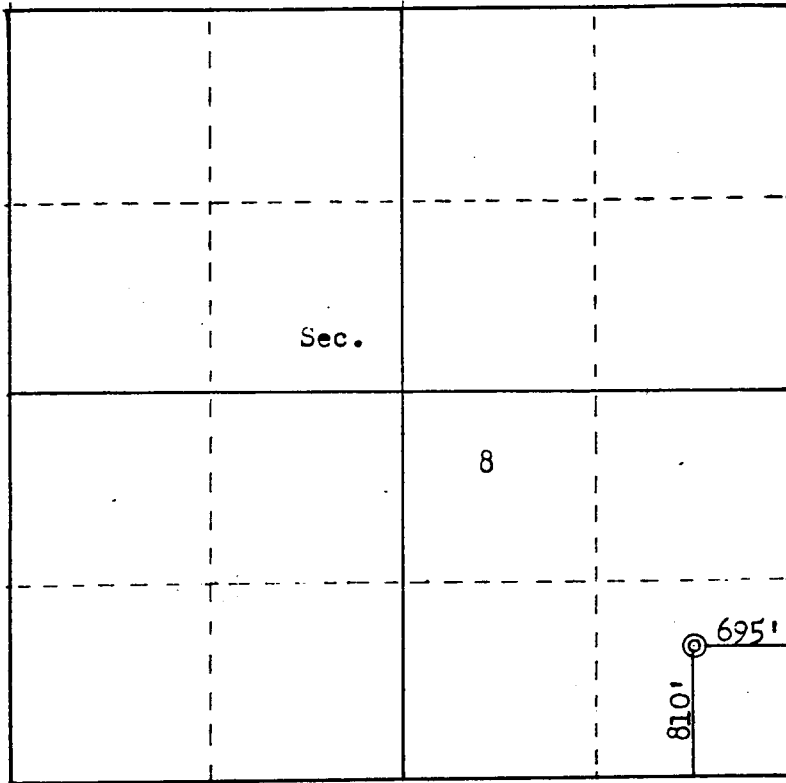

SCALE—4 INCHES EQUALS 1 MILE

THIS IS TO CERTIFY THAT THE ABOVE PLAT WAS PREPARED FROM FIELD NOTE OF ACTUAL SURVEYS MADE BY ME UNDER MY SUPERVISION AND THAT THE SAME ARE TRUE AND CORRECT TO THE BEST OF MY KNOWLEDGE AND BELIEF.

SEAL:

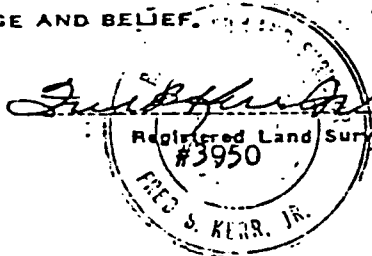

SURVEYED October 31 1983

CONFIDENTIAL

*Water
K*

DIVISION OF OIL, GAS AND MINING

SPUDDING INFORMATION

NAME OF COMPANY: BUCKHORN PETROLEUM COMPANY

WELL NAME: TENNECO BLANDING UNIT #8-16

SECTION SESE 8 TOWNSHIP 36S RANGE 22E COUNTY SAN JUAN COUNTY

DRILLING CONTRACTOR COLEMAN

RIG # 2

SPUDED: DATE 4-10-84

TIME 6:30 PM

How Rotary

DRILLING WILL COMMENCE _____

REPORTED BY Doug Brumer

TELEPHONE # _____

DATE 4-11-84 SIGNED RJF

UNITED STATES
DEPARTMENT OF THE INTERIOR
GEOLOGICAL SURVEY

SUNDRY NOTICES AND REPORTS ON WELLS

(Do not use this form for proposals to drill or to deepen or plug back to a different reservoir. Use Form 9-331-C for such proposals.)

1. oil well gas well other

2. NAME OF OPERATOR Harper Oil Company,
Successor by Merger to Buckhorn Petroleum Company

3. ADDRESS OF OPERATOR
P. O. Box 5928 T.A., Denver, CO 80217

4. LOCATION OF WELL (REPORT LOCATION CLEARLY. See space 17 below.)
AT SURFACE: 810' FSL & 695' FEL (SE/4 SE/4)
AT TOP PROD. INTERVAL: Same
AT TOTAL DEPTH: Same

16. CHECK APPROPRIATE BOX TO INDICATE NATURE OF NOTICE, REPORT, OR OTHER DATA

REQUEST FOR APPROVAL TO:		SUBSEQUENT REPORT OF:
TEST WATER SHUT-OFF	<input type="checkbox"/>	<input type="checkbox"/>
FRACTURE TREAT	<input type="checkbox"/>	<input type="checkbox"/>
SHOOT OR ACIDIZE	<input type="checkbox"/>	<input type="checkbox"/>
REPAIR WELL	<input type="checkbox"/>	<input type="checkbox"/>
PULL OR ALTER CASING	<input type="checkbox"/>	<input type="checkbox"/>
MULTIPLE COMPLETE	<input type="checkbox"/>	<input type="checkbox"/>
CHANGE ZONES	<input type="checkbox"/>	<input type="checkbox"/>
ABANDON*	<input type="checkbox"/>	<input type="checkbox"/>

(other) Report of Operations - 4/27/84 through 4/30/84

17. DESCRIBE PROPOSED OR COMPLETED OPERATIONS (Clearly state all pertinent details, and give pertinent dates, including estimated date of starting any proposed work. If well is directionally drilled, give subsurface locations and measured and true vertical depths for all markers and zones pertinent to this work.)*

Please see attached recaps of drilling operations 4/27/84 through 4/30/84.

RECEIVED
MAY 16 1984
DIVISION OF OIL
GAS & MINING

5. LEASE
U-23141

6. IF INDIAN, ALLOTTEE OR TRIBE NAME

7. UNIT AGREEMENT NAME
Blanding Unit

8. FARM OR LEASE NAME
Tenneco Blanding Unit

9. WELL NO.
#8-16

10. FIELD OR WILDCAT NAME.
Wildcat/Ismay

11. SEC., T., R., M., OR BLK. AND SURVEY OR AREA
SE SE Sec 3 T36S R22E

12. COUNTY OR PARISH | 13. STATE
San Juan | Utah

14. API NO.
43-037-30964

15. ELEVATIONS (SHOW DF, KDB, AND WD)
6517' GL 6530' KB

(NOTE: Report results of multiple completion or zone change on Form 9-330.)

Subsurface Safety Valve: Manu. and Type _____ Set @ _____ Ft.

18. I hereby certify that the foregoing is true and correct

SIGNED A. Nash, Jr. TITLE Operations Manager DATE May 4, 1984
A. Nash, Jr.
(This space for Federal or State office use)

APPROVED BY _____ TITLE _____ DATE _____
CONDITIONS OF APPROVAL IF ANY:

-27-84. 6307', TI FOR CORE #4. MADE 157'. 1 1/2 HRS LOGGING. CORE #5: D&L 6138-5900', 2-1/4 HRS TI W/BIT, 12-3/4 HRS DRLG, 3 HRS CIRC CORE #4, 2-1/2 HRS TRIP OR CORE BARREL, 1-1/2 HR PU CORE BARREL, 1-1/2 HRS TI. MW 9, VIS 40, WL 10, PH 11.5, FC 2/32, CL 500 PPM, CA 60 PPM, SAND 1/4, PV 11, YP 6, GEL 1/6, SOLIDS 4%, NITRATES 65. BIT #9, 8-3/4, STC, F3, (12-12-0). IN @ 6150', OUT @ 6307', MADE 157' IN 12-3/4 HRS, 12.3'/HR. T 3 B 2 G 1. BIT #10, 8-3/4, ACC, STAR, (DIAMOND). IN @ 6307'. SN 63127. BIT WT 45 M#, 65 RPM, 1800 PSI PMP PR, 60 SPM. BHA - CORE BARREL, X-O, JARS, X-O, BIT SUB, 21 DC'S, 2 JTS HWDP, 781.90'.

4-28-84 6337', TI W/BIT #11. MADE 30'. 3-3/4 HRS TI, 14 HRS CUT CORE #4, 3 HRS LD CORE & CORE BARREL, 3-1/4 HRS TO W/CORE. DRLG W/GEL-CHEM. MW 9.1, VIS 40, WL 12, PH 11.5, FC 2/32, CL 500 PPM, CA 50 PPM, SAND TR, PV 11, YP 5, GEL 1/7, SOLIDS 4.5%, NITRATES 85. BIT #10, 8-3/4, ACC, STAR, CORE BIT IN @ 6307', OUT @ 6337', MADE 30' IN 14 HRS, 2.1'/HR. SN 21127. BIT #11, 8-3/4, STC, F3, (12-0-12). IN @ 6337'. REMARKS: RR #5. BIT WT 22 M#, 80 RPM, 900 PSI PMP PR, 55 SPM. BHA - BIT, BIT SUB, 21 - 6-1/2 DC'S, 2 HWDP, 706'.

04-29-84 6389', TI FOR LOGS. MADE 52'. 5-3/4 HRS TRIPPING, 4 HRS DRLG, 4 HRS CIRC FOR LOGS, 10-1/4 HRS LOGGING. DRLG W/GEL-CHEM. MW 9.3, VIS 39, WL 11.6, PH 11.5, FC 2/32, CL 500 PPM, CA 100 PPM, SAND TR, PV 11, YP 6, GEL 2/5, SOLIDS 5%, NITRATES 65. BIT #11, 8-3/4, STC, F3, (12-0-12). IN @ 6337', OUT @ 6389', MADE 52' IN 4 HRS, 13'/HR. T 3 B 2 G 1. BIT WT 45 M#, 80 RPM, 1800 PSI PMP PR, 55 SPM. BHA - SAME, 706'.

04-30-84 6389', RD, MADE 0'. HOURLY BREAKDOWN: 1-1/2 HRS. TIH; 4-1/4 HRS. CIRC FOR CSG; 5-1/2 HRS. LDDP AND DC'S; 4-1/4 HRS. RAN 161 JTS 5-1/2", 17#, N-80, USED LT&C CSG. SA 6380'; 1/2 HR. CIRC CSG. NU HALLIBURTON PMPD 20 BBLS SAM 5 MUD FLUSH; 1 HR. CMT CSG W/600 SXS CLASS "H" W/3% KCL, .8 OF 1% HALAD, 4# NFP. PD @ 11:00 P.M., HAD GOOD RETURNS THROUGHOUT. RECIPROCATED PIPE WHILE CMTG; 4 HRS. ND, SET SLIPS, CUT OFF AND CLEANED MUD TANK; 3 HRS. RD. RIG RELEASED @ 3:00 A.M. 4-30-84. MW 9.3, VIS 43, WL 12, PH 11, FC 2/32, CL 500, Ca 100, PV 13, YP 8, GEL 3/8, Snd 1/4%, SOL 5%. 1800 psi PMP PR, SPM 55. BHA - LD.

CASING DETAIL:

5-1/2" HALCO GUIDE SHOE	.80'
1 JT 5-1/2", 17#, N-80, LT&C USED CSG.	39.72'
HALCO FLOAT COLLAR	1.75'
160 JTS 5-1/2", 17#, N-80 LT&C USED CSG	6346.58'
TOTALS	6388.85'
	ABOVE KB (8.85')
	CSG SA 6380.00' KB

DROP FROM REPORT UNTIL COMPLETION COMMENCES!

05-02-84 CLEANUP LOCATION. NU TBG SPOOL. TEST TO 1500# - O.K. SET ANCHORS.

05-03-84 MIRU WELLTECH COMPLETION UNIT. DAILY COST \$3,617 CUM. COMPLETION COST \$11,648

05-04-84 6335' PBDT, RU TO LOG. HOURLY BREAKDOWN: 2 HRS. RU AND WO TBG; 1 HR. UNLOAD 206 JTS 2-7/8", J-55, 6.5#, EUE TBG, STRAP SAME; 5

UNITED STATES
DEPARTMENT OF THE INTERIOR
GEOLOGICAL SURVEY

SUNDRY NOTICES AND REPORTS ON WELLS

(Do not use this form for proposals to drill or to deepen or plug back to a different reservoir. Use Form 9-331-C for such proposals.)

1. oil well gas well other

2. NAME OF OPERATOR Harper Oil Company,
Successor by Merger to Buckhorn Petroleum Company

3. ADDRESS OF OPERATOR
P. O. Box 5928 T.A., Denver, CO 80217

4. LOCATION OF WELL (REPORT LOCATION CLEARLY. See space 17 below.)
AT SURFACE: 810' FSL & 695' FEL (SE/4 SE/4)
AT TOP PROD. INTERVAL: Same
AT TOTAL DEPTH: Same

16. CHECK APPROPRIATE BOX TO INDICATE NATURE OF NOTICE, REPORT, OR OTHER DATA

REQUEST FOR APPROVAL TO:
TEST WATER SHUT-OFF
FRACTURE TREAT
SHOOT OR ACIDIZE
REPAIR WELL
PULL OR ALTER CASING
MULTIPLE COMPLETE
CHANGE ZONES
ABANDON*

SUBSEQUENT REPORT OF:

RECEIVED

MAY 16 1984

NOTE: Report results of multiple completion or zone change on Form 9-330.)

DIVISION OF OIL
GAS & MINING

(other) Report of Operations - 4/27/84 through 4/30/84

17. DESCRIBE PROPOSED OR COMPLETED OPERATIONS (Clearly state all pertinent details, and give pertinent dates, including estimated date of starting any proposed work. If well is directionally drilled, give subsurface locations and measured and true vertical depths for all markers and zones pertinent to this work.)*

Please see attached recaps of drilling operations 4/27/84 through 4/30/84.

Subsurface Safety Valve: Manu. and Type _____ Set @ _____ Ft.

18. I hereby certify that the foregoing is true and correct

SIGNED A. Nash, Jr. TITLE Operations Manager DATE May 4, 1984
A. Nash, Jr.
(This space for Federal or State office use)

APPROVED BY _____ TITLE _____ DATE _____
CONDITIONS OF APPROVAL IF ANY:

02-27-84

6307', TI FOR CORE #4. MADE 157' IN 12-3/4 HRS. T 3 B 2 G 1.
 #5: D&L 6138-5900', 2-1/4 HRS TI W/BIT, 12-3/4 HRS
 DRLG, 3 HRS CIRC FOR CORE #4, 2-1/2 HRS TRIP FOR CORE
 BARREL, 1-1/2 HR PU CORE BARREL, 1-1/2 HRS TI. MW 9,
 VIS 40, WL 10, PH 11.5, FC 2/32, CL 500 PPM, CA 60 PPM,
 SAND 1/4, PV 11, YP 6, GEL 1/6, SOLIDS 4%, NITRATES 65.
 BIT #9, 8-3/4, STC, F3, (12-12-0). IN @ 6150', OUT @
 6307', MADE 157' IN 12-3/4 HRS, 12.3'/HR. T 3 B 2 G 1.
 BIT #10, 8-3/4, ACC, STAR, (DIAMOND). IN @ 6307'. SN
 63127. BIT WT 45 M#, 65 RPM, 1800 PSI PMP PR, 60 SPM.
 BHA - CORE BARREL, X-O, JARS, X-O, BIT SUB, 21 DC'S, 2
 JTS HWDP, 781.90'.

04-28-84

6337', TI W/BIT #11. MADE 30'. 3-3/4 HRS TI, 14 HRS
 CUT CORE #4, 3 HRS LD CORE & CORE BARREL, 3-1/4 HRS TO
 W/CORE. DRLG W/GEL-CHEM. MW 9.1, VIS 40, WL 12, PH
 11.5, FC 2/32, CL 500 PPM, CA 50 PPM, SAND TR, PV 11,
 YP 5, GEL 1/7, SOLIDS 4.5%, NITRATES 85. BIT #10,
 8-3/4, ACC, STAR, CORE BIT IN @ 6307', OUT @ 6337', MADE
 30' IN 14 HRS, 2.1'/HR. SN 21127.
 BIT #11, 8-3/4, STC, F3, (12-0-12). IN @ 6337'.
 REMARKS: RR #5. BIT WT 22 M#, 80 RPM, 900 PSI PMP PR,
 55 SPM. BHA - BIT, BIT SUB, 21 - 6-1/2 DC'S, 2 HWDP,
 706'.

04-29-84

6389', TI FOR LOGS. MADE 52'. 5-3/4 HRS TRIPPING, 4
 HRS DRLG, 4 HRS CIRC FOR LOGS, 10-1/4 HRS LOGGING.
 DRLG W/GEL-CHEM. MW 9.3, VIS 39, WL 11.6, PH 11.5, FC
 2/32, CL 500 PPM, CA 100 PPM, SAND TR, PV 11, YP 6, GEL
 2/5, SOLIDS 5%, NITRATES 65. BIT #11, 8-3/4, STC, F3,
 (12-0-12). IN @ 6337', OUT @ 6389', MADE 52' IN 4 HRS,
 13'/HR. T 3 B 2 G 1. BIT WT 45 M#, 80 RPM, 1800 PSI
 PMP PR, 55 SPM. BHA - SAME, 706'.

04-30-84

6389', RD, MADE 0'. HOURLY BREAKDOWN: 1-1/2 HRS. TIH; 4-1/4
 HRS. CIRC FOR CSG; 5-1/2 HRS. LDDP AND DC'S; 4-1/4 HRS. RAN
 161 JTS 5-1/2", 17#, N-80, USED LT&C CSG. SA 6380'; 1/2 HR.
 CIRC CSG. NU HALLIBURTON PMPD 20 BBLS SAM 5 MUD FLUSH; 1 HR. CMT CSG
 W/600 SXS CLASS "H" W/3% KCL, .8 OF 1% HALAD, 4# NFP. PD @ 11:00
 P.M., HAD GOOD RETURNS THROUGHOUT. RECIPROCATED PIPE WHILE CMTG; 4
 HRS. ND, SET SLIPS, CUT OFF AND CLEANED MUD TANK; 3 HRS. RD. RIG
 RELEASED @ 3:00 A.M. 4-30-84. MW 9.3, VIS 43, WL 12, PH 11, FC 2/32,
 CL 500, CA 100, PV 13, YP 8, GEL 3/8, Snd 1/4%, SOL 5%. 1800 psi PMP
 PR, SPM 55. BHA - LD.
 CASING DETAIL:
 5-1/2" HALCO GUIDE SHOE .80'
 1 JT 5-1/2", 17#, N-80, LT&C USED CSG. 39.72'
 HALCO FLOAT COLLAR 1.75'
 160 JTS 5-1/2", 17#, N-80 LT&C USED CSG 6346.58'
 TOTALS 6388.85'
 ABOVE KB (8.85')
 CSG SA 6380.00' KB

DROP FROM REPORT UNTIL COMPLETION COMMENCES!

05-02-84

CLEANUP LOCATION. NU TBG SPOOL. TEST TO 1500# -
 O.K. SET ANCHORS.

05-03-84

MIRU WELTECH COMPLETION UNIT.
 DAILY COST \$3,617 CUM. COMPLETION COST \$11,648

05-04-84

6335' PBD, RU TO LOG. HOURLY BREAKDOWN: 2 HRS. RU AND WO TBG;
 1 HR. UNLOAD 206 JTS 2-7/8", J-55, 6.5#, EUE TBG, STRAP SAME; 5
 HRS. DRLG W/GEL-CHEM. MW 9.3, VIS 43, WL 12, PH 11, FC 2/32,
 CL 500, CA 100, PV 13, YP 8, GEL 3/8, Snd 1/4%, SOL 5%. 1800 psi PMP
 PR, SPM 55. BHA - LD.

Attached to Form 9-331
 Tenneco Blanding Unit #8-16
 SE SE Sec 8 T36N R22E
 San Juan County, Utah
 Lease U-23141

Report of Operations (continued)
 4/13/84 through 4/26/84

		<u>Nitrates</u>	<u>Chlorides</u>
4-25-84			
(cont.)	Top	-0-	1200 PPM
	Middle	-0-	5400 PPM
	Btm	-0-	8200 PPM
	Sampler	-0-	8400 PPM

Pressures: IHP 2878, IFP 53.5-107, ISIP 2264, FFP 133.7-240.7,
 FSIP 2290, FHP 2824.

4-26-84 6150'. Running wireline log. Made 30'. 10 hrs logging, 3-1/2 hrs
 TI (drlg rathole & cond hole), SLM (board 6120', strapped 6115', -5'
 correction), 1 hr wash & ream 20' to btm, 4 hrs drlg, 2 hrs circ, 2-1/4
 hrs TO, 1-1/4 hrs logging. Survey: 1-1/2 deg @ 6150'. MW 9, Vis 36,
 WL 10.4, PH 11.5, FC 2/32, CL 500 PPM, CA 60 PPM, Sand 1/4, PV 9, YP 4,
 Gel 1/6, Solids 4%, Nitrates 95. Bit #8, 8-3/4", STC, F3, (12-12-0).
 In @ 6120'. Out @ 6150'. Made 30' in 4 hrs, 7.5'/hr. T 2 B 2 G 1.
 Remarks: RR Bit #5. Bit Wt 40 M#, 70 RPM, 1900 psi PMP PR, 60 SPM.
 BHA - BIT SUB, 21 Jts HWDP, 704.74'. Logs run:

DIL/Sonic	6105' - 6565'
Sonic	6105' - 5900'
LDT/CNL	6100' - 6565'
CNL	6060' - 5900' (Bridge @ 6060')
CNL	6139' - 5900'

UNITED STATES
DEPARTMENT OF THE INTERIOR
GEOLOGICAL SURVEY

CONFIDENTIAL

SUNDRY NOTICES AND REPORTS ON WELLS

(Do not use this form for proposals to drill or to deepen or plug back or displace a reservoir. Use Form 9-331-C for such proposals.)

5. LEASE
U-23141

6. IF INDIAN, ALLOTTEE OR TRIBE NAME

7. UNIT AGREEMENT NAME
Blanding Unit

8. FARM OR LEASE NAME
Tenneco Blanding Unit

9. WELL NO.
#8-16

10. FIELD OR WILDCAT NAME
Wildcat/Ismay

11. SEC., T., R., M., OR BLK. AND SURVEY OR AREA
SE SE Sec 8 T36S R22E

12. COUNTY OR PARISH | 13. STATE
San Juan | Utah

14. API NO.
43-037-30964

15. ELEVATIONS (SHOW DF, KDB, AND WD)
6517' GL 6530' KB

1. oil well gas well other

2. NAME OF OPERATOR
Buckhorn Petroleum Company

3. ADDRESS OF OPERATOR
P.O. Box 5928 T A Denver, CO 80217

4. LOCATION OF WELL (REPORT LOCATION CLEARLY. See space 17 below.)
AT SURFACE: 810' FSL & 695' FEL (SE/4 SE/4)
AT TOP PROD. INTERVAL: Same
AT TOTAL DEPTH: Same

16. CHECK APPROPRIATE BOX TO INDICATE NATURE OF NOTICE, REPORT, OR OTHER DATA

REQUEST FOR APPROVAL TO:		SUBSEQUENT REPORT OF:	
TEST WATER SHUT-OFF	<input type="checkbox"/>		<input type="checkbox"/>
FRACTURE TREAT	<input type="checkbox"/>		<input type="checkbox"/>
SHOOT OR ACIDIZE	<input type="checkbox"/>		<input type="checkbox"/>
REPAIR WELL	<input type="checkbox"/>		<input type="checkbox"/>
PULL OR ALTER CASING	<input type="checkbox"/>		<input type="checkbox"/>
MULTIPLE COMPLETE	<input type="checkbox"/>		<input type="checkbox"/>
CHANGE ZONES	<input type="checkbox"/>		<input type="checkbox"/>
ABANDON*	<input type="checkbox"/>		<input type="checkbox"/>

(other) Report of Operations - 4/13/84 through 4/26/84

RECEIVED

(NOTE: Report results of multiple completion or zone change on Form 9-330.)

MAY 16 1984

**DIVISION OF OIL
GAS & MINING**

17. DESCRIBE PROPOSED OR COMPLETED OPERATIONS (Clearly state all pertinent details, and give pertinent dates, including estimated date of starting any proposed work. If well is directionally drilled, give subsurface locations and measured and true vertical depths for all markers and zones pertinent to this work.)*

4-13-84 1718'. Drlg, made 1148'. 24 hr. breakdown: 4 hrs. NU and test blind rams to 1500#. O.K.; 3/4 hrs. TIH; 1/4 hr. Test pipe rams to 1500#. O.K.; 2 hrs. Drl cmt shoe; 17 hrs. Drlg and srvys: 4 deg @ 553'; 4 deg @ 642'; 3-3/4 deg @ 734'; 3-1/4 deg @ 888'; 2-3/4 deg @ 1075'; 3-1/4 deg @ 1240'; 3-1/2 deg @ 1396' 4 deg @ 1616'. Bit #3, 8-3/4", HTC, J22 (10-10-0) in @ 570'. Made 1148' in 13-3/4 hrs. WOB 18-20M, RPM 65-70, 1500 psi PMP PR. SPM 98. BHA-BIT, BIT SUB, 18 6-1/4" DCs, 3 JTS WP. Length 643.

4-14-84 2578'. Drlg, made 860'. 24 hr. breakdown: 21-1/4 hrs. Drlg; 2-3/4 hrs. Srvys. Drl W/wtr 8.4 ppg. SRVYS: 3-1/4 deg @ 1755'; 3-3/4 deg @ 2081'; 2-1/4 deg @ 2207'; 3 deg @ 2332'; 2-1/4 deg @ 2480'. Bit #3, 8-3/4", HTC, J-22 (10-10-0) in @ 570'; made 2008', in 35 hrs. 57'/hr. SN 09026. WOB 20-22M, RPM 70, 1500 psi PMP PR, SPM 98. BHA-same.

Subsurface Safety Valve: Manu. and Type _____ Set @ _____ Ft.

18. I hereby certify that the foregoing is true and correct

SIGNED Alex Nash, Jr TITLE Manager-Operations DATE May 1, 1984

(This space for Federal or State office use)

APPROVED BY _____ TITLE _____ DATE _____
CONDITIONS OF APPROVAL IF ANY:

Attached to Form 9-331
 Tenneco Blanding Unit #8-16
 SE SE Sec 8 T36N R22E
 San Juan County, Utah
 Lease U-23141

Report of Operations (continued)

4/13/84 through 4/26/84

- 4-15-84 3357'. Drlg. Made 779'. 24 hr. breakdown: 21-1/2 hrs. Drlg; 2-1/4 hrs. Srvys; 1/4 hr. rig service. Drlg w/wtr 8.4 ppg. Srvys: 1-3/4 deg @ 2603'; 1-3/4 deg @ 2729'; M/R @ 2975'; 1-1/4 deg @ 3002'; 3/4 deg @ 3317'. Bit #3, 8-3/4", HTC, J-22 (10-0-10) in @ 570'. Made 2787'. 49.2'/HR. SN 09026. WOB 35M, RPM 65, 1500 psi PMP PR, SPM 98. BHA-Same.
- 4-16-84 4012'. Drlg. Made 655'. 24 hr. breakdown: 19-3/4 hrs. Drlg; 1/4 hr rig service; 3-3/4 hrs. trip for bit #4; 1/4 hr. srvy. Drlg w/wtr 8.4 ppg. Srvy: 3/4 deg @ 3624'. Bit #3, 8-3/4", HTC, J-22 (10-10-0) in @ 570', Out @ 3624', Made 3054' in 64-1/4 hrs. 47.5'/hr. Condition: T 8, B 6, G 1/4. SN 09026. Bit #4, 8-3/4", STC F-27 (10-10-0) in @ 3624', Made 388' in 12 hrs. 32.3'/hr. SN EF5203. WOB 40M, RPM 60, 1500 psi PMP PR, SPM 98, GPM 245. BHA - BIT, Junk basket, Bit sub, 18 DCs, 3 jts. WP. Length 649.73'.
- 4-17-84 4695'. Drlg. Made 683'. 24 hr. breakdown: 22-3/4 hrs. Drlg; 1 hr. survys; 1/4 hr. rig service and check BOP's. Srvys: 1-1/2 deg @ 4160'; 2-1/4 deg @ 4655'. Drlg w/wtr, MW 8.3 Bit #4, 8-3/4", STC, F27 (10-10-0) in @ 3624', Made 1071' in 34-3/4 hrs. 30.8'/hr. WOB 38-40M, RPM 70, 1700 psi PMP PR, SPM 98, GPM 245. BHA - same, 649.73'.
- 4-18-84 5170'. Drlg. Made 475'. 24 hr. breakdown: 22-3/4 hrs. Drlg; 1 hr. srvys; 1/4 hr. rig service and check BOP's. Srvys: 2 deg @ 4841' and 4997'. Drlg w/wtr. MW 8.3, Vis 28. Bit #4, 8-3/4", STC, F27 (10-10-0) in @ 3624', Made 1546' in 57-1/2 hrs. 26.8'/hr. WOB 38M, RPM 70, 1700 psi PMP PR, SPM 98, GPM 245. BHA - same, 649.73'. Top: Hermosa 5065'.
- 4-19-84 5450'. Drlg. Made 280'. 24 hr. breakdown: 17-1/4 hrs. Drlg; 1/4 hrs. rig service, check BOP's; 1-1/4 hrs. Circ for samples @ 5260'; 4-3/4 hrs. work on draw works motor; 1/2 hr. srvy. Srvy: 1-1/2 deg @ 5344'. Drlg w/wtr. MW 8.3, Vis 28. Bit #4, 8-3/4", STC, F27 (10-10-0) in @ 3624'. Made 1826' in 76-1/4 hrs. 23.9'/hr. WOB 40M, RPM 70, 1700 psi PMP PR, SPM 98, GPM 245. BHA - same, 649.73'.
- 4-20-84 5700', TFB. Made 250'. 16-1/4 hrs. drlg, 1/4 hr. service rig & check BOP, 7-1/4 hrs. tripping, 1/4 hr. srvy. Srvy: 1-1/4 deg @ 4700'. Drlg w/gel-chem. MW 8.6, Vis 32, WL NC, PH 10, FC 2/32, CL 500 PPM, CA 100 PPM, CA 100 PPM, Sand TR, PV 5, YP 2, Gel 1/2. Bit #4, 8-3/4", STC, F27, (10-10-0). In @ 3624'. Out @ 5700'. Made 2076' in 91-1/2 hrs. 22.6'/hr. T 8 B 8 G 1/2. SN EF5203. Bit #5, 8-3/4", STC, F3, (10-10-0). In @ 5700'. Bit Wt 40 M#, 70 RPM, 1700 psi PMP PR, 98 SPM, 245 GEM. BHA - Same. 649.73'.
- 4-21-84 5851'. Working on pmp. Made 151'. 12-1/2 hrs. drlg, 4-1/2 hrs PU 3 DC's & TI, 7 hrs working on main pmp. MW 8.6, Vis 33, WL 12.2, PH 10, FC 2/32, CL 500 PPM, CA 80 PPM, Sand 1/8, PV 7 YP 3, Gel 1/3, Solids 2%. Bit #5, 8-3/4", STC, F3, (10-10-0). In @ 5700'. Made 151' in 13 hrs., 11.6'/hr. Bit Wt 40 M#, 70 RPM, PMP #1: 1700 psi PMP PR, 98 SPM; PMP #2, 900 PSI PMP PR, 30 SPM. BHA - JB, X-0, 21 DC's, 3 HWDP, 710'.

Attached to Form 9-331
 Tenneco Blanding Unit #8-16
 SE SE Sec 8 T36N R22E
 San Juan County, Utah
 Lease U-23141

Report of Operations (continued)
 4/13/84 through 4/26/84

- 4-22-84 6017'. Drlg. Made 166'. 15-1/4 hrs. drlg., 8-3/4 hrs. wait on mud pump. MW 8.8, Vis 33, WL 916, PH 19, FC 2/32, CL 500 PPM, CA 80 PPM, Sand TR, PV 7, YP 2, Gel 0/1, Solids 3%. Bit #5, 8-3/4", STC, F3, (10-10-0). In @ 5700'. Made 317' in 30-3/4 hrs., 10.3'/hr. Remarks: RR. Bit wt. 45 M#, 70 RPM, 1800 psi PMP PR, 45 SPM. BHA - same. 740'.
- 4-23-84 6056'. Core #2. Made 39'. 10-1/4 hrs tripping, 3/4 hr dird to 6026'. 2 hrs circ for core #1, 2 hrs PU & service core barrel, 4-1/2 hrs core from 6026' - 6044'. 1-1/2 hrs dump core barrel & change bit, 1/2 hr wash to btm, 2-1/2 hrs core #2 from 6044' - 6056'. Survey: 1 deg @ 6026'. MW 8.9, Vis 37, WL 10.4, PH 11.5, FC 2/32, CL 500 PPM, CA 120 PPM, Sand Tr, PV 9, YP 5, Gel 2/6, Solids 3%. Bit #5, 8-3/4", STC, F3, (10-10-0). In @ 5700'. Out @ 6026'. Made 326' in 31-1/2 hrs, 10.3'/hr. T 2 B 2 G 1. SN: RR. Bit #6, 8-3/4", Acv, Star. In @ 6026'. Out @ 6044'. Made 18' in 4-1/2 hrs, 4'/hr. SN: 23230. Remarks: Ringed out. Bit #7, 8-3/4", Acv, Star. In @ 6044'. Made 12' in 2-1/2 hrs, 4.8'/hr. SN: 23310. Bit wt 15M#. 80 RPM, 900 psi PMP PR, 55 SPM, 280 GPM. BHA - core barrel, X-0, Jars, X-0, Bit sub, 21 DC's, 3 HWDP, 810.35'.
- 4-24-84 6120'. Unload core barrel. Made 64'. 4 hrs. circ., 7 hrs. tripping, 4 hrs. core #2 (6044' - 6075' - rec'd 31'), 6-1/2 hrs core #3 (6075' - 6120' - rec'd 45'), 2-1/4 hrs unload core barrel & run analysis. MW 8.9, Vis 35, WL 12.8, PH 11, FC 2/32, CL 500 PPM, CA 40 PPM, Sand 1/4, PV 8, YP 4, Gel 3/8, Solids 3%, Nitrates 150. Bit #7, 8-3/4", Acc Star. In @ 6044', Out @ 6120'. Made 76' in 11-1/2 hrs. Bit Wt 15 M#, 65 RPM, 900 psi PMP PR, 55 SPM, 280 GPM. BHA - same, 810.35'.
- 4-25-84 6120'. Logging. Made 0'. 2 hrs. Ld core #3 & core barrel, 1 hr. PU test tools, 2-3/4 hrs. TI w/test tools, 3-3/4 hrs. DST #1, 3 hrs. TO, 1-3/4 hrs. break out and land out tools, 1 hr. TI DC's, 1 hr. cut drlg. line, 2-1/4 hrs. TI & ream 80' to btm. 2 hrs. circ, 2 hrs. TO for logs, 1-1/2 hr. RU loggers & logging. Drlg w/gel-chem. MW 9, Vis 37, WL 12, PH 11.5, VC 2/32, CL 500 PPM, CA 60 PPM, Sand 1/4, PV 10, YP 5, Gel 2/10, Solids 4%. Bit #5 8-3/4", STC, F3, (11-12-0). In @ 6120'. Remarks: Circ. 1800 PSI PMP PR, 58 SPM. BHA - BIT, BIT SUB, 21 DC's, 3 Jts HWDP, 737.95'.

DST #1: 6080' - 6120' Lower Ismay Formation

- 15 min IF: Immediate blow to 2 oz. & incr to 35 oz. @ end of flow.
 30 min SI: Blow died in 4 min.
 60 min FF: Immediate blow to 4 oz. & incr to 6# in 60 min. Gts in 56 min.
 4' flare.
 120 min SI: Blow died in 6 min.

Rec'd 730' TF: 360' O & GCM, 180' O & GCW, 190' Wtr.
 Sampler: 2300 cc's total fluid. 1400 psi, 116 deg F.
 Brkdn: 100 cc's emulsified mud.
 300 cc's oil.
 1900 cc's wtr.

Attached to Form 9-331
 Tenneco Blanding Unit #8-16
 SE SE Sec 8 T36N R22E
 San Juan County, Utah
 Lease U-23141

Report of Operations (continued)
 4/13/84 through 4/26/84

		<u>Nitrates</u>	<u>Chlorides</u>
4-25-84			
(cont.)	Top	-0-	1200 PPM
	Middle	-0-	5400 PPM
	Btm	-0-	8200 PPM
	Sampler	-0-	8400 PPM

Pressures: IHP 2878, IFP 53.5-107, ISIP 2264, FFP 133.7-240.7,
 FSIP 2290, FHP 2824.

4-26-84 6150'. Running wireline log. Made 30'. 10 hrs logging, 3-1/2 hrs
 TI (drlg rathole & cond hole), SLM (board 6120', strapped 6115', -5'
 correction), 1 hr wash & ream 20' to btm, 4 hrs drlg, 2 hrs circ, 2-1/4
 hrs TO, 1-1/4 hrs logging. Survey: 1-1/2 deg @ 6150'. MW 9, Vis 36,
 WL 10.4, PH 11.5, FC 2/32, CL 500 PPM, CA 60 PPM, Sand 1/4, PV 9, YP 4,
 Gel 1/6, Solids 4%, Nitrates 95. Bit #8, 8-3/4", STC, F3, (12-12-0).
 In @ 6120'. Out @ 6150'. Made 30' in 4 hrs, 7.5'/hr. T 2 B 2 G 1.
 Remarks: RR Bit #5. Bit Wt 40 M#, 70 RPM, 1900 psi PMP PR, 60 SPM.
 BHA - BIT SUB, 21 Jts HWDP, 704.74'. Logs run:

DIL/Sonic	6105' - 6565'
Sonic	6105' - 5900'
LDT/CNL	6100' - 6565'
CNL	6060' - 5900' (Bridge @ 6060')
CNL	6139' - 5900'



STATE OF UTAH
NATURAL RESOURCES
Oil, Gas & Mining

Scott M. Matheson, Governor
Temple A. Reynolds, Executive Director
Dianne R. Nielson, Ph.D., Division Director

4241 State Office Building • Salt Lake City, UT 84114 • 801-533-5771

July 6, 1984

Harper Oil
P.O. Box 5928 TA
Denver, Colorado 80217

Gentlemen

SUBJECT: WELL NO. TENNECO BLANDING UNIT #8-16

This letter is to advise you that this office has not yet received a "Sundry Notice" indicating the operator name change from Buckhorn Petroleum Company to Harper Oil on Well No. Tenneco Blanding Unit #8-16, API #43-037-30964, Sec. 8, T. 36S., R. 22E., San Juan County, Utah

Our records also indicate that you have not filed the monthly drilling report on this well for the month of May 1984. We have enclosed the proper forms for your convenience in bringing this well into compliance.

Thank you for your prompt attention to these matters.

Sincerely

A handwritten signature in cursive script that reads "Claudia L. Jones".

Claudia L. Jones
Well Records Specialist

clj
Enclosure

cc Dianne R. Nielson
Ronald J. Firth
John R. Baza
file

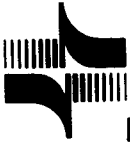

Harper Oil Company
Rocky Mountain Division

Dome Tower, Suite 1200
1625 Broadway
P.O. Box 5928, T.A.
Denver, Colorado 80217
(303) 825-4771

July 18, 1984

RECEIVED

JUL 20 1984

DIVISION OF OIL
GAS & MINING

State of Utah
Department of Natural Resources
Oil, Gas & Mining
4241 State Office Building
Salt Lake City, UT 84114

Attn: Ms. Claudia L. Jones, Well Records Specialist

Re: #8-16 Tenneco Blanding Unit, SE SE Sec 8 T36S R22E, San Juan County

Dear Ms. Jones:

In response to your letter dated July 6, enclosed is a Sundry Notice which provides for the Change of Operator from Buckhorn Petroleum Company to Harper Oil Company.

You indicated that you had not received the monthly drilling report for May, 1984. Drilling activity ended on April 30, and therefore, there was no drilling report for the month of May. Copies of the Completion Report and a Sundry Notice reporting that the well had been temporarily abandoned for re-evaluation for possible redrill/salt water injection, were forwarded to you on June 1, 1984.

If you have any questions or require further documentation, please do not hesitate to contact me.

Very truly yours,

HARPER OIL COMPANY

Sally L. DuVall
Sally L. DuVall

We have not received the well completion or Sundry as of 8/7/84. Ms. DuVall will send a copy as per phone conversation 2:20. 8/7/84.

Enc.
/sd



MIDCON CORR.

STATE OF UTAH
DEPARTMENT OF NATURAL RESOURCES
DIVISION OF OIL, GAS, AND MINING

5. LEASE DESIGNATION AND SERIAL NO.

U-23141

6. IF INDIAN, ALLOTTEE OR TRIBE NAME

SUNDRY NOTICES AND REPORTS ON WELLS

(Do not use this form for proposals to drill or to deepen or plug back to a different reservoir. Use "APPLICATION FOR PERMIT—" for such proposals.)

7. UNIT AGREEMENT NAME

Blanding Unit

8. FARM OR LEASE NAME

Tenneco Blanding Unit

9. WELL NO.

8-16

10. FIELD AND POOL, OR WILDCAT

Wildcat/Ismay

11. SEC., T., S., M., OR BLE. AND SURVEY OR AREA

SE SE Sec 8 T36S R22E

1. OIL WELL GAS WELL OTHER

2. NAME OF OPERATOR HARPER OIL COMPANY, Successor by Merger to Buckhorn Petroleum Company

3. ADDRESS OF OPERATOR P. O. Box 5928 T.A., Denver, CO 80217

4. LOCATION OF WELL (Report location clearly and in accordance with any State requirements. See also space 17 below.)
At surface 810' FSL & 695' FEL (SE SE)

RECEIVED

JUL 20 1984

14. PERMIT NO. API# 43-037-30964

15. ELEVATIONS (Show whether OF, ST, OR, etc.) 6530' KB

DIVISION OF OIL

12. COUNTY OR PARISH San Juan

13. STATE Utah

GAS & MINING

16. Check Appropriate Box To Indicate Nature of Notice, Report, or Other Data

NOTICE OF INTENTION TO:

TEST WATER SHUT-OFF
FRACTURE TREAT
SHOOT OR ACIDIZE
REPAIR WELL
(Other)

PULL OR ALTER CASING
MULTIPLE COMPLETE
ABANDON*
CHANGE PLANS

SUBSEQUENT REPORT OF:

WATER SHUT-OFF
FRACTURE TREATMENT
SHOOTING OR ACIDIZING
(Other)

REPAIRING WELL
ALTERING CASING
ABANDONMENT*

CHANGE OF OPERATOR

(NOTE: Report results of multiple completion on Well Completion or Recompletion Report and Log form.)

17. DESCRIBE PROPOSED OR COMPLETED OPERATIONS (Clearly state all pertinent details, and give pertinent dates, including estimated date of starting any proposed work. If well is directionally drilled, give subsurface locations and measured and true vertical depths for all markers and zones pertinent to this work.) *

Effective May 1, 1984, Buckhorn Petroleum Company and Harper Oil Company, wholly-owned subsidiaries of Midcon Corporation, merged to become Harper Oil Company.

18. I hereby certify that the foregoing is true and correct

SIGNED A. Nash Jr.

TITLE Operations Manager

DATE July 18, 1984

(This space for Federal or State office use)

APPROVED BY _____
CONDITIONS OF APPROVAL, IF ANY:

TITLE _____

DATE _____

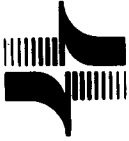

Harper Oil Company

Rocky Mountain Division
Dome Tower, Suite 1200
1625 Broadway
P.O. Box 5928, T.A.
Denver, Colorado 80217
(303) 825-4771

Comp.

RECEIVED

AUG 9 1984

**DIVISION OF OIL
GAS & MINING**

August 7, 1984

State of Utah
Department of Natural Resources
Oil, Gas & Mining
4241 State Office Building
Salt Lake City, UT 84114

Attn: Ms. Claudia L. Jones, Well Records Specialist

Re: #8-16 Blanding Unit, SE SE Sec 8 T36S R22E, San Juan County
Completion Report and Sundry Notice

Dear Claudia:

In response to your telephone call today regarding the Completion Report and Sundry Notice missing from your files, enclosed are three copies of same.

If I can help you further, please do not hesitate to contact me.

Very truly yours,

HARPER OIL COMPANY

Sally L. DuVall
Sally L. DuVall

Enc.
/sd



UNITED STATES DEPARTMENT OF THE INTERIOR GEOLOGICAL SURVEY

SUBMIT IN DUPLICATE (See other side for instructions)

Form approved. Budget Bureau No. 42-R355.5.

WELL COMPLETION OR RECOMPLETION REPORT AND LOG

5. LEASE DESIGNATION AND SERIAL NO. U-23141

6. IF INDIAN, ALLOTTEE OR TRIBE NAME

7. UNIT AGREEMENT NAME Blanding Unit

8. FARM OR LEASE NAME Tenneco Blanding Unit

9. WELL NO. #8-16

10. FIELD AND POOL, OR WILDCAT Wildcat/Ismay

11. SEC., T. R., M., OR BLOCK AND SURVEY OR AREA Sec 8 T36S R22E

12. COUNTY OR PARISH San Juan

13. STATE Utah

1a. TYPE OF WELL: OIL WELL [X] GAS WELL [] DRY [] Other []

b. TYPE OF COMPLETION: NEW WELL [X] WORK OVER [] DEEP-EN [] PLUG BACK [] DIFF. RESV. [] Other []

2. NAME OF OPERATOR HARPER OIL COMPANY, Successor by Merger to Buckhorn Petroleum Company

3. ADDRESS OF OPERATOR P.O. Box 5928 T.A., Denver, CO 80217

4. LOCATION OF WELL (Report location clearly and in accordance with any State requirements) At surface 810' PSL & 695' FEL (SE SE)

At top prod. interval reported below Same

At total depth Same

RECEIVED DIVISION OF OIL GAS & MINING

14. PERMIT NO. API 43-037-30964 3-30-84

15. DATE SPUDDED 4-10-84 16. DATE T.D. REACHED 4-30-84 17. DATE COMPL. (Ready to prod.) T & A'd 5-19-84 18. ELEVATIONS (DF, REB, RT, GR, ETC.) 6530' KB

20. TOTAL DEPTH, MD & TVD 6389' 21. PLUG BACK T.D., MD & TVD 6335' 22. IF MULTIPLE COMPL., HOW MANY? N/A 23. INTERVALS DRILLED BY 0' - 6389'

24. PRODUCING INTERVAL(S), OF THIS COMPLETION—TOP, BOTTOM, NAME (MD AND TVD) 6072' - 6081' - Ismay

26. TYPE ELECTRIC AND OTHER LOGS RUN DIL/Sonic/Sonic/OLDT/CNL, CNL(6060-5900), CNL(6139-5900) CBL w/GR & VDL, Neutron w/GR

Table with 5 columns: CASING SIZE, WEIGHT, LB./FT., DEPTH SET (MD), HOLE SIZE, CEMENTING RECORD, AMOUNT PULLED. Rows include 16" Conductor, 9-5/8" 36#K-55ST&C, 5-1/2" 17#N-80LT&C.

Table with 2 main sections: LINER RECORD and TUBING RECORD. LINER RECORD columns: SIZE, TOP (MD), BOTTOM (MD), SACKS CEMENT, SCREEN (MD). TUBING RECORD columns: SIZE, DEPTH SET (MD), PACKER SET (MD).

Table with 2 main sections: PERFORATION RECORD and ACID, SHOT, FRACTURE, CEMENT SQUEEZE, ETC. PERFORATION RECORD columns: INTERVAL, SIZE AND NUMBER. ACID, SHOT, FRACTURE, CEMENT SQUEEZE, ETC. columns: DEPTH INTERVAL (MD), AMOUNT AND KIND OF MATERIAL USED.

Table with 2 main sections: PRODUCTION and TEST DATA. PRODUCTION columns: DATE FIRST PRODUCTION, PRODUCTION METHOD, WELL STATUS. TEST DATA columns: DATE OF TEST, HOURS TESTED, CHOKER SIZE, PROD'N. FOR TEST PERIOD, OIL-BBL., GAS-MCF., WATER-BBL., GAS-OIL RATIO.

34. DISPOSITION OF GAS (Sold, used for fuel, vented, etc.) Vented

35. LIST OF ATTACHMENTS

36. I hereby certify that the foregoing and attached information is complete and correct as determined from all available records. SIGNED [Signature] TITLE Operations Manager DATE June 1, 1984

*(See Instructions and Spaces for Additional Data on Reverse Side)

Copy to State of Utah 6-1-84

INSTRUCTIONS

General: This form is designed for submitting a complete and correct well completion report and log on all types of lands and leases to either a Federal agency or a State agency, or both, pursuant to applicable Federal and/or State laws and regulations. Any necessary special instructions concerning the use of this form and the number of copies to be submitted, particularly with regard to local, area, or regional procedures and practices, either are shown below or will be issued by, or may be obtained from, the local Federal and/or State office. See instructions on items 22 and 24, and 33, below regarding separate reports for separate completions.

If not filed prior to the time this summary record is submitted, copies of all currently available logs (drillers, geologists, sample and core analysis, all types electric, etc.), formation and pressure tests, and directional surveys, should be attached hereto, to the extent required by applicable Federal and/or State laws and regulations. All attachments should be listed on this form, see item 35.

Item 4: If there are no applicable State requirements, locations on Federal or Indian land should be described in accordance with Federal requirements. Consult local State or Federal office for specific instructions.

Item 18: Indicate which elevation is used as reference (where not otherwise shown) for depth measurements given in other spaces on this form and in any attachments. Items 21 and 24: If this well is completed for separate production from more than one interval zone (multiple completion), so state in item 22, and in item 24 show the producing interval, or intervals, top(s), bottom(s) and name(s) (if any) for only the interval reported in item 33. Submit a separate report (page) on this form, adequately identified, for each additional interval to be separately produced, showing the additional data pertinent to such interval.

Item 29: "Sacks Cement": Attached supplemental records for this well should show the details of any multiple stage cementing and the location of the cementing tool.

Item 33: Submit a separate completion report on this form for each interval to be separately produced. (See instruction for items 22 and 24 above.)

FORMATION	TOP	BOTTOM	DESCRIPTION, CONTENTS, ETC.	NAME	GEOLOGIC MARKERS																														
			<p>31. (continued) Squeezed w/200 sx Cl "H" w/1% CaCl₂, .6 of 1% HALAD-9, Mix 31 bbl slurry and disp. w/13 bbls 2% KCl. Squeezed @ 3500#. Reversed 21.5 bbl slurry.</p> <p>DST #1 4-25-84 6080-6120 Lower Ismay 15" - 30" - 60" - 120" Rec. 730' TF 360' O&GCM, 180' O&GCW, 190' WTR.</p> <p>IHP 2878 FSIP 2290 IFP 53.5-107 FHP 2824 ISIP 2264 FFP - 133.7-240.7</p>	Entrada Carmel Navajo Kauenta Wingate Chinle Shinarump Moenkopi Cutler Cedar Mesa Holgaito Honaker Trail Ismay Desert Creek	<p>38. GEOLOGIC MARKERS</p> <table border="1" style="width: 100%; border-collapse: collapse;"> <thead> <tr> <th>MEAS. DEPTH</th> <th>TRUE VERT. DEPTH</th> </tr> </thead> <tbody> <tr><td>1050'</td><td></td></tr> <tr><td>1190'</td><td></td></tr> <tr><td>1270'</td><td></td></tr> <tr><td>1848'</td><td></td></tr> <tr><td>2047'</td><td></td></tr> <tr><td>2307'</td><td></td></tr> <tr><td>2898'</td><td></td></tr> <tr><td>3033'</td><td></td></tr> <tr><td>3235'</td><td></td></tr> <tr><td>3730'</td><td></td></tr> <tr><td>4357'</td><td></td></tr> <tr><td>5055'</td><td></td></tr> <tr><td>6009'</td><td></td></tr> <tr><td>6255'</td><td></td></tr> </tbody> </table>	MEAS. DEPTH	TRUE VERT. DEPTH	1050'		1190'		1270'		1848'		2047'		2307'		2898'		3033'		3235'		3730'		4357'		5055'		6009'		6255'	
MEAS. DEPTH	TRUE VERT. DEPTH																																		
1050'																																			
1190'																																			
1270'																																			
1848'																																			
2047'																																			
2307'																																			
2898'																																			
3033'																																			
3235'																																			
3730'																																			
4357'																																			
5055'																																			
6009'																																			
6255'																																			

8-16 Blanding Unit
SESE Sec 8, T36S, R22E

Core 1
6026 - 6043 Driller * (used here)
6018 - 6035 Logger

*6026 - 6037 Limestone Dk-gy-br, arg, vf, xln, scattered blocky sparite, no vis porosity, no show

6038 - 6042 Anhydrite, white-gray, course xln

6043 Limestone, dk-gy-brn, arg, vf xln, scattered blocky sparite, no porosity, no show

Core 2
6044 - 6075 Driller
6036 - 6067 Logger

6044 - 6056 Limestone, dk-gy-brn, vf xln, arg, scattered thin lam of anh & mudstone, occ clear blocky sparite, no porosity, no show

6056 - 6066 Limestone, AA, scattered opened and closed vert fractures, and stylolites.

6067 - 6075 Limestone, dk-gy-brn, vf xln, arg, occ blocky sparite, no porosity, no show

Core 3
6075 - 6120 Driller
6067 - 6112 Logger

6075 - 6080 Limestone, lt-gy-brn, vf xln, sucrosic texture, arg, scattered blocky sparite. Some open and closed vert fractures. Blue-gr fluor on fracture surface at 6079. No vis porosity.

6081 - 6083 Limestone, med-gy-brn, leached oolitic texture, abundant lt brn oil stain, bright blu-grn fluor, strong order of hydrocarbons, good oomldic porosity and poor interxln porosity.

6084 - 6085 Limestone, lt-gy-brn, vf xln, sucrosic texture with 1" vertical zone of breccia. Abundant infill of breccia by blocky sparite, fair intra sparite porosity with oil show and blu-grn fluor.

6086 - 6093

Limestone, lt-gy-brn, vf xln, sucrosic texture, abundant leached alga porosity with brn oil stain and bright blu-grn fluor. Fluor becomes rare in 6093 sample. Good leached alga porosity.

6094 - 6120

Limestone AA. Partial infill of alga porosity by clear sparite. Oil stain and fluor become rare to not present. Fair alga porosity.

Core 4

6307 - 6337 Driller
6305 - 6329 Logger

6307 - 6311

Anhydrite

6311 - 6326½

Limestone dk-gy-brn, dolomitec, arg, vf xln, abundant brack frag. 6315 - 6317½ bleeding oil on shale lam. No vis porosity.

6326½ - 6331

Shale, blk, marly smooth, fissile (akah)

6331 - 6333

No recovery.

REC'D MDO JUN 04 1984

UNITED STATES
DEPARTMENT OF THE INTERIOR
GEOLOGICAL SURVEY

SUNDRY NOTICES AND REPORTS ON WELLS
(Do not use this form for proposals to drill or to deepen or plug back to a different reservoir. Use Form 5-331-C for such proposals.)

1. oil well gas well other
2. NAME OF OPERATOR HARPER OIL COMPANY, Successor by Merger to Buckhorn Petroleum Company
3. ADDRESS OF OPERATOR P.O. Box 5928 T.A., Denver, CO 80217
4. LOCATION OF WELL (REPORT LOCATION CLEARLY. See space 17 below.)
AT SURFACE: 810' FSL & 695' FEL (SE SE)
AT TOP PROD. INTERVAL: Same
AT TOTAL DEPTH: Same

16. CHECK APPROPRIATE BOX TO INDICATE NATURE OF NOTICE, REPORT, OR OTHER DATA

REQUEST FOR APPROVAL TO:
TEST WATER SHUT-OFF
FRACTURE TREAT
SHOOT OR ACIDIZE
REPAIR WELL
PULL OR ALTER CASING
MULTIPLE COMPLETE
CHANGE ZONES
ABANDON*
(other) Temporary Abandonment

SUBSEQUENT REPORT OF:

5. LEASE U-23141
6. IF INDIAN, ALLOTTEE OR TRIBE NAME
7. UNIT AGREEMENT NAME Blanding Unit
8. FARM OR LEASE NAME Tenneco Blanding Unit
9. WELL NO. #8-16
10. FIELD OR WILDCAT NAME Wildcat/Ismay
11. SEC., T., R., M., OR BLK. AND SURVEY OR AREA SE SE Sec 8 T36S R22E
12. COUNTY OR PARISH San Juan 13. STATE Utah
14. API NO.
15. ELEVATIONS (SHOW DF, KDB, AND WD)

RECEIVED

AUG 9 1984

(NOTE: Report results of multiple completion or zone change on Form 5-330.)

DIVISION OF OIL
GAS & MINING

17. DESCRIBE PROPOSED OR COMPLETED OPERATIONS (Clearly state all pertinent details, and give pertinent dates, including estimated date of starting any proposed work. If well is directionally drilled, give subsurface locations and measured and true vertical depths for all markers and zones pertinent to this work.)*

This well has been temporarily abandoned and is being re-evaluated for possible redrill/salt water injection.

Well was plugged back at 6311' and packer set at 5877'.

Subsurface Safety Valve: Manu. and Type _____ Set @ _____ Ft.

18. I hereby certify that the foregoing is true and correct

SIGNED A. Nash, Jr. TITLE Operations Manager DATE May 31, 1984
A. Nash, Jr.

(This space for Federal or State office use)

APPROVED BY C. Delano Jackson TITLE Acting Dist. Manager DATE 6/12/84
CONDITIONS OF APPROVAL IF ANY:

OPERATOR



STATE OF UTAH
NATURAL RESOURCES
Oil, Gas & Mining

Norman H. Bangerter, Governor
Dee C. Hansen, Executive Director
Dianne R. Nielson, Ph.D., Division Director

355 W. North Temple • 3 Triad Center • Suite 350 • Salt Lake City, UT 84180-1203 • 801-538-5340

March 12, 1985

Harper Oil Company
P O Box 5928 TA
Denver, Colorado 80217

Gentlemen:

Re: Well No. Tenneco Blanding Unit 8-16 - Sec. 8, T. 36S.,, R. 22E
San Juan County, Utah - API #43-037-30964

According to our records a "Well Completion Report" filed with this office June 1, 1984 on the above referred to well indicates the following electric logs were run: CBL w/GR & VDL. This office has not yet received these logs.

Please take care of this matter as soon as possible, but not later than April 12, 1985.

Your cooperation in this matter is appreciated.

Sincerely,

A handwritten signature in cursive script that reads "Pam M. Kenna".

Pam M. Kenna
Well Records Specialist

cc: Dianne R. Nielson
Ronald J. Firth
John R. Baza
File
0123S/5



STATE OF UTAH
NATURAL RESOURCES
Oil, Gas & Mining

Norman H. Bangerter, Governor
Dee C. Hansen, Executive Director
Dianne R. Nielson, Ph.D., Division Director

355 W. North Temple • 3 Triad Center • Suite 350 • Salt Lake City, UT 84180-1203 • 801-538-5340

October 4, 1985

Harper Oil Company
P.O. Box 5928 TA
Denver, Colorado 80217

Gentlemen:

Re: Well No. Tenneco Blanding Unit 8-16 - Sec. 8, T. 36S., R. 22E.,
San Juan County, Utah - API #43-037-30964

According to our records a "Well Completion Report" filed with this office June 1, 1984 on the above referenced well indicates the following electric logs were run: Cement Bond Log. This office has not yet received these logs.

Please take care of this matter as soon as possible, but not later than October 18, 1985.

Your cooperation in this matter is appreciated.

Sincerely,

A handwritten signature in cursive script that reads "Pam Kenna".

Pam Kenna
Well Records Specialist

Enclosure
cc: Dianne R. Nielson
Ronald J. Firth
John R. Baza
File

0170S/24

UNITED STATES DEPARTMENT OF THE INTERIOR GEOLOGICAL SURVEY

SUBMIT IN TRIPlicate (Other instructions on reverse side)

Form approved. Budget Bureau No. 42-R1424.

5. LEASE DESIGNATION AND SERIAL NO.

U-23141

6. IF INDIAN, ALLOTTEE OR TRIBE NAME

7. UNIT AGREEMENT NAME

Blanding Unit

8. FARM OR LEASE NAME

Tenneco Blanding Unit

9. WELL NO.

8-16

10. FIELD AND POOL, OR WILDCAT

Ismay / Wildcat

11. SEC., T., R., M., OR BLK. AND SURVEY OR AREA

Sec 8-36S-22E

12. COUNTY OR PARISH

San Juan

13. STATE

Utah

SUNDRY NOTICES AND REPORTS ON WELLS

(Do not use this form for proposals to drill or to deepen or plug back to a different reservoir. Use "APPLICATION FOR PERMIT-" for such proposals.)

1. OIL WELL [] GAS WELL [] OTHER TA

2. NAME OF OPERATOR Harper Oil Company

3. ADDRESS OF OPERATOR P.O. Box 5928 T.A., Denver, CO 80217

4. LOCATION OF WELL (Report location clearly and in accordance with any State requirements. See also space 17 below.) At surface

SE/4 SE/4 (810' FSL & 695' FEL)

14. PERMIT NO. API #43-037-30964

15. ELEVATIONS (Show whether DF, RT, OR, etc.) 6517' G.L.

16. Check Appropriate Box To Indicate Nature of Notice, Report, or Other Data

NOTICE OF INTENTION TO:

TEST WATER SHUT-OFF [] FRACTURE TREAT [] SHOOT OR ACIDIZE [] REPAIR WELL [] (Other)

PULL OR ALTER CASING [] MULTIPLE COMPLETE [] ABANDON* [XXX] CHANGE PLANS []

SUBSEQUENT REPORT OF:

WATER SHUT-OFF [] FRACTURE TREATMENT [] SHOOTING OR ACIDIZING [] (Other)

REPAIRING WELL [] ALTERING CASING [] ABANDONMENT* []

(NOTE: Report results of multiple completion on Well Completion or Recompletion Report and Log form.)

17. DESCRIBE PROPOSED OR COMPLETED OPERATIONS (Clearly state all pertinent details, and give pertinent dates, including estimated date of starting any proposed work. If well is directionally drilled, give subsurface locations and measured and true vertical depths for all markers and zones pertinent to this work.)

This well is currently T&A'd in the same status as shown on the Well Completion Report dated 6/1/84. Harper Oil Company plans to P&A the well and restore the surface.

The proposed procedure for abandonment is attached for your approval. We would like to begin the work first half of July, 1985.

RECEIVED

JUL 30 1985

DIVISION OF OIL GAS & MINING

ACCEPTED BY THE STATE DEPT. OF OIL, GAS, AND MINING

DATE: 8-2-93 BY: J.M. Matthews

18. I hereby certify that the foregoing is true and correct

SIGNED: John Dolezal TITLE: Drilling Specialist DATE: June 11, 1985

(This space for Federal or State office use)

APPROVED BY: James J. Travis TITLE: ACTING DIST. MAN. DATE: 6/17/85

CONDITIONS OF APPROVAL, IF ANY:

Approved: G.N.

HARPER OIL COMPANY
PLUGGING PROCEDURE

No. 8-16 Blanding Unit
Sec 16-T36S-R22E
San Juan County, Utah

- 1.) Move in and rig up completion unit.
- 2.) Pick up 2-7/8" tubing and trip in hole.
- 3.) Set 100' cement plug across perms (6071'-6074') from 6020'-6120'.
- 4.) Trip out with tubing.
- 5.) Rig up wireline truck, run free point, cut off casing (+/-3500').
- 6.) Pull 2-3 joints of casing.
- 7.) Trip in hole with tubing and set 100' plug, 50' in and 50' out of casing stub, trip out with tubing.
- 8.) Pull remainder of casing.
- 9.) Trip in hole with tubing and set 100' plug across base of surface casing at 565', plug at 515'-615'.
- 10.) Put 50' plug at the surface.
- 11.) Cut off 9-5/8" surface casing 3' below ground level and install dry hole marker.
- 12.) Rig down and move out completion unit, load out all equipment, restore surface location to surface owner's specifications.

pd
6-11-55
[Signature]

UNITED STATES
DEPARTMENT OF THE INTERIOR
GEOLOGICAL SURVEY

SUBMIT IN THIS MANNER
(Other instructions on re-
verse side)

Form approved.
Budget Bureau No. 42-21424.

5. LEASE DESIGNATION AND SERIAL NO.
U-23141

6. IF INDIAN, ALLOTTEE OR TRIBE NAME

SUNDRY NOTICES AND REPORTS ON WELLS

(Do not use this form for proposals to drill or to deepen or plug back to a different reservoir.
Use "APPLICATION FOR PERMIT—" for such proposals.)

7. UNIT AGREEMENT NAME
Blanding Unit

8. FARM OR LEASE NAME
Blanding Unit

9. WELL NO.
8-16

10. FIELD AND POOL, OR WILDCAT
Wildcat/Ismay

11. SEC., T., R., M., OR BLK. AND SURVEY OR AREA
8, T36S, R22E

12. COUNTY OR PARISH
San Juan

13. STATE
Utah

1. OIL WELL GAS WELL OTHER

2. NAME OF OPERATOR
MIDCON CENTRAL EXPLORATION

3. ADDRESS OF OPERATOR
c/o Apache Corp., 1700 Lincoln, Ste 4900, Denver

4. LOCATION OF WELL (Report location clearly and in accordance with any State requirements.* 80203-
See also space 17 below.) 4549
At surface

SE/4 SE/4 810' FSL & 695' FEL

14. PERMIT NO.
API 43-037-30964

15. ELEVATIONS (Show whether DF, RT, GR, etc.)
6512' GR

16. Check Appropriate Box To Indicate Nature of Notice, Report, or Other Data

NOTICE OF INTENTION TO:

SUBSEQUENT REPORT OF:

TEST WATER SHUT-OFF <input type="checkbox"/>	PULL OR ALTER CASING <input type="checkbox"/>
FRACTURE TREAT <input type="checkbox"/>	MULTIPLE COMPLETE <input type="checkbox"/>
SHOOT OR ACIDIZE <input type="checkbox"/>	ABANDON* <input type="checkbox"/>
REPAIR WELL <input type="checkbox"/>	CHANGE PLANS <input type="checkbox"/>
(Other) <input type="checkbox"/>	

WATER SHUT-OFF <input type="checkbox"/>	REPAIRING WELL <input type="checkbox"/>
FRACTURE TREATMENT <input type="checkbox"/>	ALTERING CASING <input type="checkbox"/>
SHOOTING OR ACIDIZING <input type="checkbox"/>	ABANDONMENT* <input checked="" type="checkbox"/>
(Other) <input type="checkbox"/>	

(NOTE: Report results of multiple completion on Well Completion or Recompletion Report and Log form.)

17. DESCRIBE PROPOSED OR COMPLETED OPERATIONS (Clearly state all pertinent details, and give pertinent dates, including estimated date of starting any proposed work. If well is directionally drilled, give subsurface locations and measured and true vertical depths for all markers and zones pertinent to this work.)*

Plugged well as follows:

- 1) Spotted 25 sk cmt plug from 6020-6120' across perfs from 6071-6074'.
- 2) Shot off 5-1/2" csg at 1050'. TOOH w/1050' 5-1/2" 17#, N-80 csg.
- 3) TIH w/tbg to 1050' and spotted a 30 sk cmt plug (50' in and 50' out) across top of csg stub.
- 4) Pulled tbg to 615'. Spotted 30 sk cmt plug from 615-515' (50' above and 50' below surface casing shoe. Finished POOH with tubing.
- 5) Cut off wellhead. Dumped 5 sks cmt in csg at surf. Installed dry hole marker. Well P&A'd 8-7-85.

RECEIVED

JUL 30 1993

DIVISION OF

OIL, GAS & MINING

DATE 9/17/86

18. I hereby certify that the foregoing is true and correct

SIGNED John H. Benton
John H. Benton

TITLE Operations Engineer

(This space for Federal or State office use)

APPROVED BY L. J. Padine
CONDITIONS OF APPROVAL, IF ANY:

TITLE District Mgr.

DATE 12/21/88

CC: CITE
1522

Approved DHM
12/20/88

ALS 12/21/88

WCA 12/21/88

*See Instructions on Reverse Side

UNITED STATES GOVERNMENT
memorandum

DATE: SEP 26 1988

REPLY TO
 ATTN OF: Area Manager, San Juan

U-23141
 (U-069)

SUBJECT: Final Abandonment Notice

TO: District Manager, Moab (U-065)

No problems have been identified by the landowner for Midcon Central Exploration Blanding 8-16 well (U-23141) in T. 36 S., R. 22 E., Section 8. We recommend approval of the Subsequent Report of Abandonment and release from further reclamation responsibilities.

Edward R. Smith

RECEIVED
 MOAB DISTRICT OFFICE
 1988 SEP 27 AM 8:35
 DEPARTMENT OF THE INTERIOR
 BUREAU OF LAND MANAGEMENT

Moab DO

X	Init/Date
DM	ES 9/27
ADM	
PAO	
Plng	
Res	
Oper	
Admin	
Min	
PRRA	
SRRA	
GRA	
SJRA	
Act	_____
Info	_____
Discuss	

*pull SRP
 lease may be
 term.*